

## 2007 Hummer H3

2007 ACCESSORIES & EQUIPMENT Vehicle Access - H3

### 2007 ACCESSORIES & EQUIPMENT

#### Vehicle Access - H3

## SPECIFICATIONS

### FASTENER TIGHTENING SPECIFICATIONS

#### Fastener Tightening Specifications

| Application                                | Specification |          |
|--|---------------|----------|
|  | Metric        | English  |
| Front Side Door Check Link Bolt            | 25 N.m        | 18 lb ft |
| Front Side Door Check Link Nut             | 25 N.m        | 18 lb ft |
| Front Side Door Lock Accessory Plate Screw | 2 N.m         | 18 lb in |
| Front Side Door Lock Actuator Bolt         | 7 N.m         | 62 lb in |
| Front Side Door Lock Bolt                  | 7 N.m         | 62 lb in |
| Front Side Door Lock Cylinder Bolt         | 7 N.m         | 62 lb in |
| Front Side Door Lock Striker Bolt          | 25 N.m        | 18 lb ft |
| Front Side Door Outside Handle Bolt        | 9 N.m         | 80 lb in |
| Front Side Door Window Regulator Bolt      | 10 N.m        | 89 lb in |
| Front Side Door Window Weatherstrip Bolt   | 10 N.m        | 89 lb in |
| Inside Door Handle Screw                   | 2 N.m         | 18 lb in |
| Latch Endgate Screws                       | 10 N.m        | 89 lb in |
| Rear Side Door Check Link Bolt             | 25 N.m        | 18 lb ft |
| Rear Side Door Check Link Nut              | 25 N.m        | 18 lb ft |
| Rear Side Door Hinge Bolt                  | 27 N.m        | 20 lb ft |
| Rear Side Door Lock Actuator Bolt          | 7 N.m         | 62 lb in |
| Rear Side Door Lock Bolt                   | 7 N.m         | 62 lb in |
| Rear Side Door Lock Cylinder Bolt          | 7 N.m         | 62 lb in |
| Rear Side Door Lock Striker Bolt           | 25 N.m        | 18 lb ft |
| Rear Side Door Outside Handle Bolt         | 9 N.m         | 80 lb in |

## SCHMATIC AND ROUTING DIAGRAMS

### DOOR LOCK/INDICATOR SCHEMATICS

# 2007 Hummer H3

## 2007 ACCESSORIES & EQUIPMENT Vehicle Access - H3

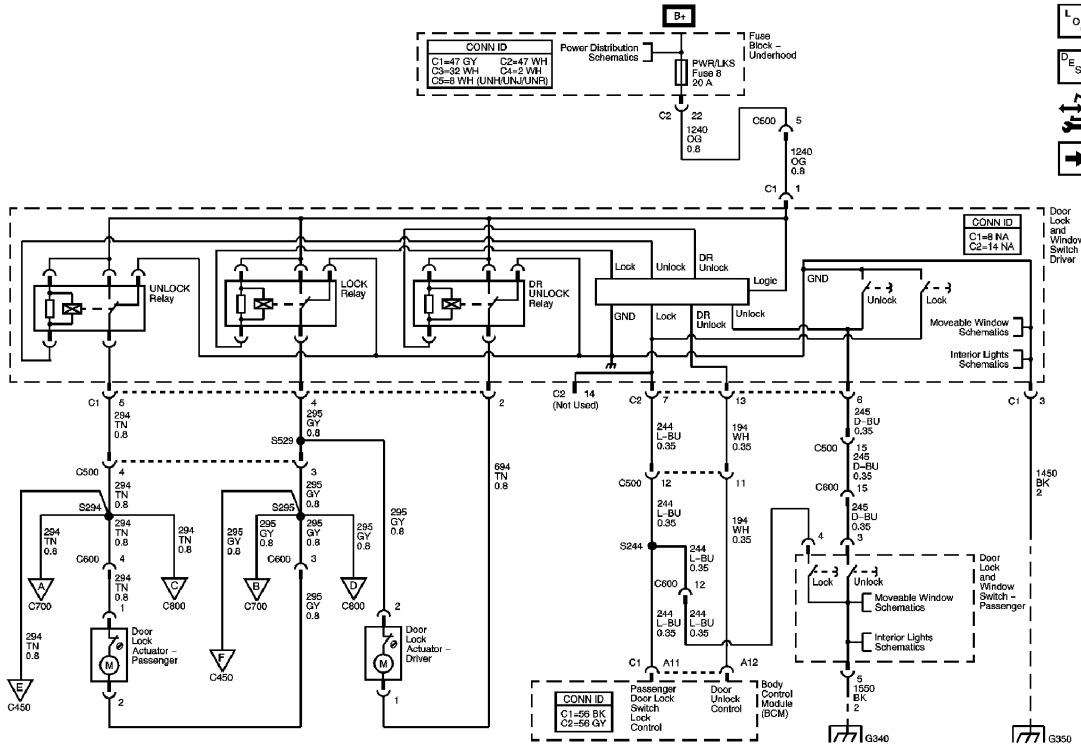

**Fig. 1: Power Door Locks Schematic**  
Courtesy of GENERAL MOTORS CORP.

# 2007 Hummer H3

## 2007 ACCESSORIES & EQUIPMENT Vehicle Access - H3

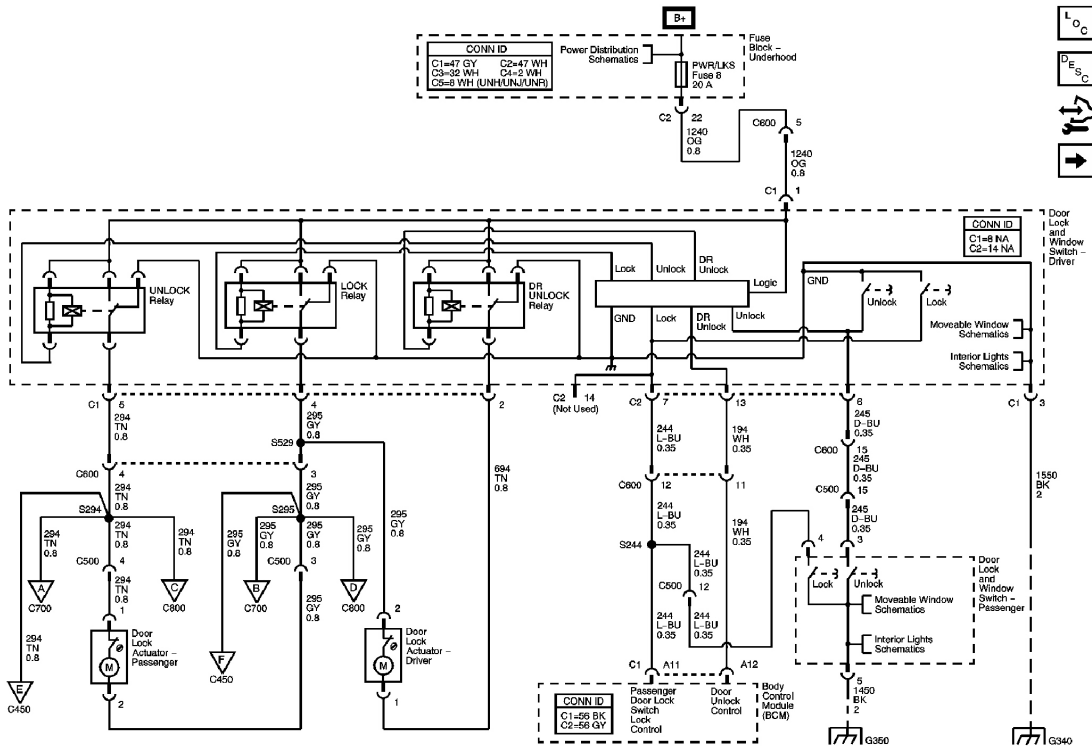

**Fig. 2: Power Door Locks Schematic - RHD**  
Courtesy of GENERAL MOTORS CORP.

# 2007 Hummer H3

## 2007 ACCESSORIES & EQUIPMENT Vehicle Access - H3

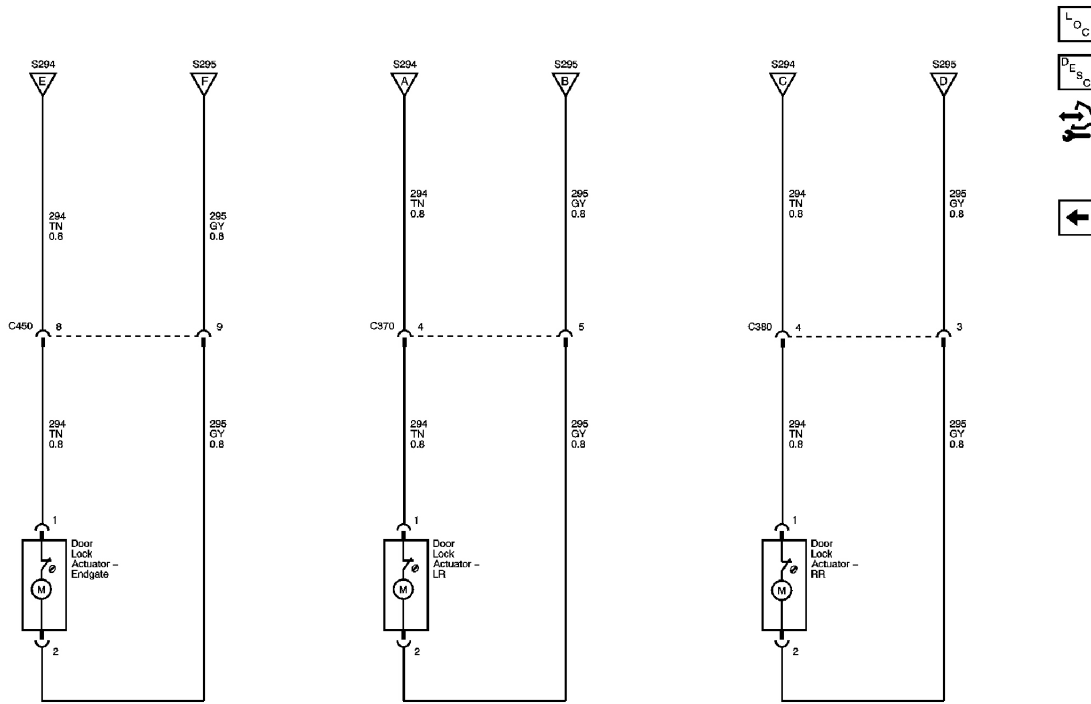

**Fig. 3: Rear Door Lock and Endgate Actuators Schematic**  
Courtesy of GENERAL MOTORS CORP.

### COMPONENT LOCATOR

### VEHICLE ACCESS COMPONENT VIEWS

## 2007 Hummer H3

2007 ACCESSORIES & EQUIPMENT Vehicle Access - H3

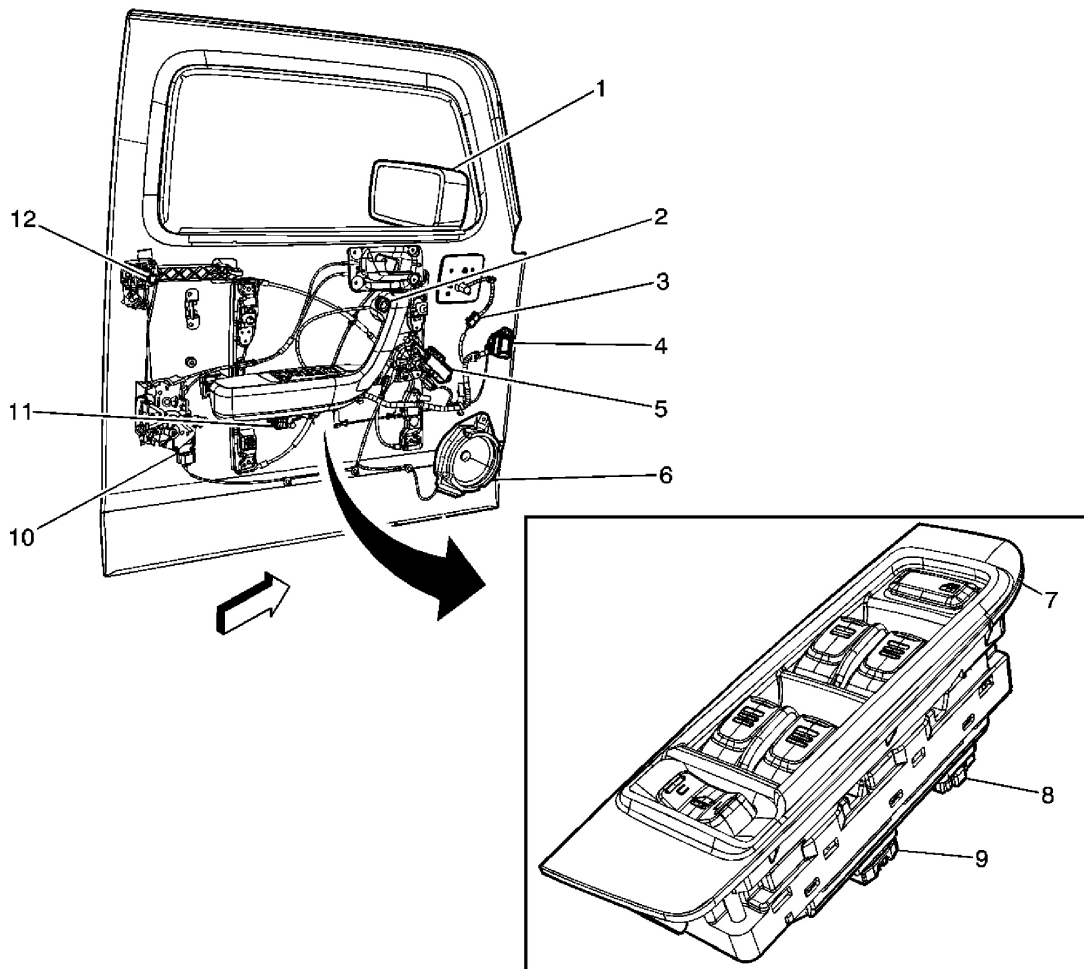

**Fig. 4: Identifying Driver Door Components**  
Courtesy of GENERAL MOTORS CORP.

### Callouts For Fig. 4

| Callout | Component Name  |
|---------|---|
| 1       | Outside Rearview Mirror - Driver                            |
| 2       | Outside Rearview Mirror Switch                              |
| 3       | C510 Driver Door Harness to Outside Rearview Mirror Harness |
| 4       | C500 Door Harness to Body Harness                           |
| 5       | Window Motor - Driver                                       |
| 6       | Speaker - LF Door   |
| 7       | Door Lock and Window Switch - Driver                        |
| 8       | Door Lock and Window Switch - Driver C1                     |
| 9       | Door Lock and Window Switch - Driver C2                     |

## 2007 Hummer H3

### 2007 ACCESSORIES & EQUIPMENT Vehicle Access - H3

|    |  |
|----|--|
| 10 | Door Lock Actuator - Driver                                |
| 11 | Inflatable Restraint Side Impact Sensor (SIS) - Left (ASF) |
| 12 | Key Lock Cylinder  |

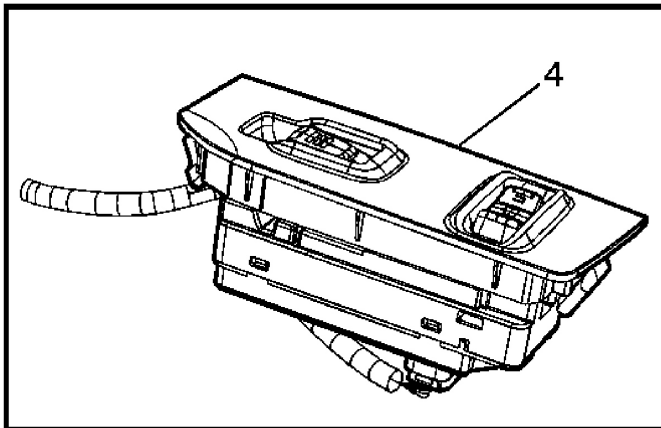
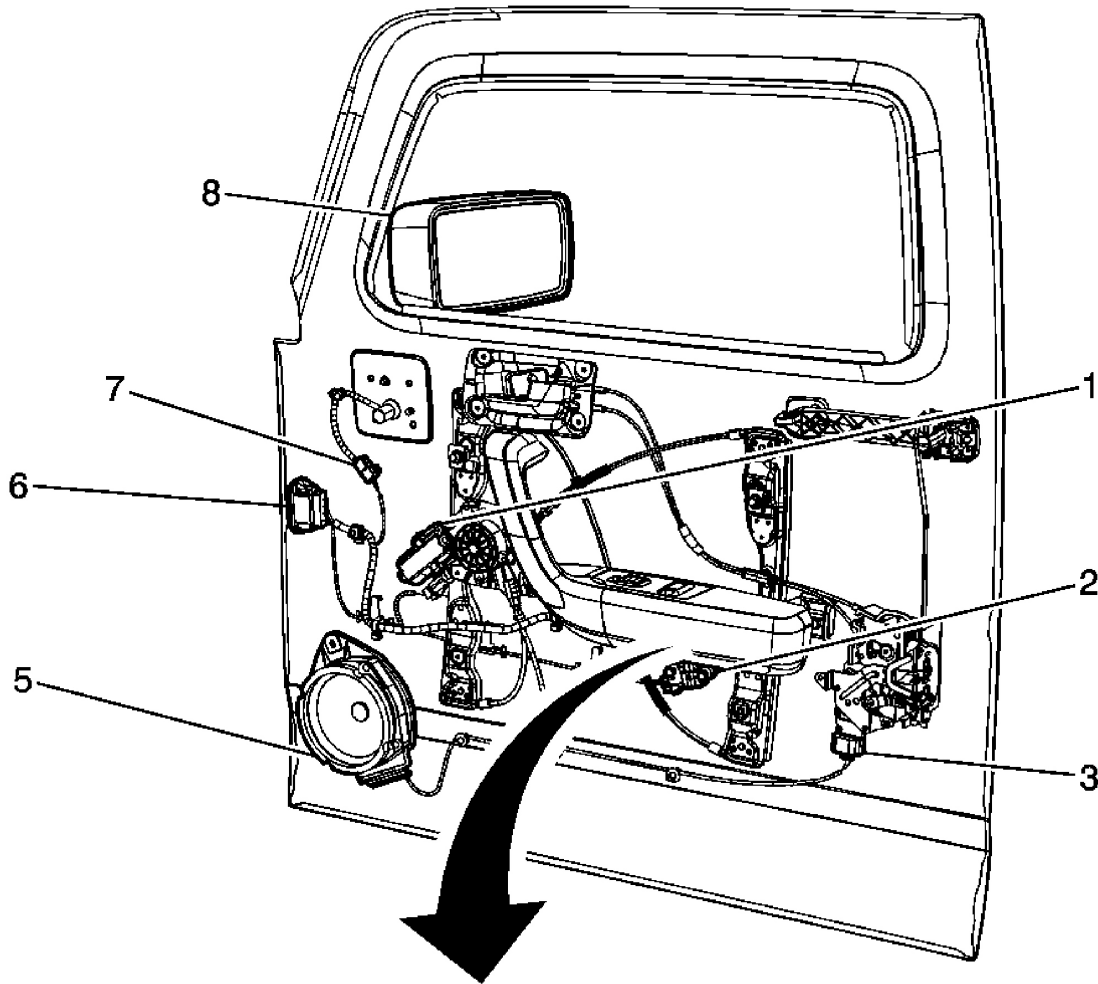

**Fig. 5: Identifying Passenger Door Components**  
**Courtesy of GENERAL MOTORS CORP.**

**Callouts For Fig. 5**

| <b>Callout</b> | <b>Component Name</b>                                       |
|----------------|---|
| 1              | Window Motor - Passenger                                    |
| 2              | Inflatable Restraint Side Impact Sensor (SIS) - Right (ASF) |
| 3              | Door Lock Actuator - Passenger                              |
| 4              | Door Lock/Window Switch - Passenger                         |
| 5              | Speaker - RF  |
| 6              | C600 Passenger Door Harness to Body Harness                 |
| 7              | C610 Passenger Door Harness to Rearview Mirror Harness      |
| 8              | Outside Rearview Mirror - Passenger                         |

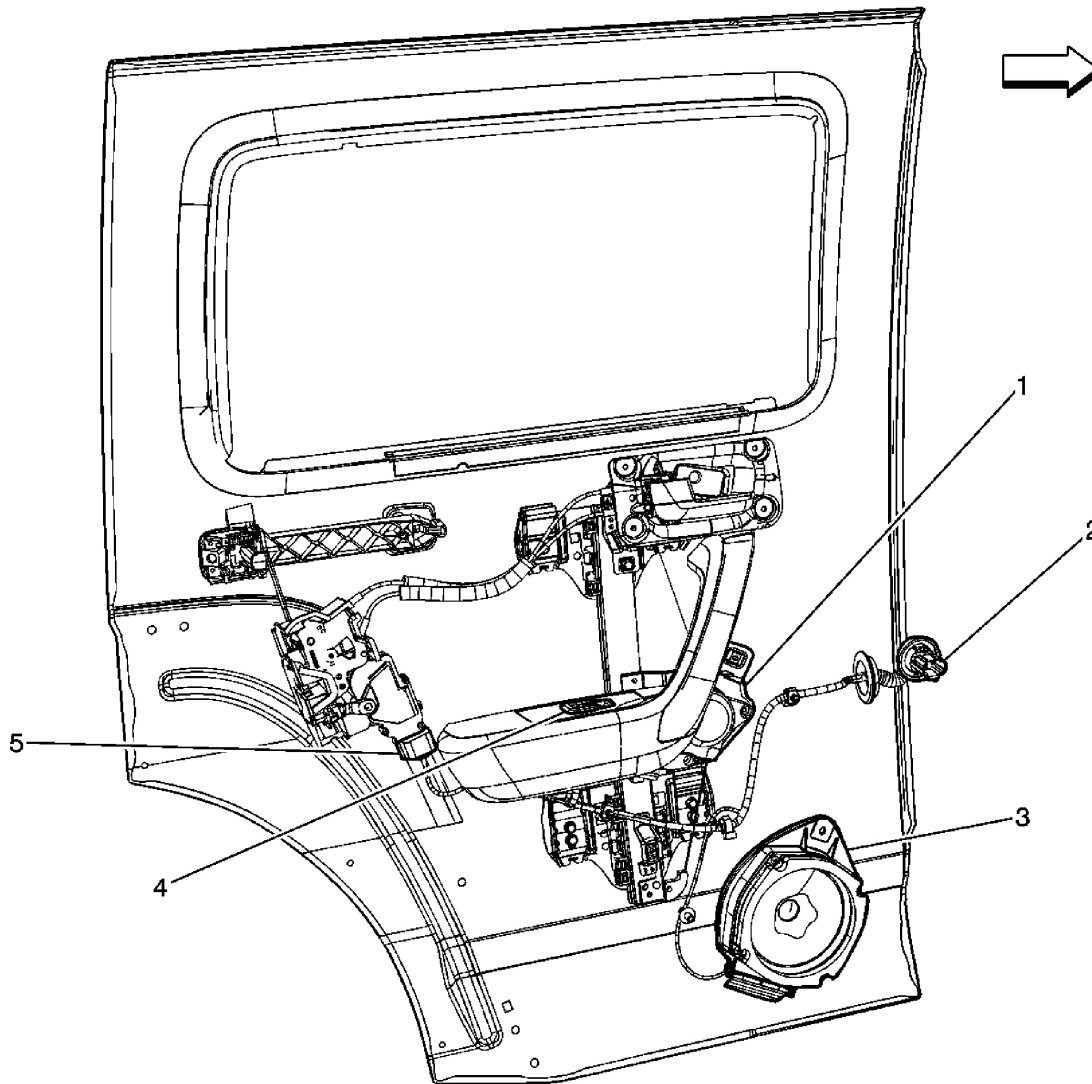

**Fig. 6: Identifying Left Rear Door Components (RR Similar)**  
 Courtesy of GENERAL MOTORS CORP.

**Callouts For Fig. 6**

| Callout | Component Name                              |
|---------|---|
| 1       | Window Motor - LR                           |
| 2       | C370 Left Rear Door Harness to Body Harness |
| 3       | Speaker - LR                                |
| 4       | Window Switch - LR                          |
| 5       | Door Lock Actuator - LR                     |



## 2007 Hummer H3

### 2007 ACCESSORIES & EQUIPMENT Vehicle Access - H3

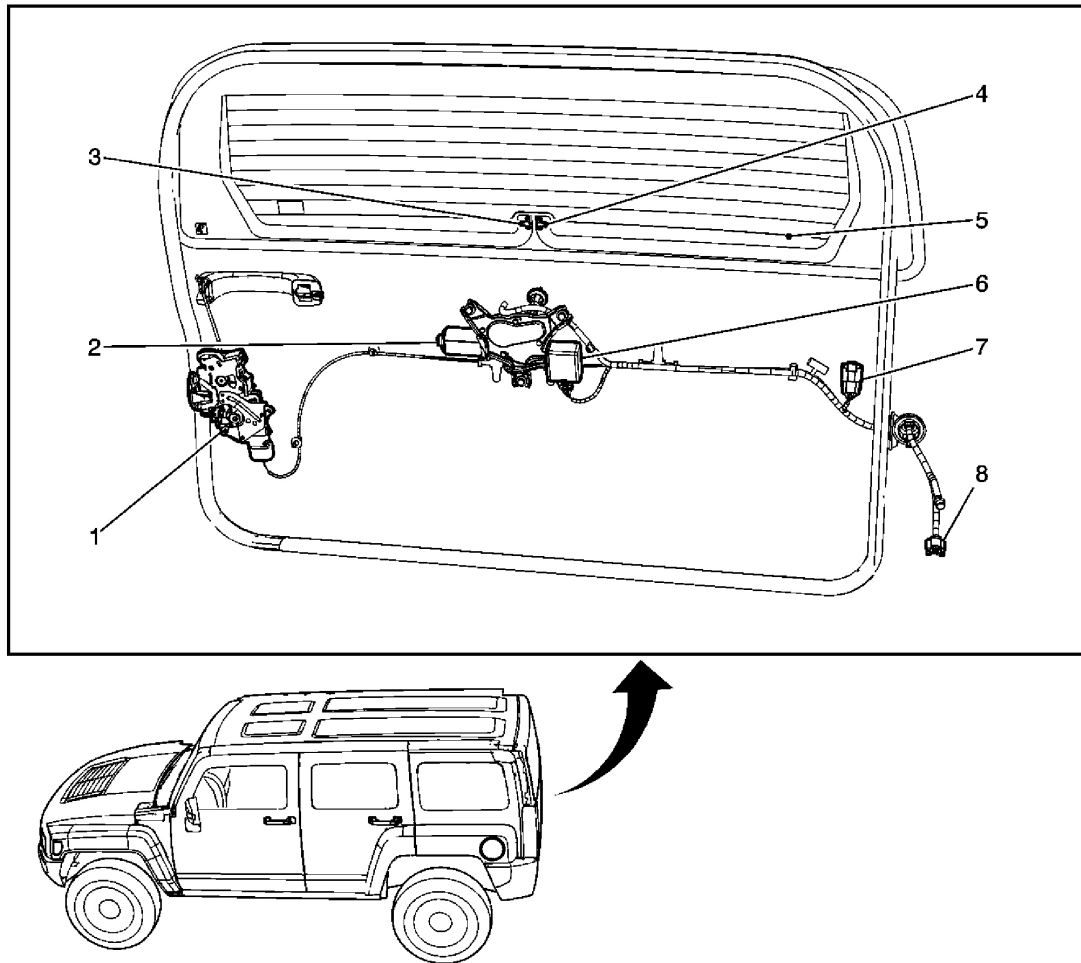

**Fig. 7: Identifying Endgate Components**  
Courtesy of GENERAL MOTORS CORP.

#### Callouts For Fig. 7

| Callout | Component Name                               |
|---------|--|
| 1       | Door Lock Actuator - Endgate                 |
| 2       | Rear Window Wiper Motor                      |
| 3       | Rear Window Defogger Connector               |
| 4       | Rear Window Defogger Connector               |
| 5       | Rear Window Defogger                         |
| 6       | Rear Window Wiper/Washer Module              |
| 7       | C901 CHMSL Jumper Harness to Endgate Harness |
| 8       | C450 Body Harness to Endgate Harness         |

## VEHICLE ACCESS CONNECTOR END VIEWS

### Door Lock Actuator - Driver

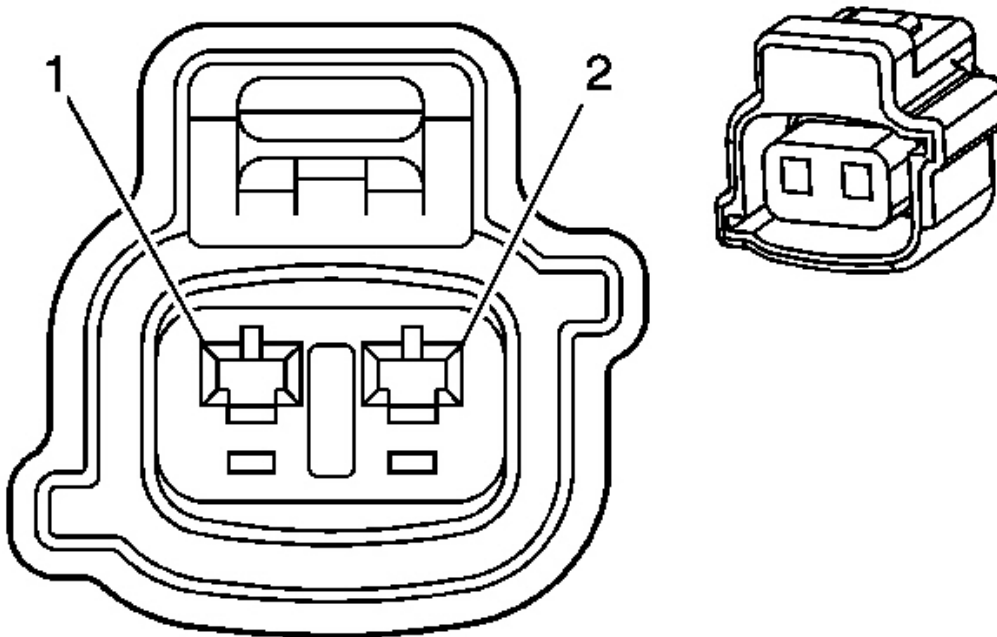

**Fig. 8: Door Lock Actuator Connector End Views**  
Courtesy of GENERAL MOTORS CORP.

### Driver Door Lock Actuator Connector Parts Information

#### Connector Part Information

- OEM: 6189-0438
- Service: 89046646
- Description: 2-Way F TS 090 Sealed Series (WH)

#### Terminal Part Information

- Terminal/Tray: 8100-0461/6
- Core/Insulation Crimp: E/1
- Release Tool/Test Probe: 15315247/J-35616-2A (GY)

**Driver Door Lock Actuator Connector Terminal Identification**

| Pin | Wire Color | Circuit No. | Function                                 |
|-----|------------|-------------|--|
| 1   | TN         | 694         | Driver Door Lock Actuator Unlock Control |
| 2   | GY         | 295         | Door Lock Actuator Lock Control          |

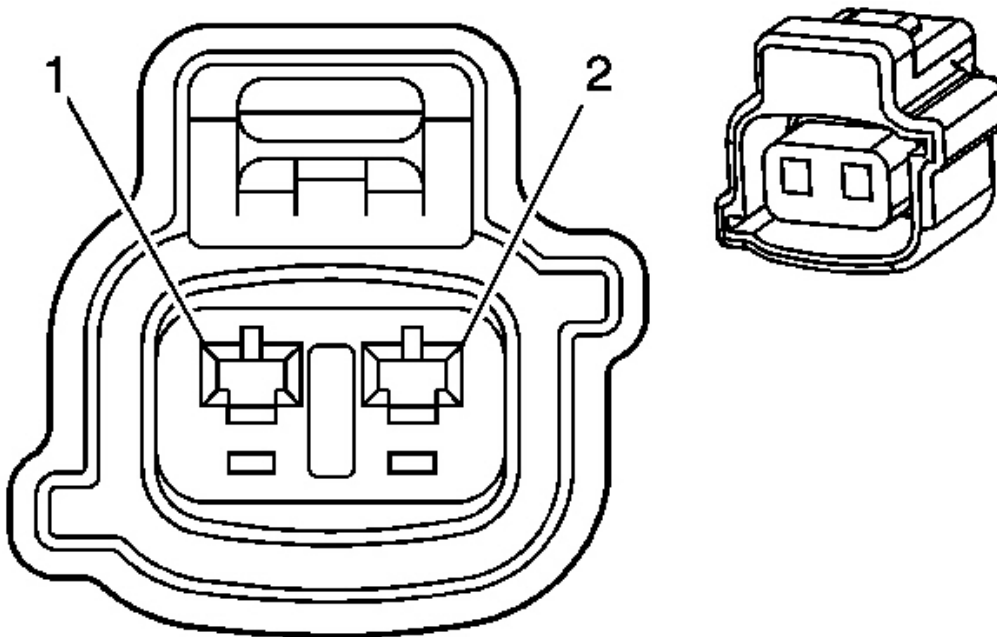
**Door Lock Actuator - Endgate**

**Fig. 9: Door Lock Actuator Connector End Views**  
 Courtesy of GENERAL MOTORS CORP.

**Endgate Lock Actuator Connector Parts Information****Connector Part Information**

- OEM: 6189-0438
- Service: 89046646
- Description: 2-Way F TS 090 Sealed Series (WH)

**Terminal Part Information**

## 2007 Hummer H3

2007 ACCESSORIES & EQUIPMENT Vehicle Access - H3

- Terminal/Tray: 8100-0461/6
- Core/Insulation Crimp: E/1
- Release Tool/Test Probe: 15315247/J-35616-2A (GY)

### Endgate Lock Actuator - Endgate Connector Terminal Identification

| Pin | Wire Color | Circuit No. | Function                          |
|-----|------------|-------------|-----------------------------------|
| 1   | TN         | 294         | Door Lock Actuator Unlock Control |
| 2   | GY         | 295         | Door Lock Actuator Lock Control   |

#### Door Lock Actuator - Passenger

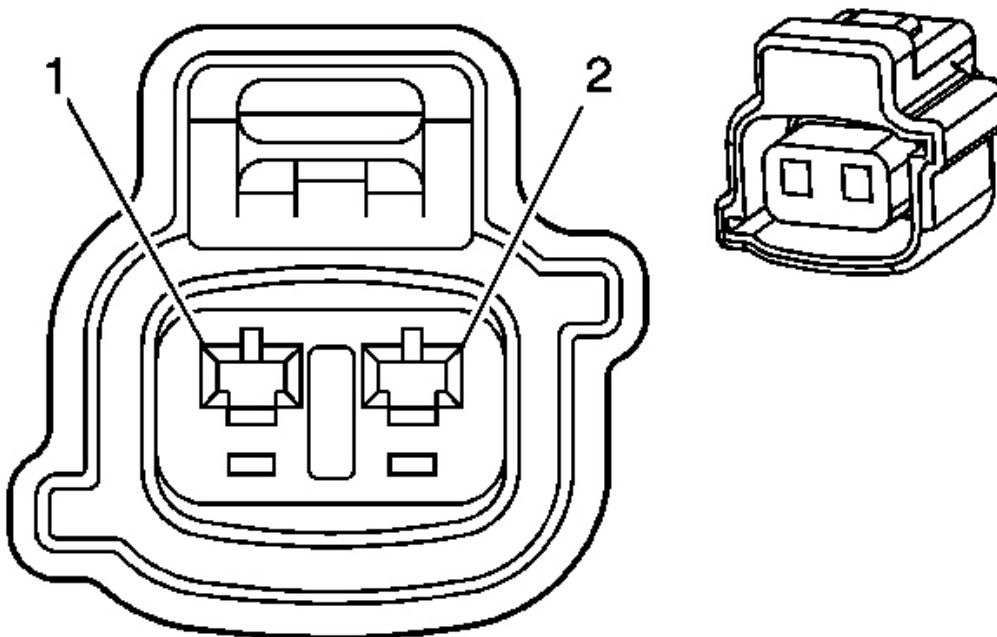

**Fig. 10: Door Lock Actuator Connector End Views**  
Courtesy of GENERAL MOTORS CORP.

#### Passenger Door Lock Actuator Connector Parts Information

##### Connector Part Information

- OEM: 6189-0438

- Service: 89046646
- Description: 2-Way F TS 090 Sealed Series (WH)

**Terminal Part Information**

- Terminal/Tray: 8100-0461/6
- Core/Insulation Crimp: E/1
- Release Tool/Test Probe: 15315247/J-35616-2A (GY)

**Passenger Door Lock Actuator Connector Terminal Identification**

| Pin | Wire Color | Circuit No. | Function                          |
|-----|------------|-------------|-----------------------------------|
| 1   | TN         | 294         | Door Lock Actuator Unlock Control |
| 2   | GY         | 295         | Door Lock Actuator Lock Control   |

**Door Lock Actuator - Left Rear**

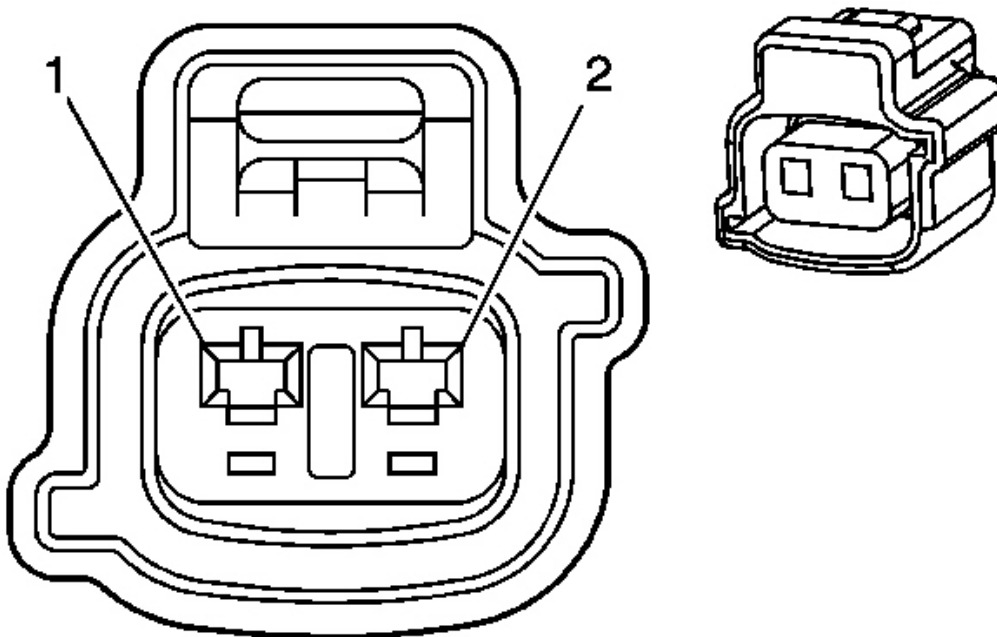

**Fig. 11: Door Lock Actuator Connector End Views**  
 Courtesy of GENERAL MOTORS CORP.

## 2007 Hummer H3

2007 ACCESSORIES & EQUIPMENT Vehicle Access - H3

### Left Rear Door Lock Actuator Connector Parts Information

#### Connector Part Information

- OEM: 6189-0438
- Service: 89046646
- Description: 2-Way F TS 090 Sealed Series (WH)

#### Terminal Part Information

- Terminal/Tray: 8100-0461/6
- Core/Insulation Crimp: E/1
- Release Tool/Test Probe: 15315247/J-35616-2A (GY)

### Left Rear Door Lock Actuator Connector Terminal Identification

| Pin | Wire Color | Circuit No. | Function                          |
|-----|------------|-------------|-----------------------------------|
| 1   | TN         | 294         | Door Lock Actuator Unlock Control |
| 2   | GY         | 295         | Door Lock Actuator Lock Control   |

Door Lock Actuator - Right Rear

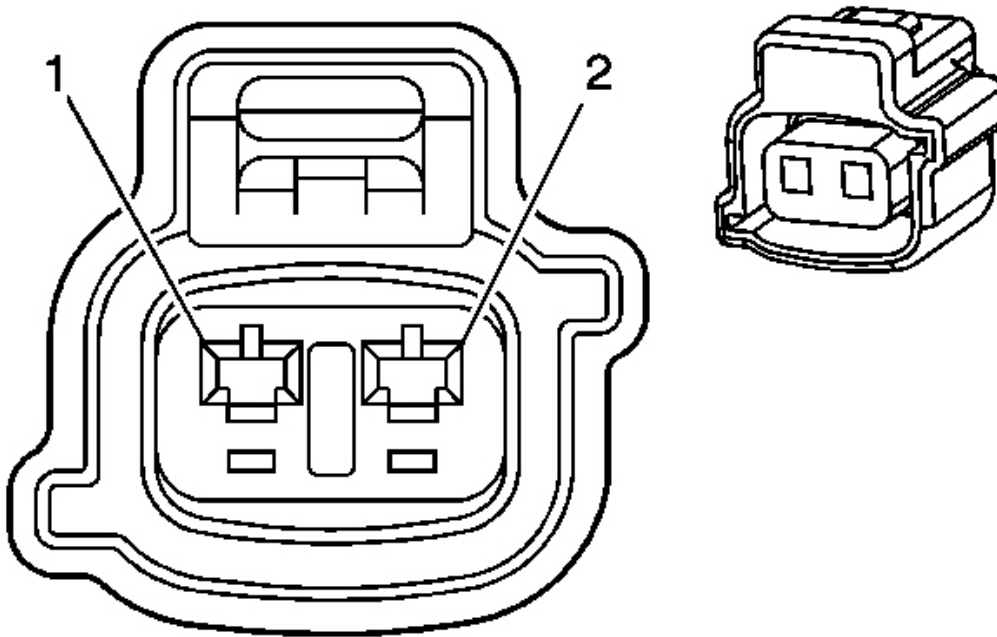

**Fig. 12: Door Lock Actuator Connector End Views**  
 Courtesy of GENERAL MOTORS CORP.

**Right Rear Door Lock Actuator Connector Parts Information**

**Connector Part Information**

- OEM: 6189-0438
- Service: 89046646
- Description: 2-Way F TS 090 Sealed Series (WH)

**Terminal Part Information**

- Terminal/Tray: 8100-0461/6
- Core/Insulation Crimp: E/1
- Release Tool/Test Probe: 15315247/J-35616-2A (GY)

**Right Rear Door Lock Actuator Connector Terminal Identification**

| Pin | Wire Color | Circuit No. | Function |
|-----|------------|-------------|----------|
|     |            |             |          |

## 2007 Hummer H3

### 2007 ACCESSORIES & EQUIPMENT Vehicle Access - H3

|   |    |     |                                   |
|---|----|-----|-----------------------------------|
| 1 | TN | 294 | Door Lock Actuator Unlock Control |
| 2 | GY | 295 | Door Lock Actuator Lock Control   |

#### Door Lock and Window Switch - Driver C1

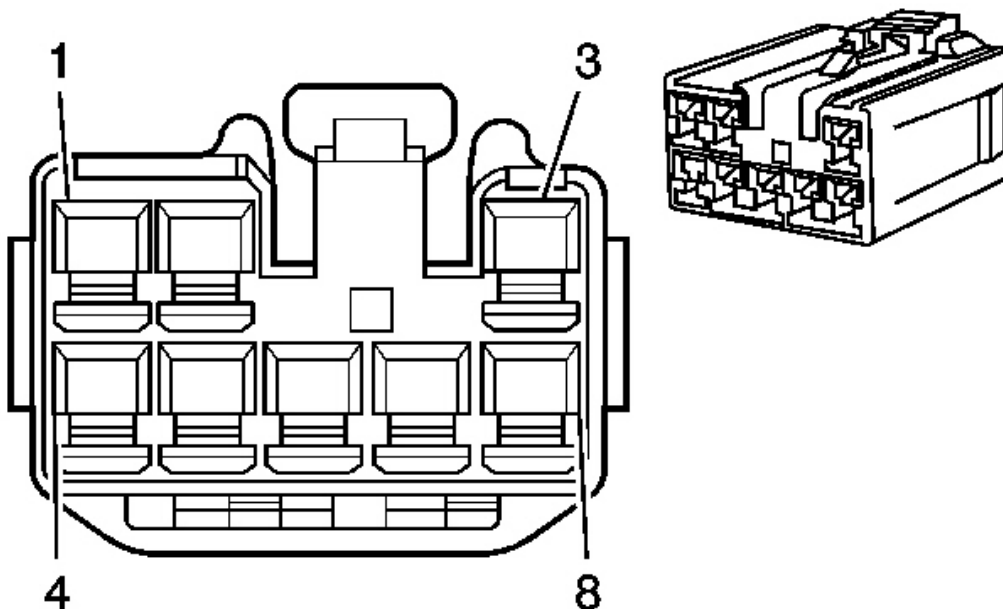

**Fig. 13: Driver Door Lock and Window Switch C1 Connector End View**  
Courtesy of GENERAL MOTORS CORP.

#### Driver Door Lock and Window Switch C1 Connector Parts Information

##### Connector Part Information

- OEM: 6240-5068
- Service: 88987940
- Description: 8-Way F TS 090 Series (BU)

##### Terminal Part Information

- Pins: 1-2, 4-5
- Terminal/Tray: 8240-4892/22
- Core/Insulation Crimp: E/C



## 2007 Hummer H3

### 2007 ACCESSORIES & EQUIPMENT Vehicle Access - H3

- Release Tool/Test Probe: 15315247/J-35616-18 (BK)
- Pins: 3, 6-8
- Terminal/Tray: 8240-4942/22
- Core/Insulation Crimp: 2/1
- Release Tool/Test Probe: 15315247/J-35616-18 (BK)

### Driver Door Lock and Window Switch C1 Connector Terminal Identification

| Pin | Wire Color | Circuit No. | Function                                   |
|-----|------------|-------------|--|
| 1   | OG         | 1240        | Battery Positive Voltage                   |
| 2   | TN         | 694         | Driver Door Lock Actuator Unlock Control   |
| 3   | BK         | 1450        | Ground                                     |
| 4   | GY         | 295         | Door Lock Actuator Lock Control            |
| 5   | TN         | 294         | Door Lock Actuator Unlock Control          |
| 6   | YE         | 643         | Accessory Voltage                          |
| 7   | D-BU       | 164         | Power Window Motor Left Front Up Control   |
| 8   | BN         | 165         | Power Window Motor Left Front Down Control |

### Door Lock and Window Switch - Driver C2

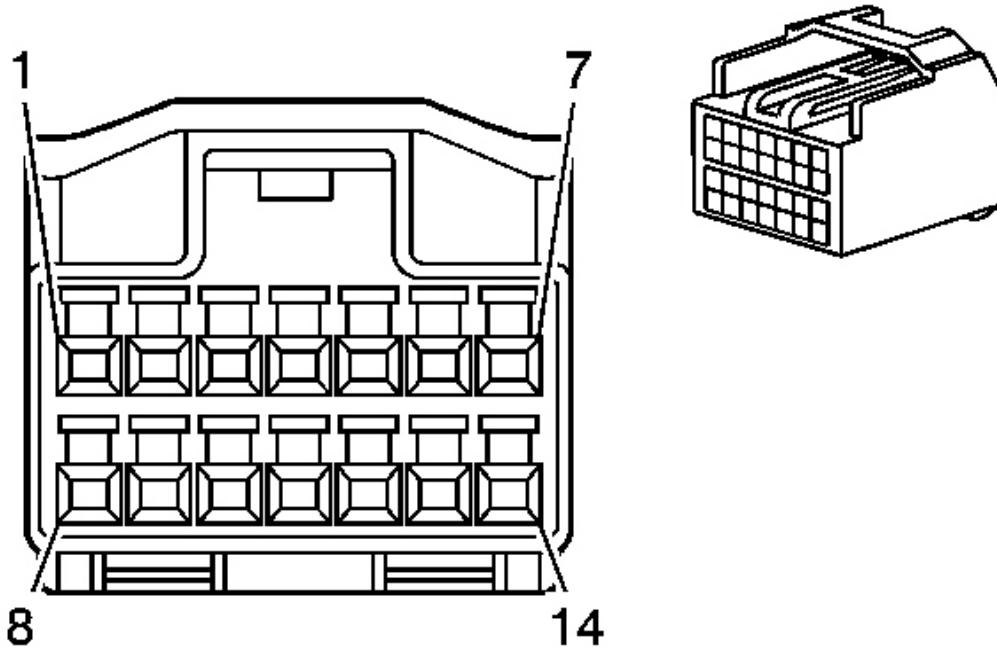

**Fig. 14: driver Door Lock and Window Switch C2 Connector End View**  
 Courtesy of GENERAL MOTORS CORP.

**Driver Door Lock and Window Switch C2 Connector Parts Information**

**Connector Part Information**

- OEM: 7283-5832
- Service: See Catalog
- Description: 14-Way F 040-III, Class II (WH)

**Terminal Part Information**

- Terminal/Tray: 7116-4231-08/14
- Core/Insulation Crimp: K/K
- Release Tool/Test Probe: 15315247/J-35616-64A (L-BU)

**Driver Door Lock and Window Switch C2 Connector Terminal Identification**

| Pin | Wire Color | Circuit No. | Function |
|-----|------------|-------------|----------|
|     |            |             |          |

**2007 Hummer H3**

## 2007 ACCESSORIES &amp; EQUIPMENT Vehicle Access - H3

|    |      |      |  |
|----|------|------|--|
| 1  | D-BU | 1307 | Power Window Master Switch Lockout Signal          |
| 2  | BN   | 9    | Park Lamp Supply Voltage                           |
| 3  | -    | -    | Not Used   |
| 4  | PU   | 171  | Power Window Master Switch Right Rear Down Signal  |
| 5  | L-GN | 170  | Power Window Master Switch Right Rear Up Signal    |
| 6  | D-BU | 245  | Passenger Door Lock Switch Unlock Control          |
| 7  | L-BU | 244  | Passenger Door Lock Switch Lock Control            |
| 8  | L-BU | 166  | Power Window Master Switch Right Front Up Signal   |
| 9  | TN   | 167  | Power Window Master Switch Right Front Down Signal |
| 10 | -    | -    | Not Used   |
| 11 | PU   | 169  | Power Window Master Switch Left Rear Down Signal   |
| 12 | D-GN | 168  | Power Window Master Switch Left Rear Up Signal     |
| 13 | WH   | 194  | Door Unlock Control                                |
| 14 | -    | -    | Not Used   |

**Door Lock and Window Switch - Passenger**

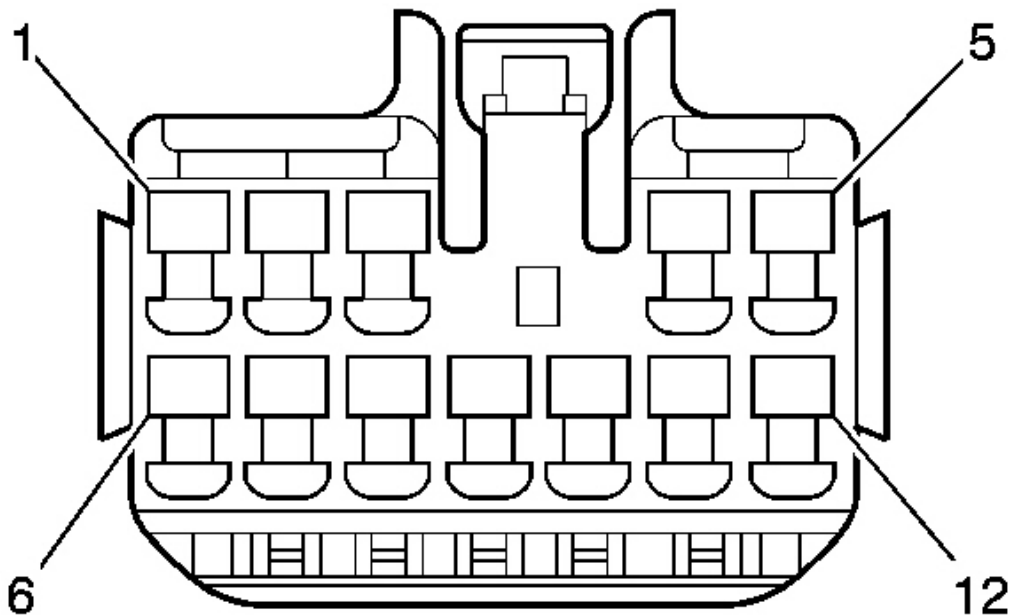

**Fig. 15: Passenger Door Lock and Window Switch Connector End View**  
 Courtesy of GENERAL MOTORS CORP.

### Passenger Door Lock and Window Switch Connector Parts Information

#### Connector Part Information

- OEM: 7283-1120
- Service: See Catalog
- Description: 12-Way F 090-II (WH)

#### Terminal Part Information

- Pins: 3-4, 6-9
- Terminal/Tray: 7116-4020/11
- Core/Insulation Crimp: E/C
- Release Tool/Test Probe: 15315247/J-35616-18 (BK)
- Pins: 5, 10-12
- Terminal/Tray: 7116-4022/11

## 2007 Hummer H3

2007 ACCESSORIES & EQUIPMENT Vehicle Access - H3

- Core/Insulation Crimp: 4/A
- Release Tool/Test Probe: 15315247/J-35616-18 (BK)

### Passenger Door Lock and Window Switch Connector Terminal Identification

| Pin | Wire Color | Circuit No. | Function   |
|-----|------------|-------------|--|
| 1-2 | -          | -           | Not Used   |
| 3   | D-BU       | 245         | Passenger Door Lock Switch Unlock Control          |
| 4   | L-BU       | 244         | Passenger Door Lock Switch Lock Control            |
| 5   | BK         | 1550        | Ground   |
| 6   | BN         | 9           | Park Lamp Supply Voltage                           |
| 7   | D-BU       | 1307        | Power Window Master Switch Lockout Signal          |
| 8   | TN         | 167         | Power Window Master Switch Right Front Down Signal |
| 9   | L-BU       | 166         | Power Window Master Switch Right Front Up Signal   |
| 10  | BN         | 667         | Power Window Motor Right Front Down Control        |
| 11  | YE         | 443         | Accessory Voltage                                  |
| 12  | D-BU       | 666         | Power Window Motor Right Front Up Control          |

## DIAGNOSTIC INFORMATION AND PROCEDURES

### DIAGNOSTIC CODE INDEX

### DIAGNOSTIC CODE INDEX

| DTC                              | Description           |
|----------------------------------|-----------------------|
| <b><u>DTC B3142 or B3143</u></b> | Unlock Switch Circuit |
| <b><u>DTC B3152 or B3153</u></b> | Lock Switch Circuit   |

### DIAGNOSTIC STARTING POINT - VEHICLE ACCESS

Begin the system diagnosis with the **Diagnostic System Check - Vehicle** . The Diagnostic System Check will provide the following information:

- The identification of the control modules which command the system
- The ability of the control modules to communicate through the serial data circuit
- The identification of any stored diagnostic trouble codes (DTCs) and their status

The use of the Diagnostic System Check will identify the correct procedure for diagnosing the system and where the procedure is located.

## **SCAN TOOL DATA DEFINITIONS**

### **All Door Unlock Relay**

The scan tool displays On/Off. The door unlock relay output from the body control module (BCM), where the relay actuating to the unlock position is displayed as On.

### **Battery Voltage Signal**

The scan tool displays 9.0-15.0 volts. The state of the battery voltage supplied to the BCM.

### **Calibration ID**

The scan tool displays the calibration ID number of the BCM.

### **Door Lock Relay**

The scan tool displays On/Off. The door lock relay output from the BCM, where the relay actuating to the lock position is displayed as On.

### **Door Lock Relay Fdbk.**

The scan tool displays Active/Inactive. The door lock relay feedback input to the BCM, where the relay being actuated is displayed as Active.

### **Driver Door Ajar Sw.**

The scan tool displays Door Closed/Door Ajar. The driver door ajar switch input to the BCM, where a closed switch is displayed as Door Ajar.

### **End Model Part Number**

The scan tool displays the end model part number of the BCM.

## 2007 Hummer H3

2007 ACCESSORIES & EQUIPMENT Vehicle Access - H3

### Julian Date of Build

The scan tool displays the date the BCM was built.

### Passenger Door Ajar Sw.

The scan tool displays Door Closed/Door Ajar. The passenger door ajar switch input to the BCM, where a closed switch is displayed as Door Ajar.

### Software Part Number

The scan tool displays the BCMs software revision part number.

### Year Module Build

The scan tool displays the year the BCM was built.

### SCAN TOOL DATA LIST

#### Body Control Module Scan Tool Data List

| Scan Tool Parameter                              | Data List      | Units Displayed       | Typical Data Value |
|--|----------------|-----------------------|--------------------|
| <b>Operating Conditions: Key ON, Engine OFF.</b> |                |                       |                    |
| All Door Unlock Relay                            | Outputs        | On/Off                | Off                |
| Battery Voltage Signal                           | Data           | Volts                 | 12.8 Volts         |
| Calibration ID                                   | ID Information | Numerical             | XXXX               |
| Door Lock Relay                                  | Outputs        | On/Off                | Off                |
| Door Lock Relay Fdbk.                            | Inputs         | Active/Inactive       | Inactive           |
| Driver Door Ajar Sw.                             | Inputs         | Door Closed/Door Ajar | Door Closed        |
| End Model Part Number                            | ID Information | Numerical             | XXXX               |
| Julian Date of Build                             | ID Information | Numerical             | XXX                |
| Passenger Door Ajar Sw.                          | Inputs         | Door Closed/Door Ajar | Door Closed        |
| Software Part Number                             | ID Information | Numerical             | XXXX               |
| Year Module Built                                | ID Information | Numerical             | XXXX               |

### SCAN TOOL OUTPUT CONTROLS

## 2007 Hummer H3

2007 ACCESSORIES & EQUIPMENT Vehicle Access - H3

### Body Control Module

| Scan Tool Output Control | Additional Menu Selection(s) | Description   |
|--------------------------|------------------------------|---|
| Door Lock                | Door Lock Test               | The body control module (BCM) actuates all of the door lock actuators for approximately 5 seconds when you select On. All of the doors should lock. |
| Unlock Doors             | Door Lock Test               | The BCM actuates all of the door lock actuators for approximately 5 seconds when you select On. All of the doors should unlock.                     |

### DTC B3142 OR B3143

#### Circuit Description

The body control module (BCM) provides an output to the driver switch assembly through the door unlock control circuit for controlling automatic door unlock, anti-lockout and keyless entry unlock functions.

#### DTC Descriptors

This diagnostic procedure supports the following DTCs:

- DTC B3142 Unlock Switch Circuit Low
- DTC B3143 Unlock Switch Circuit High

#### Conditions for Setting the DTC

- The BCM detects a short to ground on the door unlock control circuit for greater than 60 seconds.
- The BCM detects a short to battery on the door unlock control circuit for greater than 1 second.

#### Action Taken When the DTC Sets

- The BCM stores DTC B3142 or B3143 in memory.
- The BCM will disable the output and all operations of the output until the fault no longer exists.

#### Conditions for Clearing the DTC

- The BCM no longer detects the short to ground on the door unlock control circuit for



## 2007 Hummer H3

### 2007 ACCESSORIES & EQUIPMENT Vehicle Access - H3

greater than 60 seconds.

- The BCM no longer detects the short to battery on the door unlock control circuit for greater than 1 second.
- 100 consecutive ignition cycles have been recorded without the DTC being detected.

#### Diagnostic Aids

If DTC B3142 or B3143 are history DTCs, the fault may be intermittent. Refer to **Testing for Intermittent Conditions and Poor Connections** .

#### Test Description

The numbers below refer to the step numbers on the diagnostic table.

**2:** This step determines whether the key cylinder switch is shorted.

**3:** This step determines whether the driver switch assembly is shorted.

#### DTC B3142 or B3143

| Step  | Action   | Yes                 | No  |
|---|--|---------------------|---|
| <b>Schematic Reference: <u>Door Lock/Indicator Schematics</u></b><br><b>Connector End View Reference: <u>Vehicle Access Connector End Views</u></b> |  |                     |   |
| 1   | Did you perform the Diagnostic System Check - Vehicle?   | Go to <b>Step 2</b> | Go to <b><u>Diagnostic System Check - Vehicle</u></b> |
| 2   | <ol style="list-style-type: none"><li>1. Turn OFF the ignition.</li><li>2. Disconnect the driver switch assembly.</li><li>3. Turn ON the ignition, with the engine OFF.</li><li>4. Use the scan tool in order to clear the DTCs.</li><li>5. Operate the vehicle within normal operating conditions.</li></ol> <p>Does the DTC reset?</p> | Go to <b>Step 3</b> | Go to <b>Step 4</b>                                   |
|   | Test the door unlock control circuit for a short to ground or voltage. Refer to  |                     |   |

**2007 Hummer H3**

2007 ACCESSORIES & EQUIPMENT Vehicle Access - H3

|   |  |                     |                     |
|---|--|---------------------|---------------------|
| 3 | <p><b><u>Circuit Testing and Wiring Repairs</u></b> .<br/>Did you find and correct the condition?</p>  | Go to <b>Step 8</b> | Go to <b>Step 5</b> |
| 4 | <p>Inspect for poor connections at the harness connector of the driver switch assembly. Refer to <b><u>Testing for Intermittent Conditions and Poor Connections</u></b> and <b><u>Connector Repairs</u></b> .<br/>Did you find and correct the condition?</p>  | Go to <b>Step 8</b> | Go to <b>Step 6</b> |
| 5 | <p>Inspect for poor connections at the harness connector of the body control module (BCM). Refer to <b><u>Testing for Intermittent Conditions and Poor Connections</u></b> and <b><u>Connector Repairs</u></b> .<br/>Did you find and correct the condition?</p>   | Go to <b>Step 8</b> | Go to <b>Step 7</b> |
| 6 | <p>Replace the driver switch assembly. Refer to <b><u>Door Lock and Side Window Switch Replacement - Driver Side (1st Design)</u></b> or <b><u>Door Lock and Side Window Switch Replacement - Driver Side (2nd Design)</u></b> or <b><u>Door Lock and Side Window Switch Replacement - Passenger Side</u></b>.<br/>Did you complete the replacement?</p> | Go to <b>Step 8</b> | -                   |
| 7 | <p>Replace the BCM. Refer to <b><u>Control Module References</u></b> for replacement, setup and programming.<br/>Did you complete the replacement?</p>   | Go to <b>Step 8</b> | -                   |
| 8 | <p>1. Use the scan tool in order to clear the DTCs.<br/>2. Operate the vehicle within the Conditions for Running the DTC as specified in the supporting text.<br/><br/>Does the DTC reset?</p>   | Go to <b>Step 2</b> | System OK           |

**DTC B3152 OR B3153**

**Circuit Description**

The body control module (BCM) provides an output to the driver switch assembly through the

passenger door lock switch lock control circuit for controlling automatic door lock and keyless entry lock functions.

**DTC Descriptors**

This diagnostic procedure supports the following DTCs:

- DTC B3152 Lock Switch Circuit Low
- DTC B3153 Lock Switch Circuit High

**Conditions for Setting the DTC**

- The BCM detects a short to ground on the passenger door lock switch lock control circuit for greater than 60 seconds.
- The BCM detects a short to battery on the passenger door lock switch lock control circuit for greater than 1 second.

**Action Taken When the DTC Sets**

- The BCM stores DTC B3152 or B3153 in memory.
- The BCM will disable the output and all operations of the output until the fault no longer exists.

**Conditions for Clearing the DTC**

- The BCM no longer detects the short to ground on the passenger door lock switch lock control circuit for greater than 60 seconds.
- The BCM no longer detects the short to battery on the passenger door lock switch lock control circuit for greater than 1 second.
- 100 consecutive ignition cycles have been recorded without the DTC being detected.

**Diagnostic Aids**

If DTC B3152 or B3153 are history DTCs, the fault may be intermittent. Refer to **Testing for Intermittent Conditions and Poor Connections** .

**Test Description**

The numbers below refer to the step numbers on the diagnostic table.

- 2:** This step determines whether the key cylinder switch is shorted.

**2007 Hummer H3**

2007 ACCESSORIES & EQUIPMENT Vehicle Access - H3

**3:** This step determines whether the driver switch assembly is shorted.

**DTC B3152 or B3153**

| <b>Step</b>  | <b>Action</b>   | <b>Yes</b>           | <b>No</b>   |
|--|---|----------------------|---|
| <b>Schematic Reference: <u>Door Lock/Indicator Schematics</u></b>              |   |                      |   |
| <b>Connector End View Reference: <u>Vehicle Access Connector End Views</u></b> |   |                      |   |
| <b>1</b>   | Did you perform the Diagnostic System Check - Vehicle?  | Go to <b>Step 2</b>  | Go to <b><u>Diagnostic System Check - Vehicle</u></b> |
| <b>2</b>   | <ol style="list-style-type: none"> <li>1. Disconnect the passenger door lock switch.</li> <li>2. Turn ON the ignition, with the engine OFF.</li> <li>3. Use the scan tool in order to clear the DTCs.</li> <li>4. Operate the vehicle within normal operating conditions.</li> </ol> Does the DTC reset?                                | Go to <b>Step 3</b>  | Go to <b>Step 5</b>                                   |
| <b>3</b>   | <ol style="list-style-type: none"> <li>1. Turn OFF the ignition.</li> <li>2. Disconnect the driver switch assembly.</li> <li>3. Turn ON the ignition, with the engine OFF.</li> <li>4. Use the scan tool in order to clear the DTCs.</li> <li>5. Operate the vehicle within normal operating conditions.</li> </ol> Does the DTC reset? | Go to <b>Step 4</b>  | Go to <b>Step 6</b>                                   |
| <b>4</b>   | Test the passenger door lock switch lock control circuit for a short to ground or voltage. Refer to <b><u>Circuit Testing</u></b> and <b><u>Wiring Repairs</u></b> .<br>Did you find and correct the condition?   | Go to <b>Step 11</b> | Go to <b>Step 7</b>                                   |
|  | Inspect for poor connections at the harness   |                      |   |

2007 Hummer H3

2007 ACCESSORIES & EQUIPMENT Vehicle Access - H3

|    |   |                      |                      |
|----|---|----------------------|----------------------|
| 5  | <p>connector of the passenger door lock switch. Refer to <b><u>Testing for Intermittent Conditions and Poor Connections</u></b> and <b><u>Connector Repairs</u></b> .</p> <p>Did you find and correct the condition?</p>  | Go to <b>Step 11</b> | Go to <b>Step 8</b>  |
| 6  | <p>Inspect for poor connections at the harness connector of the driver switch assembly. Refer to <b><u>Testing for Intermittent Conditions and Poor Connections</u></b> and <b><u>Connector Repairs</u></b> .</p> <p>Did you find and correct the condition?</p>  | Go to <b>Step 11</b> | Go to <b>Step 9</b>  |
| 7  | <p>Inspect for poor connections at the harness connector of the body control module (BCM). Refer to <b><u>Testing for Intermittent Conditions and Poor Connections</u></b> and <b><u>Connector Repairs</u></b> .</p> <p>Did you find and correct the condition?</p>   | Go to <b>Step 11</b> | Go to <b>Step 10</b> |
| 8  | <p>Replace the passenger door lock switch. Refer to <b><u>Door Lock and Side Window Switch Replacement - Driver Side (1st Design)</u></b>, <b><u>Door Lock and Side Window Switch Replacement - Driver Side (2nd Design)</u></b> or <b><u>Door Lock and Side Window Switch Replacement - Passenger Side</u></b>.</p> <p>Did you complete the replacement?</p> | Go to <b>Step 11</b> | -                    |
| 9  | <p>Replace the driver switch assembly. Refer to <b><u>Door Lock and Side Window Switch Replacement - Driver Side (1st Design)</u></b>, <b><u>Door Lock and Side Window Switch Replacement - Driver Side (2nd Design)</u></b> or <b><u>Door Lock and Side Window Switch Replacement - Passenger Side</u></b>.</p> <p>Did you complete the replacement?</p>     | Go to <b>Step 11</b> | -                    |
| 10 | <p>Replace the BCM. Refer to <b><u>Control Module References</u></b> for replacement, setup and programming.</p> <p>Did you complete the replacement?</p>   | Go to <b>Step 11</b> | -                    |
|    | <p>1. Use the scan tool in order to clear the</p>   |                      |                      |

## 2007 Hummer H3

### 2007 ACCESSORIES & EQUIPMENT Vehicle Access - H3

|    |  |                     |           |
|----|--|---------------------|-----------|
| 11 | DTCs.<br>2. Operate the vehicle within the Conditions for Running the DTC as specified in the supporting text. |                     |           |
|    | Does the DTC reset?  | Go to <b>Step 2</b> | System OK |

#### SYMPTOMS - VEHICLE ACCESS

**IMPORTANT: The following steps must be completed before using the symptom tables.**

1. Perform the **Diagnostic System Check - Vehicle** before using the Symptom Tables in order to verify that all of the following are true:
  - There are no DTCs set.
  - The control modules can communicate via the serial data link.
2. Review the system operation in order to familiarize yourself with the system functions. Refer to the following system descriptions:
  - **Door Ajar Indicator Description and Operation**
  - **Power Door Locks Description and Operation**

#### Visual/Physical Inspection

- Inspect for aftermarket devices which could affect the operation of the door systems. Refer to **Checking Aftermarket Accessories** .
- Inspect the easily accessible or visible system components for obvious damage or conditions which could cause the symptom.

#### Intermittent

Faulty electrical connections or wiring may be the cause of intermittent conditions. Refer to **Testing for Intermittent Conditions and Poor Connections** .

#### Symptom List

Refer to a symptom diagnostic procedure from the following list in order to diagnose the symptom:

- **Automatic Door Locks Inoperative**

- **Door Ajar Indicator Malfunction**
- **Power Door Locks Inoperative**

**AUTOMATIC DOOR LOCKS INOPERATIVE**

**Automatic Door Locks Inoperative**

| Step   | Action  | Yes  | No  |
|--|---|--|---|
| <b>Schematic Reference: <u>Door Lock/Indicator Schematics</u></b>              |   |  |   |
| <b>Connector End View Reference: <u>Vehicle Access Connector End Views</u></b> |   |  |   |
| 1  | Did you review the Diagnostic System Check - Vehicle?   | Go to <b>Step 2</b>  | Go to <b><u>Diagnostic System Check - Vehicle</u></b> |
| 2  | Verify that the automatic door locks are inoperative.<br>Do the automatic door locks operate normally?  | Go to <b><u>Testing for Intermittent Conditions and Poor Connections</u></b> | Go to <b>Step 3</b>                                   |
| 3  | Observe the driver information center (DIC) for the current automatic door lock mode. Refer to <b><u>Vehicle Personalization</u></b> .<br>Is the correct automatic door lock mode selected?   | Go to <b>Step 4</b>  | Go to <b><u>Vehicle Personalization</u></b>           |
| 4  | Do the power door locks operate normally?   | Go to <b>Step 5</b>  | Go to <b><u>Power Door Locks Inoperative</u></b>      |
| 5  | 1. Close all of the doors.<br>2. With a scan tool, observe the driver door ajar sw. and the passenger door ajar sw. parameters in the body control module (BCM) data list.<br><br>Does the scan tool display Door Closed for both parameters? | Go to <b>Step 7</b>  | Go to <b>Step 6</b>                                   |
| 6  | Test the appropriate door ajar switch signal circuit of the appropriate door lock harness connector for a short to ground.<br>Refer to <b><u>Circuit Testing</u></b> and <b><u>Wiring</u></b>   |  |   |

**2007 Hummer H3**

2007 ACCESSORIES & EQUIPMENT Vehicle Access - H3

|    |   |                      |                      |
|----|---|----------------------|----------------------|
|    | <b><u>Repairs</u></b> .<br>Did you find and correct the condition?  | Go to <b>Step 11</b> | Go to <b>Step 8</b>  |
| 7  | Inspect for poor connections at the harness connector of the BCM. Refer to <b><u>Testing for Intermittent Conditions and Poor Connections</u></b> and <b><u>Connector Repairs</u></b> .<br>Did you find and correct the condition?                          | Go to <b>Step 11</b> | Go to <b>Step 9</b>  |
| 8  | Inspect for poor connections at the harness connector of the appropriate door ajar switch. Refer to <b><u>Testing for Intermittent Conditions and Poor Connections</u></b> and <b><u>Connector Repairs</u></b> .<br>Did you find and correct the condition? | Go to <b>Step 11</b> | Go to <b>Step 10</b> |
| 9  | Replace the BCM. Refer to <b><u>Control Module References</u></b> for replacement, setup and programming.<br>Did you complete the replacement?  | Go to <b>Step 11</b> | -                    |
| 10 | Replace the appropriate door ajar switch.<br>Did you complete the replacement?  | Go to <b>Step 11</b> | -                    |
| 11 | Operate the system in order to verify the repair.<br>Did you correct the condition?   | System OK            | Go to <b>Step 2</b>  |

**DOOR AJAR INDICATOR MALFUNCTION**

**Door Ajar Indicator Malfunction**

| Step  | Action   | Yes  | No  |
|---|--|--|---|
| <b>Schematic Reference: <u>Interior Lights Schematics</u></b><br><b>Connector End View Reference: <u>Vehicle Access Connector End Views</u></b> |  |  |   |
| 1   | Did you perform the Diagnostic System Check - Vehicle?   | Go to <b>Step 2</b>  | Go to <b><u>Diagnostic System Check - Vehicle</u></b> |
| 2   | Verify that the door ajar indicator is malfunctioning.<br>Does the door ajar indicator operate normally? | Go to <b><u>Testing for Intermittent Conditions and Poor</u></b> |   |



## 2007 Hummer H3

### 2007 ACCESSORIES & EQUIPMENT Vehicle Access - H3

|   |  | <u>Connections</u>   | Go to <b>Step 3</b>  |
|---|--|----------------------|----------------------|
| 3 | Is the door ajar indicator ON all the time?  | Go to <b>Step 4</b>  | Go to <b>Step 8</b>  |
| 4 | <ol style="list-style-type: none"> <li>1. Install a scan tool.</li> <li>2. Close all of the doors.</li> <li>3. Turn ON the ignition, with the engine OFF.</li> <li>4. With a scan tool, observe the Driver Door Ajar Sw. and the Passenger Door Ajar Sw. parameters in the body control module (BCM) data list.</li> </ol> <p>Does the scan tool display Door Ajar for either of the parameters?</p> | Go to <b>Step 5</b>  | Go to <b>Step 19</b> |
| 5 | Is the Driver Door Ajar sw. parameter displaying Door Ajar?  | Go to <b>Step 6</b>  | Go to <b>Step 7</b>  |
| 6 | <ol style="list-style-type: none"> <li>1. With a scan tool, observe the Driver Door Ajar Sw. parameter in the BCM data list.</li> <li>2. Disconnect the driver ajar switch assembly harness connector.</li> </ol> <p>Does the scan tool display Door Closed?</p>   | Go to <b>Step 20</b> | Go to <b>Step 15</b> |
| 7 | <ol style="list-style-type: none"> <li>1. With a scan tool, observe the Passenger Door Ajar Sw. parameter in the BCM data list.</li> <li>2. Disconnect each of the passenger ajar switch assembly harness connectors, one at a time.</li> </ol> <p>Does the scan tool display Door Closed when any of the harness connectors is disconnected?</p>  | Go to <b>Step 20</b> | Go to <b>Step 16</b> |
| 8 | Is the door ajar indicator inoperative from the driver door?   | Go to <b>Step 9</b>  | Go to <b>Step 12</b> |
|   | <ol style="list-style-type: none"> <li>1. Install a scan tool.</li> <li>2. Turn ON the ignition, with the engine</li> </ol>  |                      |                      |

**2007 Hummer H3**

2007 ACCESSORIES & EQUIPMENT Vehicle Access - H3

|    |  |                      |                      |
|----|--|----------------------|----------------------|
| 9  | <p>OFF.</p> <ol style="list-style-type: none"> <li>3. Disconnect the driver ajar switch assembly harness connector.</li> <li>4. Connect a 3-amp fused jumper wire between the left front door ajar switch signal circuit of the driver ajar switch assembly harness connector and a good ground.</li> <li>5. With a scan tool, observe the Driver Door Ajar Sw. parameter in the BCM data list.</li> </ol> |                      |                      |
|    | Does the scan tool display Door Ajar?  | Go to <b>Step 10</b> | Go to <b>Step 17</b> |
| 10 | Is the door ajar indicator illuminated?  | Go to <b>Step 11</b> | Go to <b>Step 19</b> |
| 11 | <ol style="list-style-type: none"> <li>1. Connect a 3-amp fused jumper wire between the left front door ajar switch signal circuit of the driver ajar switch assembly harness connector and the ground circuit of the driver ajar switch assembly harness connector.</li> <li>2. With a scan tool, observe the Driver Door Ajar Sw. parameter in the BCM data list.</li> </ol>                             |                      |                      |
|    | Does the scan tool display Door Ajar?  | Go to <b>Step 20</b> | Go to <b>Step 22</b> |
| 12 | <ol style="list-style-type: none"> <li>1. Install a scan tool.</li> <li>2. Turn ON the ignition, with the engine OFF.</li> <li>3. Disconnect the appropriate passenger ajar switch assembly harness connector.</li> <li>4. Connect a 3-amp fused jumper wire between the door ajar switch signal circuit of the appropriate passenger ajar switch assembly harness connector and a good ground.</li> </ol> |                      |                      |

**2007 Hummer H3**

2007 ACCESSORIES & EQUIPMENT Vehicle Access - H3

|    |   |                      |                      |
|----|---|----------------------|----------------------|
|    | <p>5. With a scan tool, observe the Passenger Door Ajar Sw. parameter in the BCM data list.</p>   |                      |                      |
|    | Does the scan tool display Door Ajar?   | Go to <b>Step 13</b> | Go to <b>Step 18</b> |
| 13 | Is the door ajar indicator illuminated?   | Go to <b>Step 14</b> | Go to <b>Step 19</b> |
| 14 | <p>1. Connect a 3-amp fused jumper wire between the door ajar switch signal circuit of the appropriate passenger ajar switch assembly harness connector and the ground circuit of the appropriate passenger ajar switch assembly harness connector.</p> <p>2. With a scan tool, observe the Passenger Door Ajar Sw. parameter in the BCM data list.</p> |                      |                      |
|    | Does the scan tool display Door Ajar?   | Go to <b>Step 20</b> | Go to <b>Step 22</b> |
| 15 | <p>Test the left front door ajar switch signal circuit for a short to ground. Refer to <b><u>Circuit Testing</u></b> and <b><u>Wiring Repairs</u></b> .</p> <p>Did you find and correct the condition?</p>  | Go to <b>Step 26</b> | Go to <b>Step 21</b> |
| 16 | <p>Test the appropriate door ajar switch signal circuit for a short to ground. Refer to <b><u>Circuit Testing</u></b> and <b><u>Wiring Repairs</u></b> .</p> <p>Did you find and correct the condition?</p>   | Go to <b>Step 26</b> | Go to <b>Step 21</b> |
| 17 | <p>Test the left front door ajar switch signal circuit for an open. Refer to <b><u>Circuit Testing</u></b> and <b><u>Wiring Repairs</u></b> .</p> <p>Did you find and correct the condition?</p>  | Go to <b>Step 26</b> | Go to <b>Step 21</b> |
| 18 | <p>Test the appropriate door ajar switch signal circuit for an open. Refer to <b><u>Circuit Testing</u></b> and <b><u>Wiring Repairs</u></b> .</p> <p>Did you find and correct the condition?</p>   | Go to <b>Step 26</b> | Go to <b>Step 21</b> |
| 19 | <p>Inspect for poor connections at the harness connector of the instrument panel cluster (IPC). Refer to <b><u>Testing for Intermittent Conditions and Poor Connections</u></b> and</p>   |                      |                      |

**2007 Hummer H3**

2007 ACCESSORIES & EQUIPMENT Vehicle Access - H3

|    |   |                      |                      |
|----|---|----------------------|----------------------|
|    | <b><u>Connector Repairs</u></b> .<br>Did you find and correct the condition?  | Go to <b>Step 26</b> | Go to <b>Step 23</b> |
| 20 | Inspect for poor connections at the harness connector of the appropriate door ajar switch. Refer to <b><u>Testing for Intermittent Conditions and Poor Connections</u></b> and <b><u>Connector Repairs</u></b> .<br>Did you find and correct the condition? | Go to <b>Step 26</b> | Go to <b>Step 24</b> |
| 21 | Inspect for poor connections at the harness connector of the BCM. Refer to <b><u>Testing for Intermittent Conditions and Poor Connections</u></b> and <b><u>Connector Repairs</u></b> .<br>Did you find and correct the condition?                          | Go to <b>Step 26</b> | Go to <b>Step 25</b> |
| 22 | Repair the open in the appropriate ground circuit. Refer to <b><u>Wiring Repairs</u></b> and <b><u>Connector Repairs</u></b> .<br>Did you find and correct the condition?   | Go to <b>Step 26</b> | -                    |
| 23 | Replace the IPC. Refer to <b><u>Control Module References</u></b> for replacement, setup and programming.<br>Did you complete the replacement?  | Go to <b>Step 26</b> | -                    |
| 24 | Replace the appropriate ajar switch assembly.<br>Did you complete the replacement?  | Go to <b>Step 26</b> | -                    |
| 25 | Replace the BCM. Refer to <b><u>Control Module References</u></b> for replacement, setup and programming.<br>Did you complete the replacement?  | Go to <b>Step 26</b> | -                    |
| 26 | Operate the system in order to verify the repair.<br>Did you correct the condition?   | System OK            | Go to <b>Step 2</b>  |

**POWER DOOR LOCKS INOPERATIVE**

**Power Door Locks Inoperative**

| Step   | Action | Yes | No |
|--|--------|-----|----|
| <b>Schematic Reference: <u>Door Lock/Indicator Schematics</u></b>              |        |     |    |
| <b>Connector End View Reference: <u>Vehicle Access Connector End Views</u></b> |        |     |    |
|  |        |     |    |

**2007 Hummer H3**

2007 ACCESSORIES & EQUIPMENT Vehicle Access - H3

|    |   |  |   |
|----|---|--|---|
| 1  | Did you perform the Diagnostic System Check - Vehicle?  | Go to <b>Step 2</b>  | Go to <b><u>Diagnostic System Check - Vehicle</u></b> |
| 2  | Verify that the power door locks are inoperative.<br>Do the power door locks operate normally?  | Go to <b><u>Testing for Intermittent Conditions and Poor Connections</u></b> | Go to <b>Step 3</b>                                   |
| 3  | Are the power door locks and the driver power window inoperative?   | Go to <b>Step 7</b>  | Go to <b>Step 4</b>                                   |
| 4  | Are the power door locks inoperative from a single door lock switch?  | Go to <b>Step 5</b>  | Go to <b>Step 6</b>                                   |
| 5  | Is the driver door lock switch the inoperative switch?  | Go to <b>Step 8</b>  | Go to <b>Step 9</b>                                   |
| 6  | Is the driver door lock actuator the inoperative actuator?  | Go to <b>Step 10</b>   | Go to <b>Step 11</b>                                  |
| 7  | Test the battery positive voltage circuit of the drivers switch assembly for a short to ground or an open. Refer to <b><u>Circuit Testing</u></b> and <b><u>Wiring Repairs</u></b> .<br>Did you find and correct the condition? | Go to <b>Step 21</b>   | Go to <b>Step 8</b>                                   |
| 8  | Test the ground circuit of the drivers switch assembly for an open. Refer to <b><u>Circuit Testing</u></b> and <b><u>Wiring Repairs</u></b> .<br>Did you find and correct the condition?  | Go to <b>Step 21</b>   | Go to <b>Step 13</b>                                  |
| 9  | Test the passenger door lock switch control circuits for an open. Refer to <b><u>Circuit Testing</u></b> and <b><u>Wiring Repairs</u></b> .<br>Did you find and correct the condition?  | Go to <b>Step 21</b>   | Go to <b>Step 12</b>                                  |
| 10 | Test the driver door lock actuator unlock control circuit for an open. Refer to <b><u>Circuit Testing</u></b> and <b><u>Wiring Repairs</u></b> .<br>Did you find and correct the condition?                                     | Go to <b>Step 21</b>   | Go to <b>Step 14</b>                                  |
| 11 | Test the door lock actuator control circuits for an open. Refer to <b><u>Circuit Testing</u></b> and <b><u>Wiring Repairs</u></b> .<br>Did you find and correct the condition?  | Go to <b>Step 21</b>   | Go to <b>Step 15</b>                                  |

**2007 Hummer H3**

2007 ACCESSORIES & EQUIPMENT Vehicle Access - H3

|    |  |                      |                      |
|----|--|----------------------|----------------------|
| 12 | <p>Test the passenger door lock switch ground circuit for an open. Refer to <b><u>Circuit Testing</u></b> and <b><u>Wiring Repairs</u></b> .</p> <p>Did you find and correct the condition?</p>  | Go to <b>Step 21</b> | Go to <b>Step 16</b> |
| 13 | <p>Inspect for poor connections at the harness connector of the drivers switch assembly. Refer to <b><u>Testing for Intermittent Conditions and Poor Connections</u></b> and <b><u>Connector Repairs</u></b> .</p> <p>Did you find and correct the condition?</p>                  | Go to <b>Step 21</b> | Go to <b>Step 17</b> |
| 14 | <p>Inspect for poor connections at the harness connector of the driver door lock actuator. Refer to <b><u>Testing for Intermittent Conditions and Poor Connections</u></b> and <b><u>Connector Repairs</u></b> .</p> <p>Did you find and correct the condition?</p>                | Go to <b>Step 21</b> | Go to <b>Step 18</b> |
| 15 | <p>Inspect for poor connections at the harness connector of the appropriate passenger door lock actuator. Refer to <b><u>Testing for Intermittent Conditions and Poor Connections</u></b> and <b><u>Connector Repairs</u></b> .</p> <p>Did you find and correct the condition?</p> | Go to <b>Step 21</b> | Go to <b>Step 19</b> |
| 16 | <p>Inspect for poor connections at the harness connector of the passenger door lock switch. Refer to <b><u>Testing for Intermittent Conditions and Poor Connections</u></b> and <b><u>Connector Repairs</u></b> .</p> <p>Did you find and correct the condition?</p>               | Go to <b>Step 21</b> | Go to <b>Step 20</b> |
| 17 | <p>Replace the driver switch assembly. Refer to <b><u>Door Lock and Side Window Switch Replacement - Driver Side (1st Design)</u></b> or <b><u>Door Lock and Side Window Switch Replacement - Driver Side (2nd Design)</u></b>.</p> <p>Did you complete the repair?</p>            | Go to <b>Step 21</b> | -                    |
| 18 | <p>Replace the driver door lock actuator. Refer to <b><u>Front Side Door Lock Replacement</u></b>.</p>   |                      |                      |

## 2007 Hummer H3

2007 ACCESSORIES & EQUIPMENT Vehicle Access - H3

|    |   |                      |                     |
|----|---|----------------------|---------------------|
|    | Did you complete the repair?  | Go to <b>Step 21</b> | -                   |
| 19 | Replace the appropriate passenger door lock actuator. Refer to <b><u>Front Side Door Lock Replacement</u></b> or <b><u>Rear Door Lock Replacement</u></b> .<br>Did you complete the repair? | Go to <b>Step 21</b> | -                   |
| 20 | Replace the passenger door lock switch. Refer to <b><u>Door Lock and Side Window Switch Replacement - Passenger Side</u></b> .<br>Did you complete the repair?                              | Go to <b>Step 21</b> | -                   |
| 21 | Operate the system in order to verify the repair.<br>Did you find and correct the condition?  | System OK            | Go to <b>Step 2</b> |

## REPAIR INSTRUCTIONS

### LOCK CYLINDER BINDING

In many cases, applying the proper lubrication can correct the following conditions:

- Binding or sticking door lock cylinders
- Difficulty in inserting and removing the keys

For lubricating the above components, use lubricant GM P/N 12346241 or equivalent

Do not use penetrating lubricants such as GM P/N 1052949 or WD-40®. Penetrating lubricants wash out the original lubrication. Penetrating lubricants eventually evaporate, leaving little or no lubricating material. However, when using penetrating lubricants in order to thaw or in order to loosen the lock cylinder components, refer to steps 2-4 in the procedure below for the proper methods of lubrication.

Repair lock cylinders frozen in cold weather by using the following procedure:

1. While carefully avoiding damage to the painted surfaces, apply heat to the cylinder with a heat gun.
2. Using a paper clip or a similar item, hold the door shutter open.

Force air into the cylinders using compressed air through a blow gun attachment.

3. While holding the shutter door open, inject small amounts of a recommended lubricant into

the cylinder.

4. Work the key into the cylinder repeatedly.

Wipe away any excess lubrication from the key.

## DOOR LOCK CYLINDER REPLACEMENT

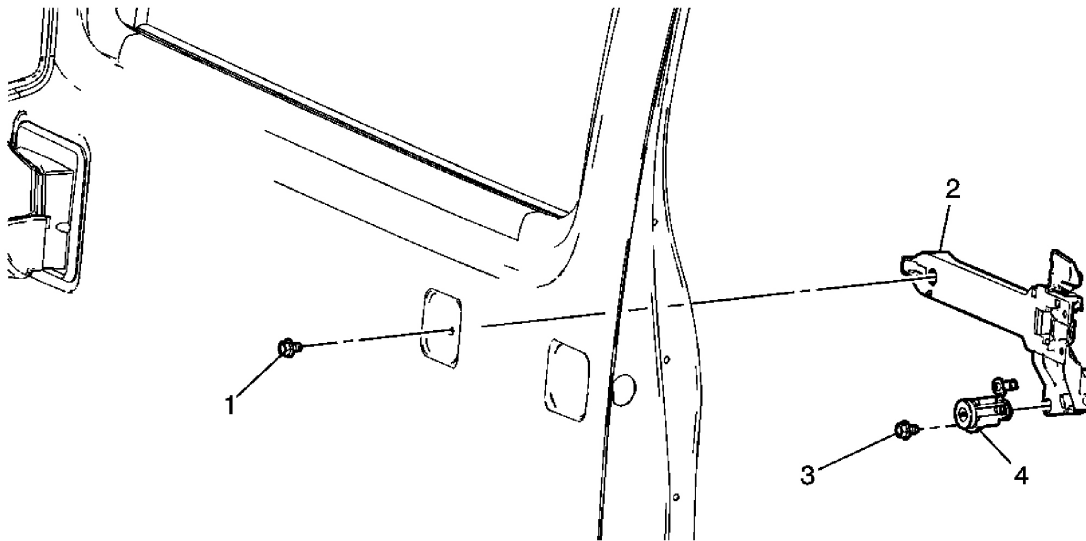

**Fig. 16: Lock Cylinder Replacement - Door**  
 Courtesy of GENERAL MOTORS CORP.

### Door Lock Cylinder Replacement

| Callout  | Component Name |
|--|----------------|
| <p><b>NOTE:</b><br/>                     Refer to <u>Fastener Notice</u> .</p>                         |                |
| <p><b>Fastener Tightening Specifications:</b> Refer to <u>Fastener Tightening Specifications</u> .</p> |                |
| <p><b>Preliminary Procedures</b></p>   |                |
| <p>1. Remove the interior trim panel. Refer to <u>Front Side Door Trim Panel Replacement</u> .</p>     |                |
| <p>2. Remove the water deflector. Refer to <u>Front Side Door Water Deflector Replacement</u> .</p>    |                |
| <p>3. Remove the outside door handle. Refer to <u>Front Side Door Outside Handle Replacement</u> .</p> |                |



2007 Hummer H3

2007 ACCESSORIES & EQUIPMENT Vehicle Access - H3

|   |  |
|---|--|
| 1 | Bolt, Front Side Door Lock Housing<br><b>Tighten:</b> 7 N.m (62 lb in)                               |
| 2 | Housing, Front Door Handle<br><b>Tip:</b> Disconnect the lock and handle rods to remove the housing. |
| 3 | Bolt, Front Side Door Lock Cylinder<br><b>Tighten:</b> 7 N.m (62 lb in)                              |
| 4 | Lock Cylinder, Front Side Door   |

**ENDGATE HANDLE REPLACEMENT**

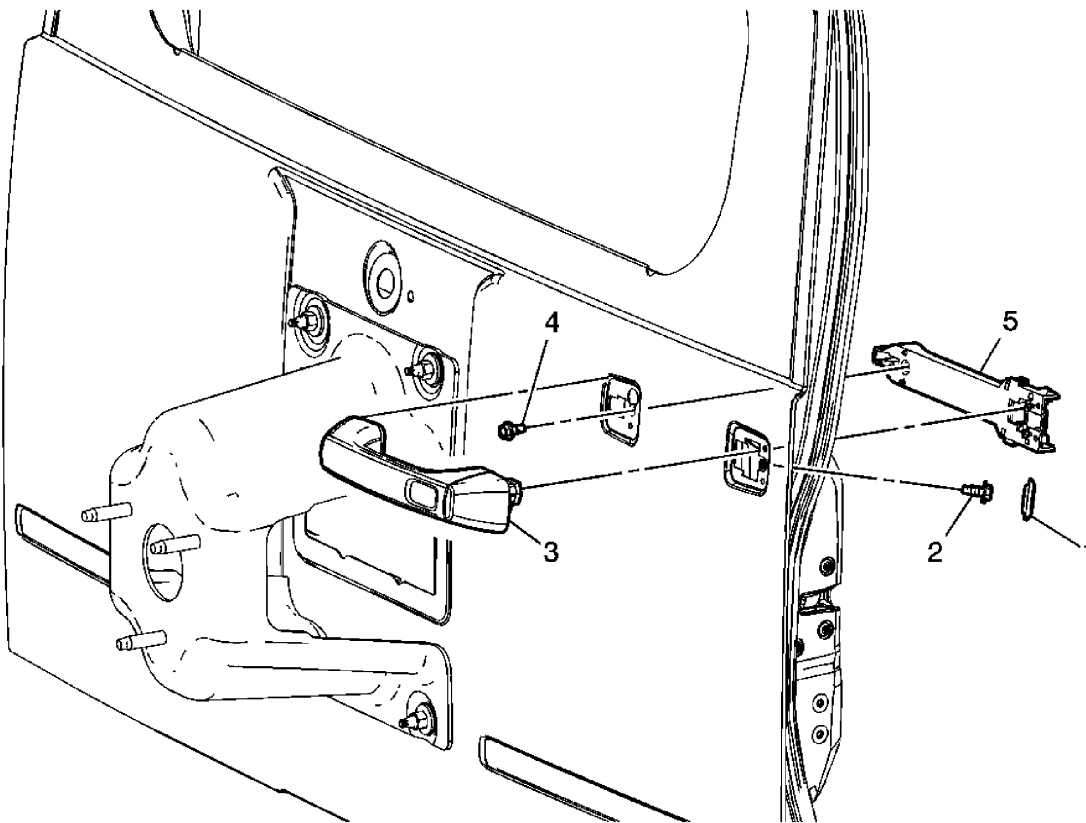

**Fig. 17: Handle Replacement - Endgate**  
 Courtesy of GENERAL MOTORS CORP.

**Endgate Handle Replacement**

| Callout      | Component Name |
|--------------|----------------|
| <b>NOTE:</b> |                |

Refer to **Fastener Notice** .

**Fastener Tightening Specifications:** Refer to **Fastener Tightening Specifications**. **Preliminary Procedures:** Remove the lower endgate trim panel. Refer to **Endgate Trim Panel Replacement** .

|   |   |
|---|---|
| 1 | Cap, Bolt Cover   |
| 2 | Bolt, Endgate Outside Handle<br><b>Tighten:</b> 9 N.m (80 lb in)        |
| 3 | Handle, Endgate Outside Handle  |
| 4 | Bolt, Handle Carrier<br><b>Tighten:</b> 9 N.m (80 lb in)                |
| 5 | Carrier, Endgate Outside Handle<br><b>Tip:</b> Disconnect the lock rod. |

**FRONT SIDE DOOR INSIDE HANDLE REPLACEMENT**

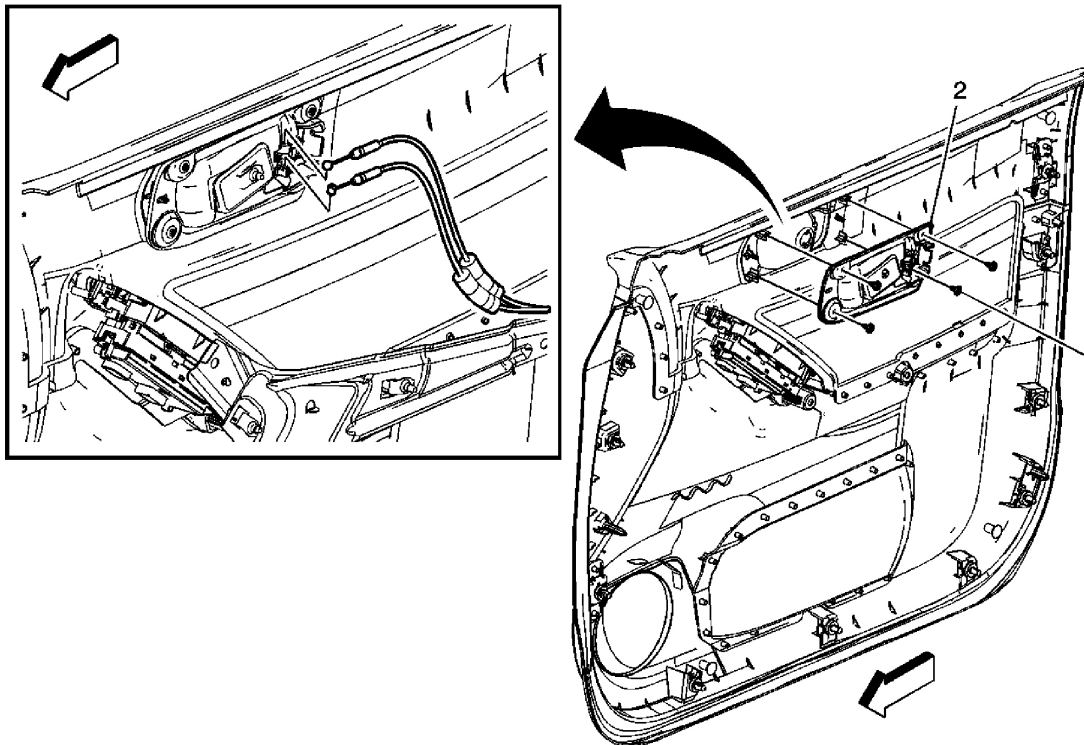
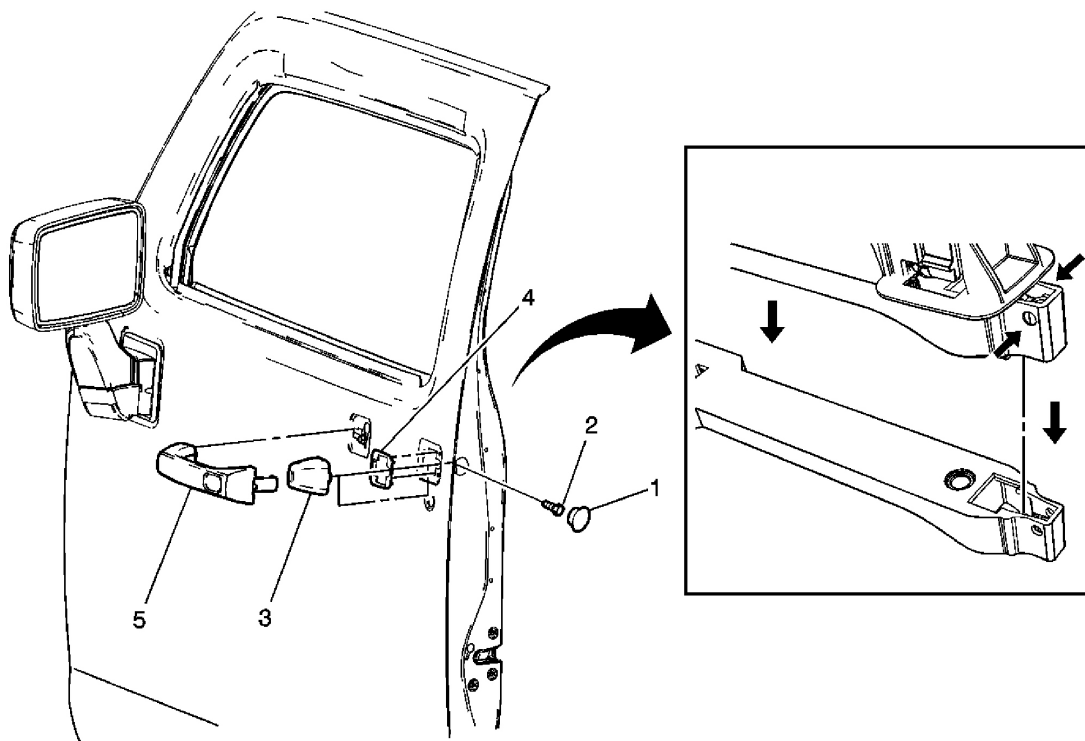

**Fig. 18: View Of Front Side Door Inside Handle**  
 Courtesy of GENERAL MOTORS CORP.

**Front Side Door Inside Handle Replacement**

| Callout  | Component Name   |
|--|--|
| <b>Preliminary Procedure:</b><br>Remove side door trim panel. Refer to <b>Front Side Door Trim Panel Replacement</b> . |  |
| 1  | Inside Door Handle Screw (Qty: 4)<br><br><b>NOTE:</b><br>Refer to <b>Fastener Notice</b> .<br><br><b>Tighten:</b> 2 N.m (18 lb in) |
| 2  | Inside Door Handle Assembly  |

**FRONT SIDE DOOR OUTSIDE HANDLE REPLACEMENT**



**Fig. 19: Door Handle Replacement - Front Outside**  
Courtesy of GENERAL MOTORS CORP.

**Front Side Door Outside Handle Replacement**

| Callout                       | Component Name |
|-------------------------------|----------------|
| <b>Preliminary Procedures</b> |                |

## 2007 Hummer H3

### 2007 ACCESSORIES & EQUIPMENT Vehicle Access - H3

1. Remove the trim panel. Refer to **Front Side Door Trim Panel Replacement** .
2. Reposition the window regulator from the door handle. Refer to **Rear Side Door Window Module Replacement** .

|   |   |
|---|---|
| 1 | Bolt Access Plug<br><b>Tip:</b> Use a plastic flat-bladed tool to remove.   |
| 2 | Front Side Door Outside Handle Bolt<br><br><b>NOTE:</b><br>Refer to <b><u>Fastener Notice</u></b> .<br><br><b>Tighten:</b> 9 N.m (80 lb in)                       |
| 3 | Front Door Outside Handle Cap   |
| 4 | Front Door Outside Handle Cap Gasket  |
| 5 | Front Door Outside Handle<br><b>Tip:</b> With small flat-blade screwdrivers, pry the walls out from the buttons on the handle. Pull handle rearward to disengage. |

### REAR SIDE DOOR INSIDE HANDLE REPLACEMENT

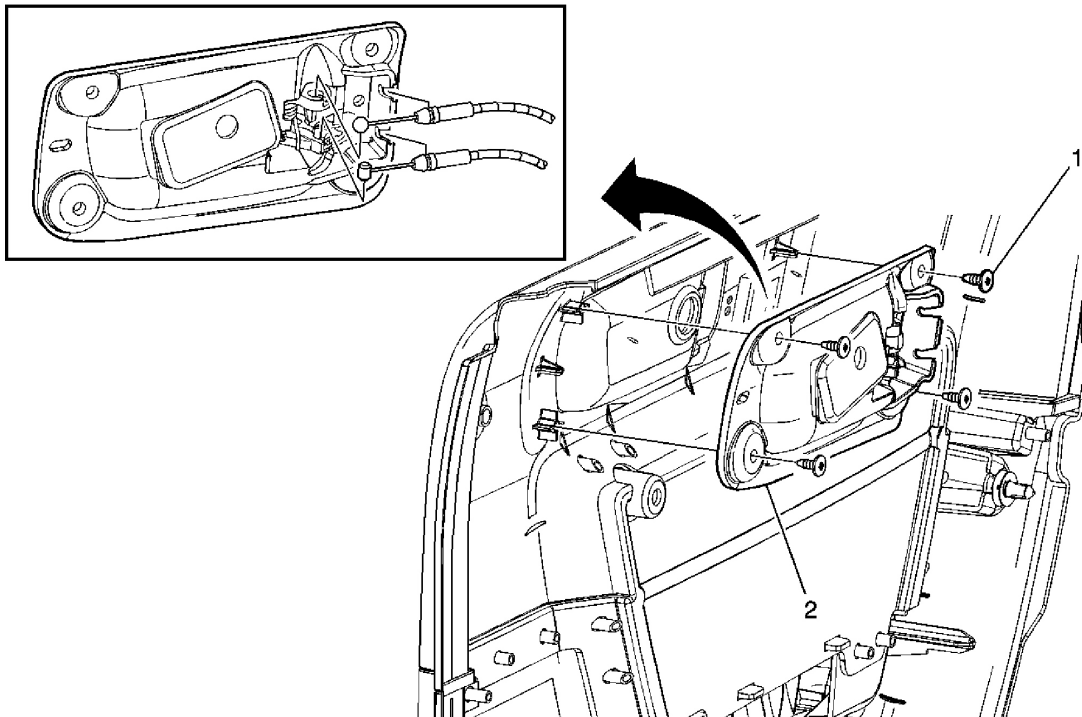

**Fig. 20: Door Handle Replacement - Rear Inside**

Courtesy of GENERAL MOTORS CORP.

**Rear Side Door Inside Handle Replacement**

| Callout   | Component Name   |
|---|--|
| <p><b>NOTE:</b><br/>Refer to <u>Fastener Notice</u> .</p>   |  |
| <p><b>Fastener Tightening Specifications:</b> Refer to <u>Fastener Tightening Specifications</u> .<br/><b>Preliminary Procedure:</b> Remove side door trim panel. Refer to <u>Rear Side Door Trim Panel Replacement</u> .</p> |  |
| 1   | <p>Screw, Inside Door Handle (Qty: 4)<br/><b>Tighten:</b> 2 N.m (18 lb in)</p> |
| 2   | <p>Handle Assembly, Inside Door</p>  |

**REAR SIDE DOOR OUTSIDE HANDLE REPLACEMENT**

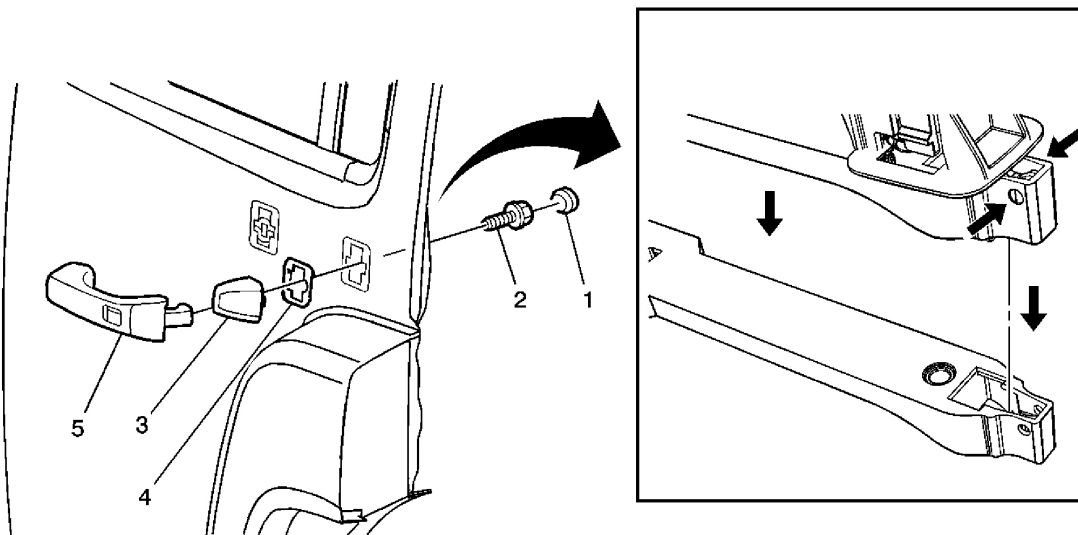

**Fig. 21: Door Handle Replacement - Rear Outside**  
Courtesy of GENERAL MOTORS CORP.

**Rear Side Door Outside Handle Replacement**

| Callout   | Component Name |
|---|----------------|
| <p><b>Preliminary Procedures</b></p> <p>1. Remove the trim panel. Refer to <u>Rear Side Door Trim Panel Replacement</u> .</p> |                |

2007 Hummer H3

2007 ACCESSORIES & EQUIPMENT Vehicle Access - H3

2. Reposition the window regulator from the door handle. Refer to **Rear Side Door Window Module Replacement** .

|   |  |
|---|--|
| 1 | Bolt Access Plug<br><b>Tip:</b> Use a plastic flat-bladed tool to remove.  |
| 2 | Rear Side Door Outside Handle Bolt<br><br><b>NOTE:</b><br>Refer to <b><u>Fastener Notice</u></b> .<br><br><b>Tighten:</b> 9 N.m (80 lb in)                       |
| 3 | Rear Door Outside Handle Cap   |
| 4 | Rear Door Outside Handle Cap Gasket  |
| 5 | Rear Door Outside Handle<br><b>Tip:</b> With small flat-blade screwdrivers, pry the walls out from the buttons on the handle. Pull handle rearward to disengage. |

**REAR SIDE DOOR OUTSIDE HANDLE HOUSING REPLACEMENT**



**Fig. 22: Rear Side Door Outside Handle Housing Replacement**  
Courtesy of GENERAL MOTORS CORP.

**Rear Side Door Outside Handle Housing Replacement**

| Callout  | Component Name |
|--|----------------|
| <b>NOTE:</b><br>Refer to <b><u>Fastener Notice</u></b> . |                |

**Fastener Tightening Specifications:** Refer to **Fastener Tightening Specifications** .

### **Preliminary Procedures**

1. Remove the interior trim panel. Refer to **Rear Side Door Trim Panel Replacement** .
2. Remove the water deflector. Refer to **Rear Side Door Water Deflector Replacement** .
3. Remove the outside door handle. Refer to **Rear Side Door Outside Handle Replacement**.

|   |  |
|---|--|
| 1 | Bolt, Rear Side Door Outside Handle Housing<br><b>Tighten:</b> 7 N.m (62 lb in)                                      |
| 2 | Housing, Rear Side Door Outside Handle<br><b>Tip:</b> Disconnect the handle rod to remove the housing form the door. |

### **ENDGATE LATCH REPLACEMENT**

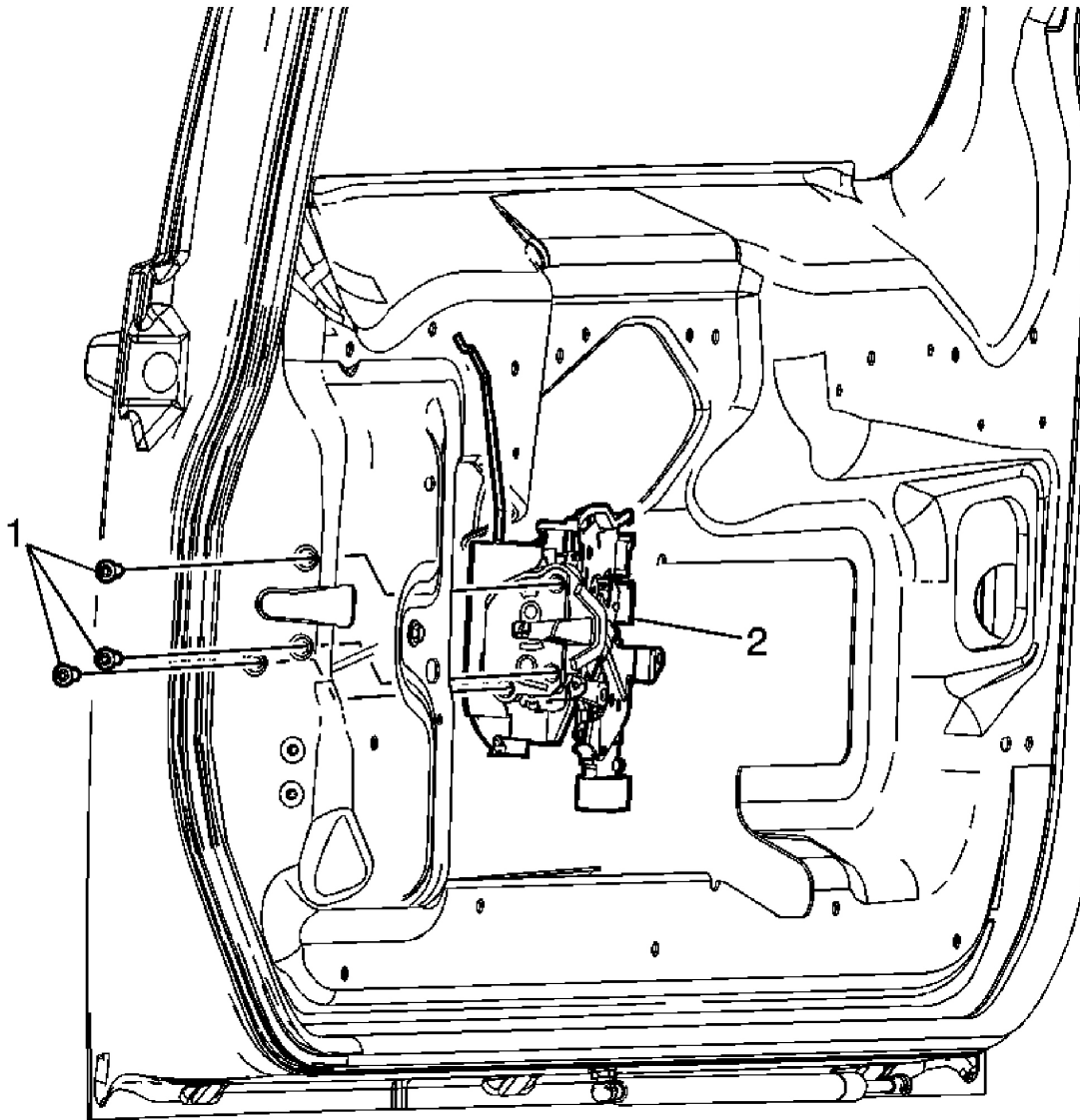

**Fig. 23: Latch Replacement - Endgate**  
 Courtesy of GENERAL MOTORS CORP.

**Endgate Latch Replacement**

| Callout   | Component Name |
|---|----------------|
| <p><b>NOTE:</b><br/>                     Refer to <u>Fastener Notice</u> .</p> <p><b>Fastener Tightening Specifications:</b> Refer to <u>Fastener Tightening Specifications</u>.<br/> <b>Preliminary Procedure:</b> Remove the endgate trim panel. Refer to <u>Endgate Trim Panel Replacement</u> .</p> |                |



2007 Hummer H3

2007 ACCESSORIES & EQUIPMENT Vehicle Access - H3

|   |  |
|---|--|
| 1 | Screws, Latch Assembly (Qty: 3)<br><b>Tighten:</b> 10 N.m (89 lb in) |
| 2 | Latch, Endgate<br><b>Tip:</b> Disconnect electrical connector.       |

**FRONT SIDE DOOR LOCK REPLACEMENT**

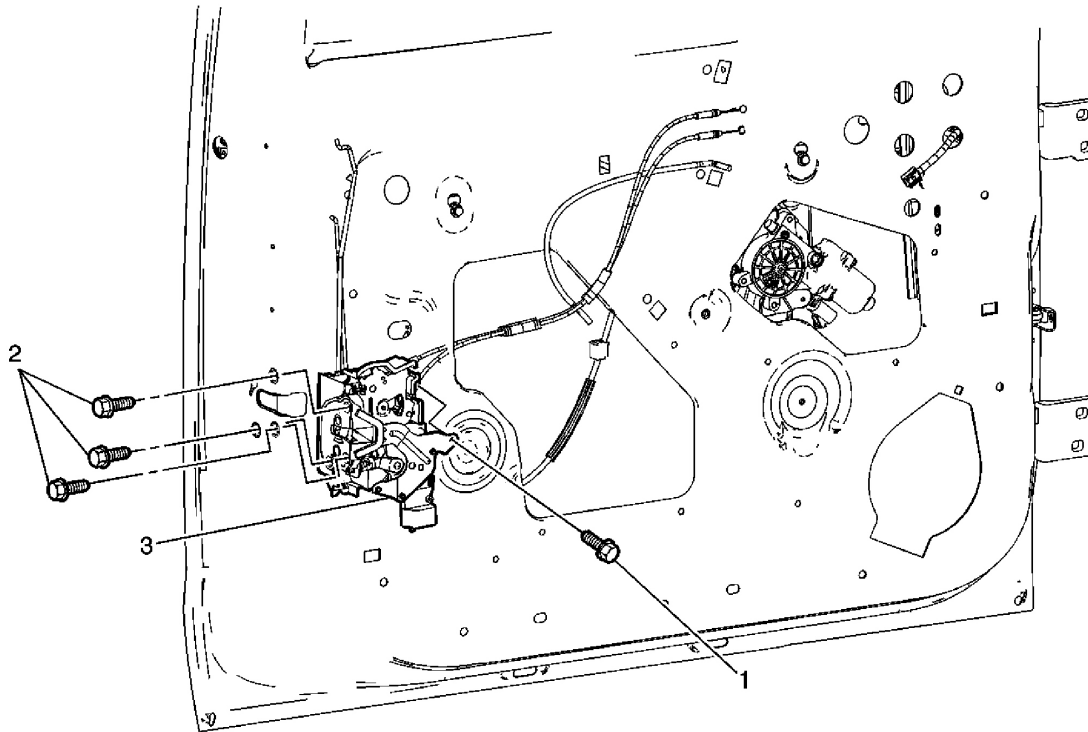

**Fig. 24: Lock Replacement - Front Door**  
Courtesy of GENERAL MOTORS CORP.

**Front Side Door Lock Replacement**

| Callout  | Component Name |
|--|----------------|
| <p><b>NOTE:</b><br/>Refer to <u>Fastener Notice</u> .</p>  |                |
| <p><b>Fastener Tightening Specifications:</b> Refer to <u>Fastener Tightening Specifications</u> .</p> |                |
| <p><b>Preliminary Procedures</b></p>   |                |
| <p>1. Remove the interior trim panel. Refer to <b>Front Side Door Trim Panel</b></p>                   |                |

## 2007 Hummer H3

2007 ACCESSORIES & EQUIPMENT Vehicle Access - H3

### Replacement .

2. Remove the water deflector. Refer to Front Side Door Water Deflector Replacement .

|   |  |
|---|--|
| 1 | Bolt, Front Side Door Lock<br><b>Tighten:</b> 7 N.m (62 lb in)   |
| 2 | Bolt, Front Side Door Lock (Qty: 3)<br><b>Tighten:</b> 7 N.m (62 lb in)  |
| 3 | Lock, Front Side Door<br><b>Tip:</b> <ul style="list-style-type: none"><li>• Disconnect the electrical connector.</li><li>• Disconnect the lock and handle rod to remove the lock from the door.</li></ul> |

### REAR DOOR LOCK REPLACEMENT

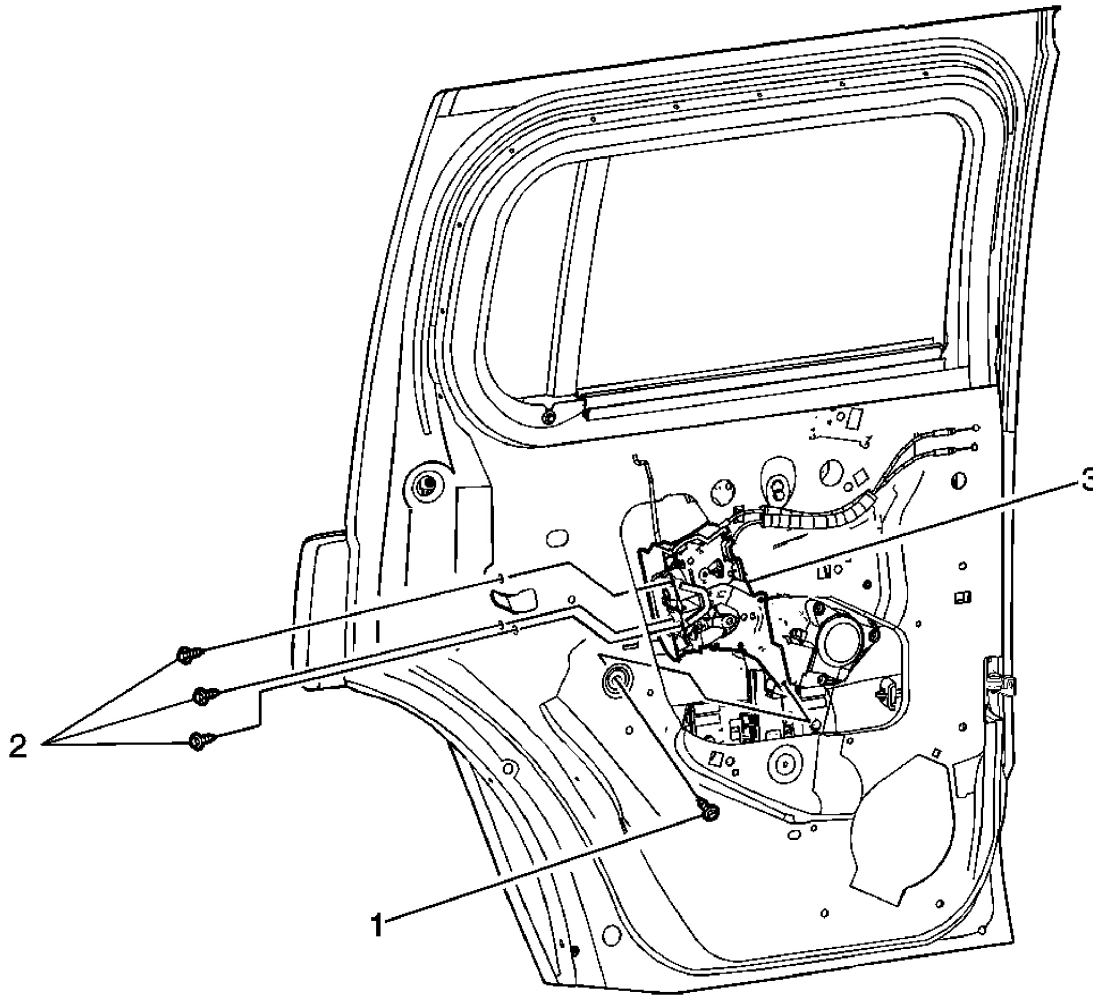

**Fig. 25: Lock Replacement - Rear Door**  
 Courtesy of GENERAL MOTORS CORP.

**Rear Door Lock Replacement**

| Callout  | Component Name |
|--|----------------|
| <p><b>NOTE:</b></p>  |                |
| <p>Refer to <u>Fastener Notice</u> .</p>   |                |
| <p><b>Fastener Tightening Specifications:</b> Refer to <u>Fastener Tightening Specifications</u> .</p> |                |
| <p><b>Preliminary Procedures</b></p>   |                |
| <p>1. Remove the interior trim panel. Refer to <u>Rear Side Door Trim Panel Replacement</u> .</p>      |                |

2. Remove the water deflector. Refer to **Rear Side Door Water Deflector Replacement** .

|   |   |
|---|---|
| 1 | Bolt, Rear Side Door Lock<br><b>Tighten:</b> 7 N.m (62 lb in)   |
| 2 | Bolt, Rear Side Door Lock (Qty: 3)<br><b>Tighten:</b> 7 N.m (62 lb in)  |
| 3 | Lock, Rear Side Door<br><b>Tip:</b> <ul style="list-style-type: none"> <li>• Disconnect the electrical connector.</li> <li>• Disconnect the handle rod to remove the lock from the door.</li> </ul> |

**FRONT SIDE DOOR OUTSIDE HANDLE HOUSING REPLACEMENT**

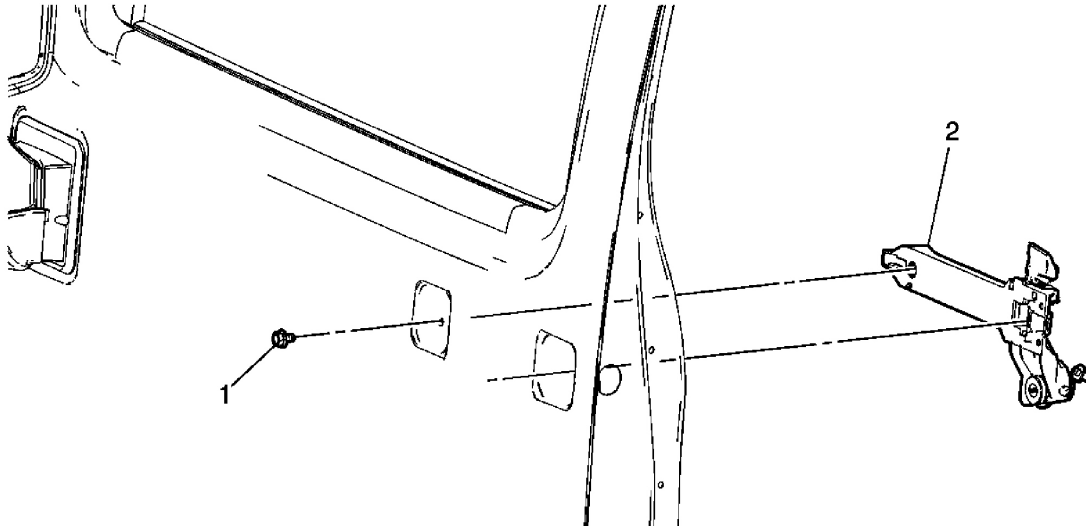

**Fig. 26: Front Side Door Outside Handle Housing Replacement**  
 Courtesy of GENERAL MOTORS CORP.

**Front Side Door Outside Handle Housing Replacement**

| Callout | Component Name |
|---------|----------------|
|---------|----------------|

**NOTE:**  
 Refer to **Fastener Notice** .

**Fastener Tightening Specifications:** Refer to **Fastener Tightening Specifications** .

**Preliminary Procedures**

1. Remove the interior trim panel. Refer to **Front Side Door Trim Panel Replacement** .
2. Remove the water deflector. Refer to **Front Side Door Water Deflector Replacement** .
3. Remove the outside door handle. Refer to **Front Side Door Outside Handle Replacement**.

|   |   |
|---|---|
| 1 | Bolt, Front Side Door Lock Housing<br><br><b>Tighten:</b> 7 N.m (62 lb in)  |
| 2 | Housing, Front Door Handle<br><b>Tip:</b> <ol style="list-style-type: none"> <li>1. Disconnect the lock and handle rods to remove the housing.</li> <li>2. Transfer the lock cylinder to the new housing. Refer to <b><u>Door Lock Cylinder Replacement</u></b>.</li> </ol> |

**DOOR LOCK STRIKER ADJUSTMENT**

**NOTE:** **Striker alignment is a crucial part of door latch operation. Do not use the door striker to adjust the door to the vehicle. Failure to properly adjust the striker can result in damage to the door latch and the striker.**

2007 Hummer H3

2007 ACCESSORIES & EQUIPMENT Vehicle Access - H3

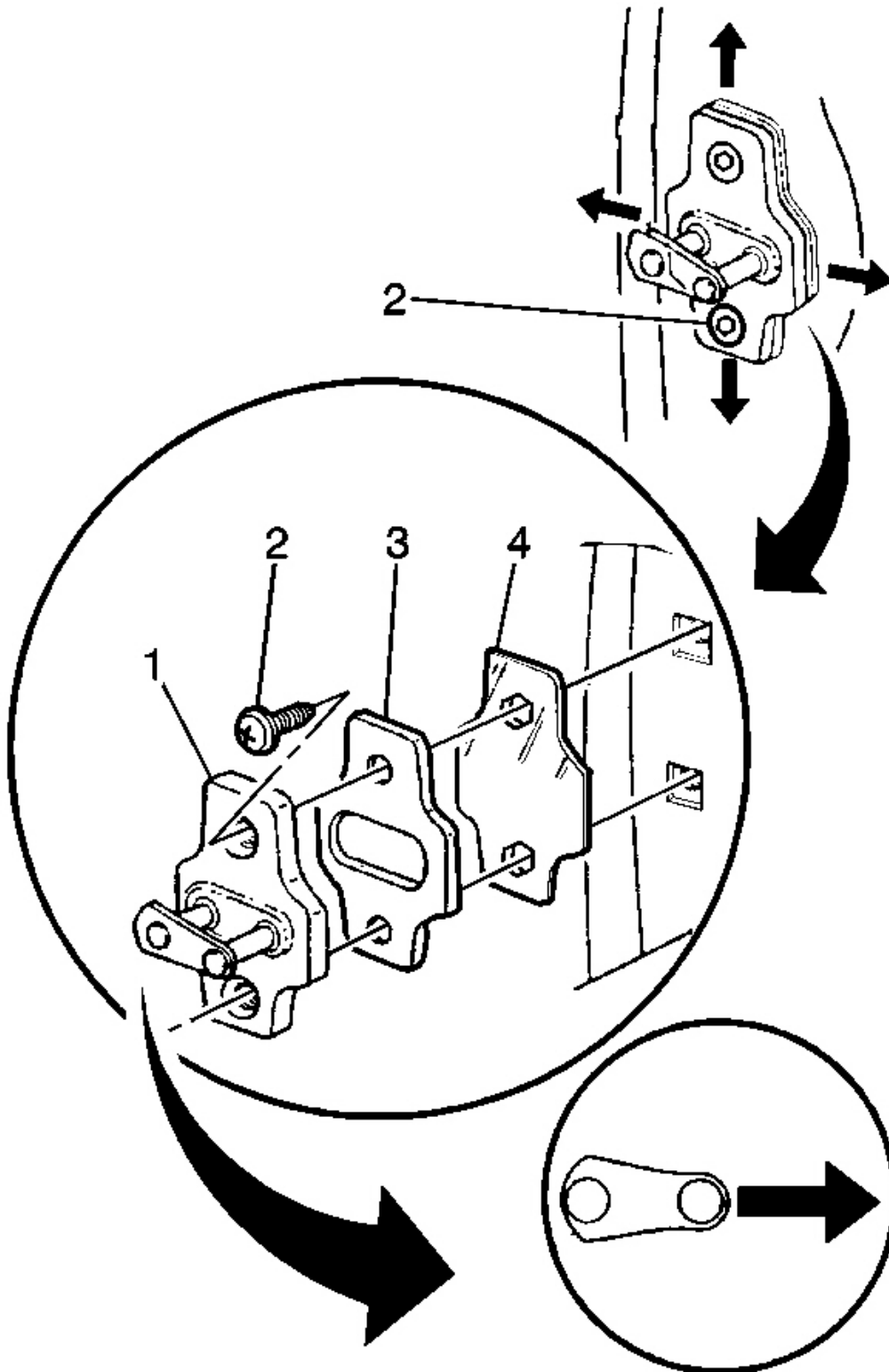

**Fig. 27: Exploded View Of Door Striker**  
Courtesy of GENERAL MOTORS CORP.

1. Loosen the striker bolts (2) until the striker is movable.
2. Pull on the outside handle.
3. Gently push the door against the body in order to ensure that the striker (1) allows a flush fit.
4. Slowly open the door.

**NOTE:** Refer to Fastener Notice .

5. Tighten the bolts (2).

**Tighten:** Tighten the striker bolts (2) to 25 N.m (18 lb ft).

6. Touch up any exposed or unpainted surface on the lock pillar.

**DOOR STRIKER REPLACEMENT**

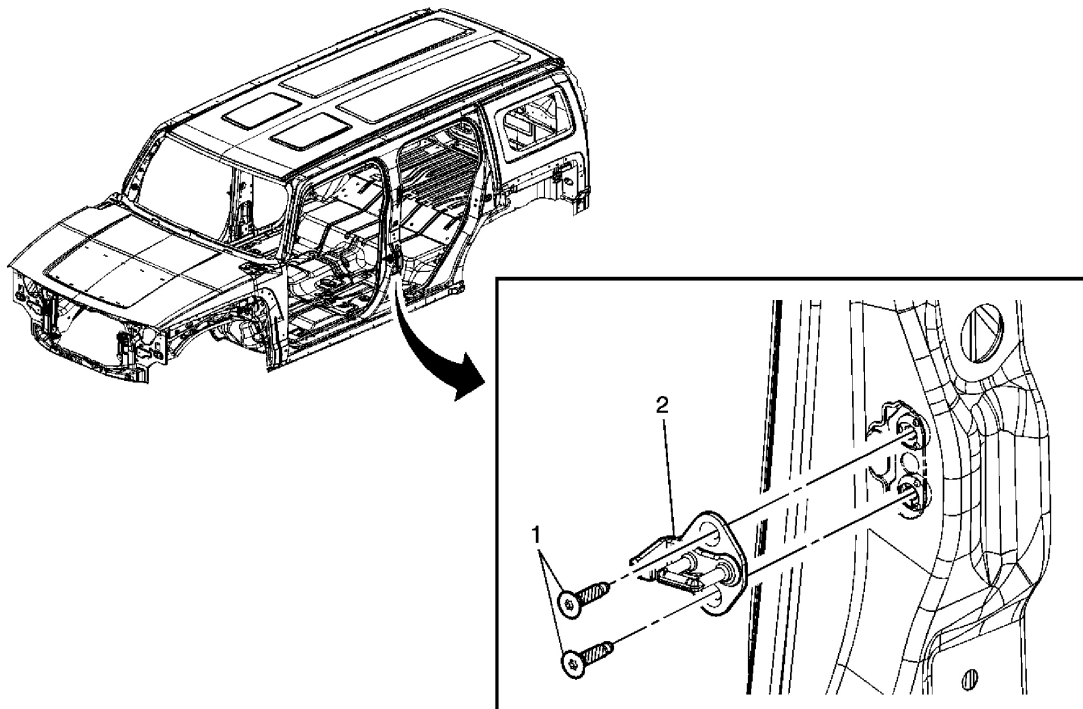

**Fig. 28: Striker Replacement - Door**  
Courtesy of GENERAL MOTORS CORP.

**2007 Hummer H3**

2007 ACCESSORIES & EQUIPMENT Vehicle Access - H3

**Door Striker Replacement**

| Callout  | Component Name  |
|--|---|
| <b>NOTE:</b><br>Refer to <u>Fastener Notice</u> .<br><br><b>Fastener Tightening Specifications:</b> Refer to <u>Fastener Tightening Specifications</u> . |   |
| 1  | Bolt, Door Lock/Latch Striker (Qty: 2)<br><b>Tighten:</b> 25 N.m (18 lb ft) |
| 2  | Striker, Door Lock/Latch  |

**ENDGATE LOCK STRIKER REPLACEMENT**



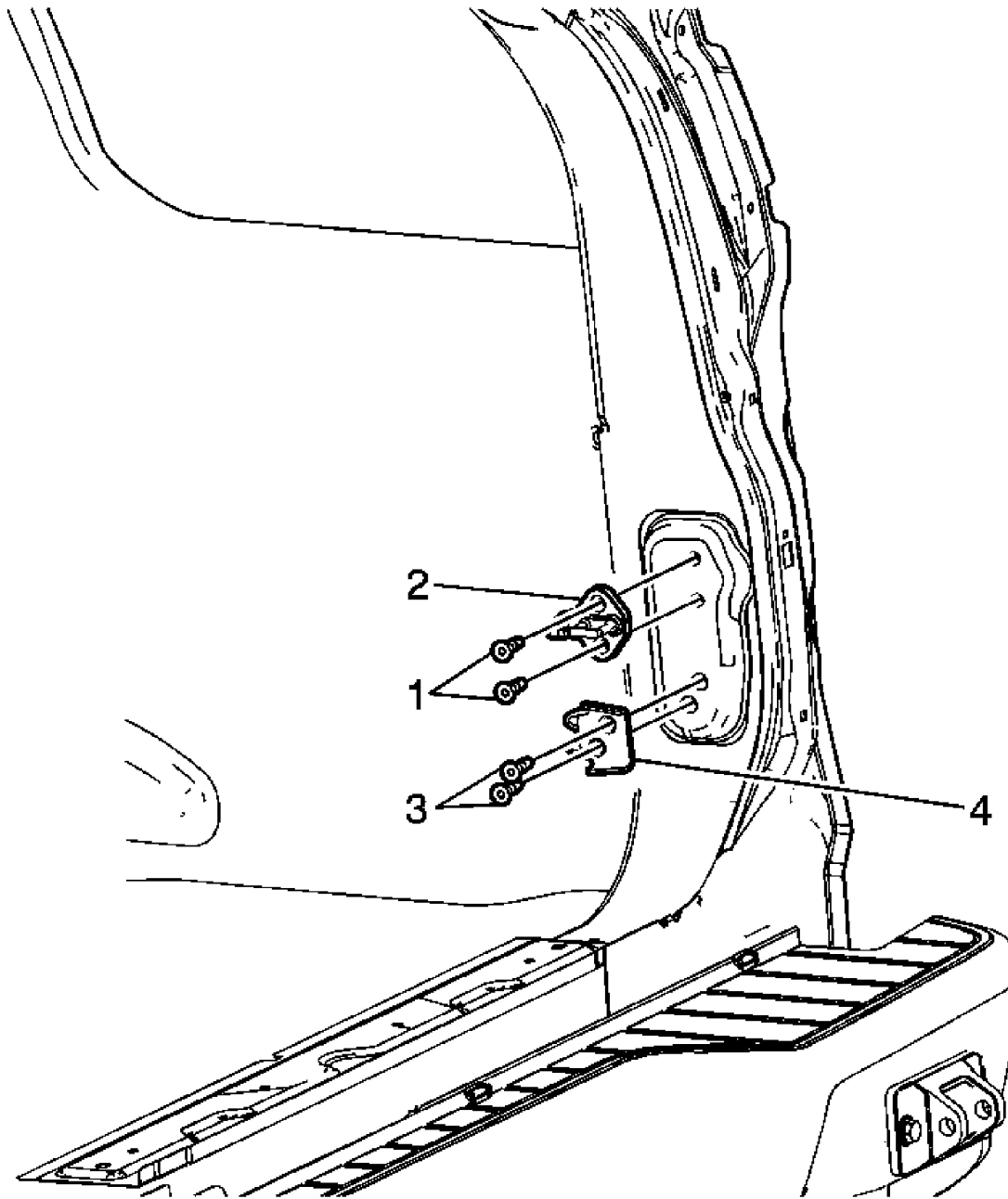

**Fig. 29: Lock Striker Replacement - Endgate**  
 Courtesy of GENERAL MOTORS CORP.

**Endgate Lock Striker Replacement**

| Callout | Component Name |
|---------|----------------|
|---------|----------------|

**NOTE:**  
 Refer to **Fastener Notice** .

**Fastener Tightening Specifications:** Refer to Fastener Tightening Specifications.

|   |  |
|---|--|
| 1 | Bolts, Striker (Qty: 2)<br><b>Tighten:</b> 25 N.m (19 lb ft)             |
| 2 | Striker, Striker Assembly<br><b>Tip:</b> Adjust as necessary.            |
| 3 | Bolts, Striker Guide Plate (Qty: 2)<br><b>Tighten:</b> 25 N.m (19 lb ft) |
| 4 | Guide Plate<br><b>Tip:</b> Adjust as necessary.                          |

**DOOR LOCK AND SIDE WINDOW SWITCH REPLACEMENT - DRIVER SIDE (1ST DESIGN)**

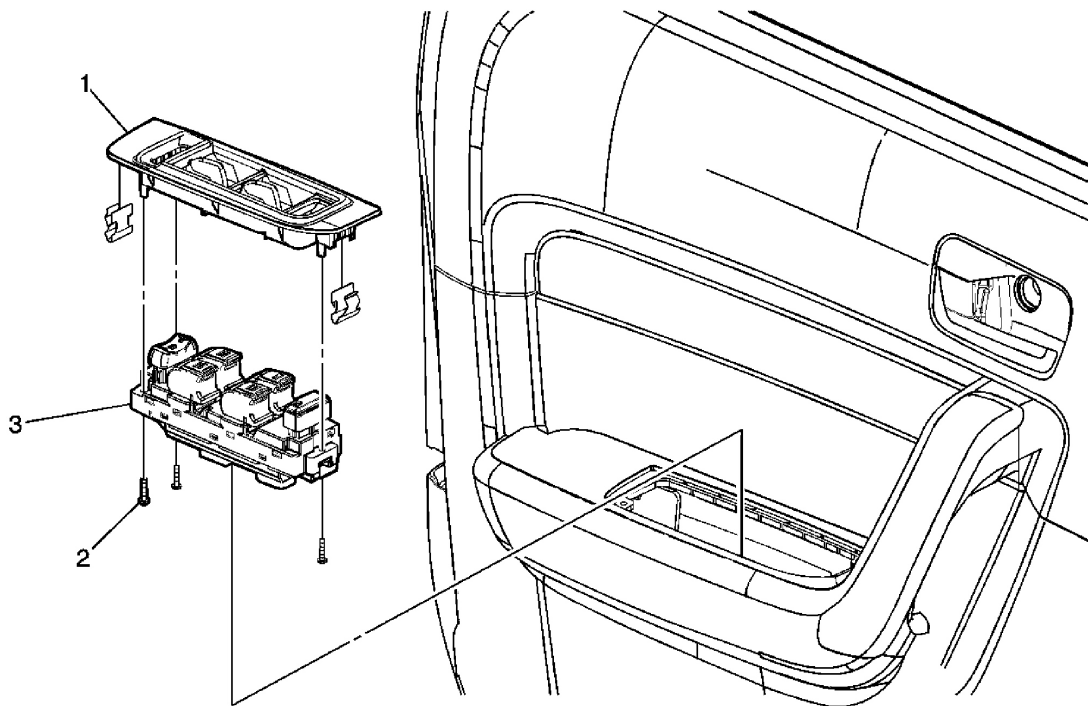

**Fig. 30: View Of Driver Side Door Lock/Side Window Switch**  
 Courtesy of GENERAL MOTORS CORP.

**Door Lock and Side Window Switch Replacement - Driver Side (1st Design)**

| Callout | Component Name  |
|---------|---|
| 1       | Front Side Door Accessory Switch Mount Plate Assembly |
|         |   |

## 2007 Hummer H3

2007 ACCESSORIES & EQUIPMENT Vehicle Access - H3

|   |  |
|---|--|
| 2 | Front Side Door Accessory Switch Mount Screw (Qty: 3)<br><br><b>NOTE:</b><br>Refer to <u>Fastener Notice</u> .<br><br><b>Tighten:</b> 2 N.m (18 lb in) |
| 3 | Front Side Door Accessory Switch Assembly<br><b>Procedure:</b><br>Disconnect the electrical connector.   |

### DOOR LOCK AND SIDE WINDOW SWITCH REPLACEMENT - DRIVER SIDE (2ND DESIGN)

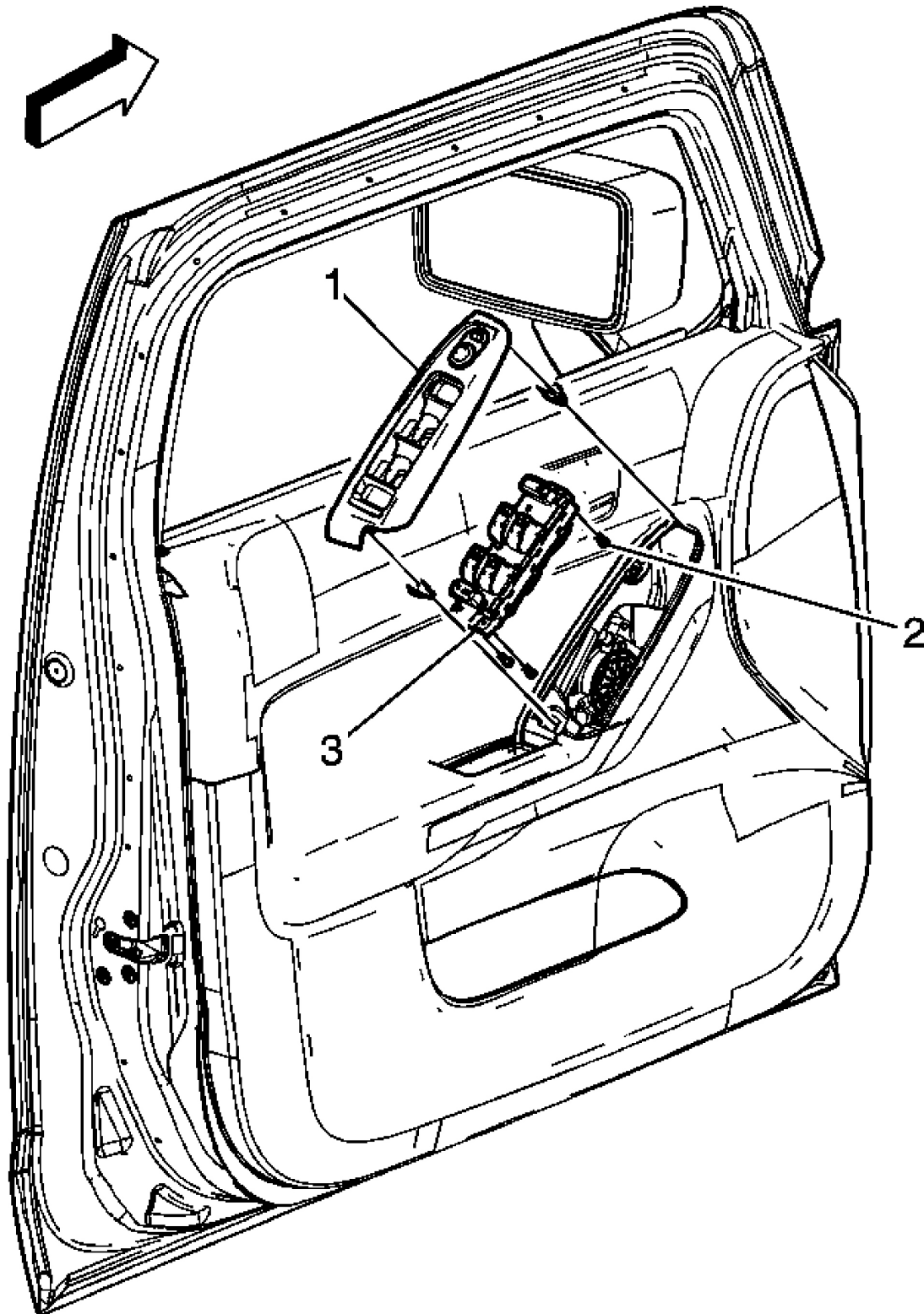

**Fig. 31: View Of Driver Side Door Lock/Side Window Switch**

Courtesy of GENERAL MOTORS CORP.

**Door Lock and Side Window Switch Replacement - Driver Side (2nd Design)**

| Callout | Component Name   |
|---------|--|
| 1       | Front Side Door Accessory Switch Mount Plate Assembly  |
| 2       | Front Side Door Accessory Switch Mount Screw (Qty: 3)<br><br><b>NOTE:</b><br>Refer to <u>Fastener Notice</u> .<br><br><b>Tighten:</b> 2 N.m (18 lb in) |
| 3       | Front Side Door Accessory Switch Assembly  |

**DOOR LOCK AND SIDE WINDOW SWITCH REPLACEMENT - PASSENGER SIDE**

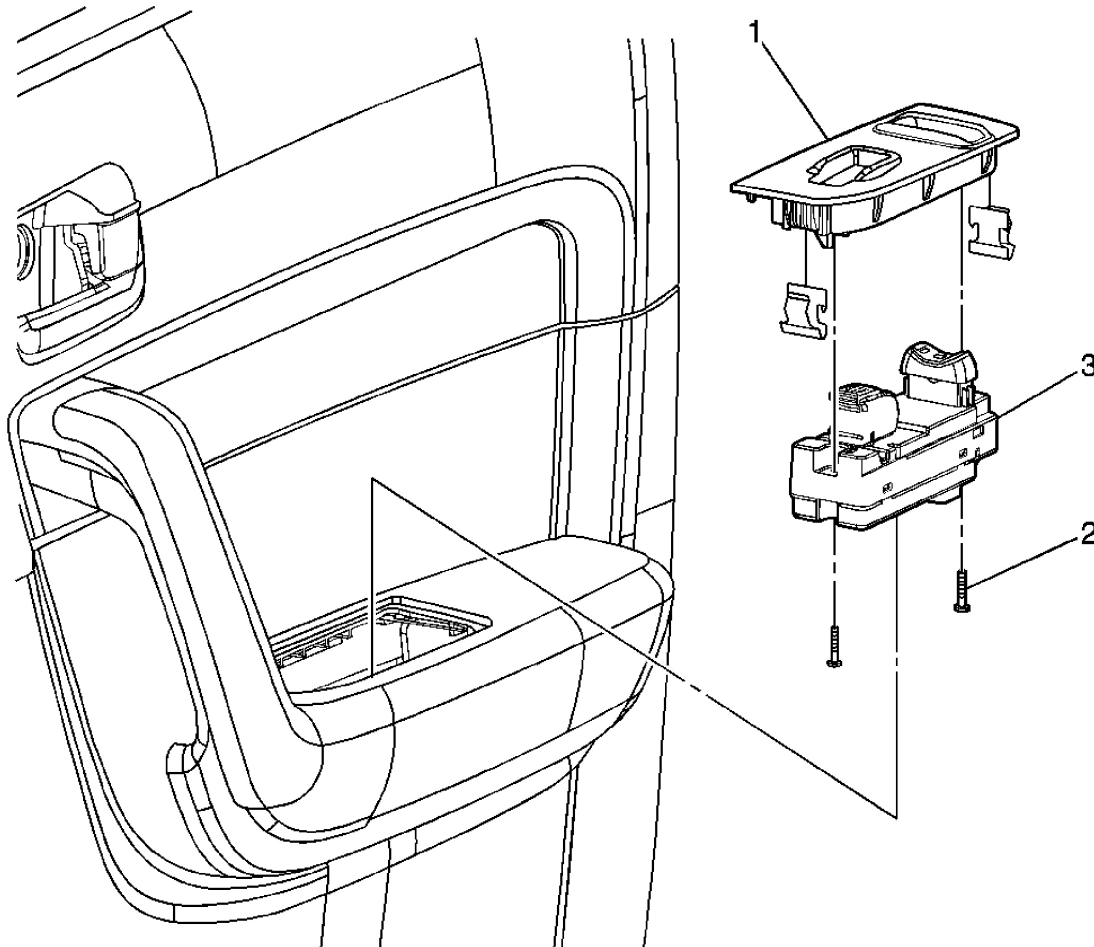

**Fig. 32: View Of Passenger Side Door Lock/Side Window Switch**  
**Courtesy of GENERAL MOTORS CORP.**

### Door Lock and Side Window Switch Replacement - Passenger Side

| Callout | Component Name   |
|---------|--|
| 1       | Front Side Door Accessory Switch Mount Plate Assembly  |
| 2       | Front Side Door Accessory Switch Mount Screw (Qty: 2)<br><br><b>NOTE:</b><br>Refer to <b>Fastener Notice</b> .<br><br><b>Tighten:</b> 2 N.m (18 lb in) |
| 3       | Front Side Door Accessory Switch Assembly<br><b>Procedure:</b><br>Disconnect the electrical connector.   |

## DESCRIPTION AND OPERATION

### DOOR AJAR INDICATOR DESCRIPTION AND OPERATION

#### Door Ajar Indicator

The instrument panel cluster (IPC) illuminates the door ajar indicator when the body control module (BCM) detects any of the 4 vehicle doors is open. The IPC receives a class 2 message from the BCM requesting illumination. The IPC sends a class 2 message to the radio in order to activate an audible warning.

### POWER DOOR LOCKS DESCRIPTION AND OPERATION

#### Door Lock System Components

The power door lock system consists of the following components:

- Driver switch assembly
- Passenger door lock switch
- Key cylinder switch
- Door lock actuators in each of the doors
- PWR LOCKS 20A fuse

#### Door Lock System Controls

The power door lock system can be controlled by any of the following:

- A door lock switch LOCK or UNLOCK activation
- A key cylinder lock/unlock activation
- A keyless entry transmitter activation
- An automatic door lock activation (Personalization function)
- An automatic door unlock activation (Personalization function)
- A delayed locking activation (Personalization function)

#### **Door Lock Operation**

When the driver switch assembly detects a transition of either its own door lock switch, the passenger door lock switch or the key cylinder switch to the LOCK position, it switches the door lock actuator lock control circuit to voltage. Since the lock actuator unlock control circuits are at ground potential within the driver switch assembly, the door lock actuator motors transition to the LOCK position.

#### **Driver Door Unlock Operation**

When the driver switch assembly detects a transition of either its own door lock switch, the passenger door lock switch or the key cylinder switch to the UNLOCK position, it switches the driver door lock actuator unlock control circuit to voltage. Since the door lock actuator lock control circuit is at ground potential within the driver switch assembly, the LF door lock actuator motor transitions to the UNLOCK position.

The driver door lock actuator unlock control circuit is a dedicated control circuit used only for the driver door lock actuator motor. This is done so that the driver door may be unlocked by itself using a keyless entry transmitter or an automatic door unlock function, if programmed.

#### **Passenger Door Unlock Operation**

When the driver switch assembly detects a transition of either its own door lock switch, the passenger door lock switch or the key cylinder switch to the UNLOCK position, it switches the door lock actuator unlock control circuits to voltage. Since the door lock actuator lock control circuit is at ground potential within the driver switch assembly, the passenger door lock actuator motors transition to the UNLOCK position.

The door lock actuator unlock control circuits are dedicated control circuits used only for the passenger door lock actuator motors. This is done so that the driver door may be unlocked separate from the passenger doors using a keyless entry transmitter or an automatic door unlock function, if programmed.

**Automatic Door Lock/Unlock**

The automatic door lock/unlock function is a vehicle personalization feature with the following 6 programmable modes of operation:

1. The automatic door lock feature is disabled.
2. The automatic door lock on shift out of PARK feature is disabled.
3. All of the doors lock when the vehicle is shifted out of PARK with the ignition ON and only the driver door unlocks when the vehicle is shifted into PARK.
4. All of the doors lock when the vehicle is shifted out of PARK with the ignition ON and all of the doors unlock when the vehicle is shifted into PARK.
5. All of the doors lock when the vehicle is shifted out of PARK with the ignition ON and only the driver door unlocks when the key is removed from the ignition.
6. All of the doors lock when the vehicle is shifted out of PARK with the ignition ON and all of the doors unlock when the key is removed from the ignition.

The automatic door lock function can only be enabled by the body control module (BCM) if the driver, front passenger and rear door switches are in an Inactive state (closed). For information on programming the automatic door locks, refer to **Vehicle Personalization** .

**Delayed Locking**

The delayed locking function is a vehicle personalization feature that is intended to allow the doors to be locked while passengers are exiting the vehicle. When delayed locking is in Active Mode, the body control module (BCM) will delay locking of the vehicle doors for 5 seconds after all of the doors have been closed. The delayed locking function will be overridden if the BCM receives a door UNLOCK input or a key in ignition input.

**Lockout Prevention**

This function is intended to prevent the vehicle operator from locking the doors if the key is left in the ignition and any vehicle door is open. The lockout prevention function can be overridden by the body control module (BCM) if the BCM receives a remote lock input or if the door is manually locked.

**Unlock After Air Bag Deployment**

This feature will unlock all of the vehicle doors 15 seconds after air bag deployment.