

2006 Hummer H3

2006 GENERAL MOTORS H3

2006 GENERAL MOTORS

H3

BUZZERS, RELAYS & TIMERS

BUZZERS, RELAYS & TIMERS LOCATION

Component	Location
A/C Clutch Relay	In underhood fuse block. See Fig. 45 .
A/C COMP Relay	On underhood fuse block.
AIR SOL Relay	In underhood fuse block. See Fig. 45 .
FOG/LP Relay	In underhood fuse block. See Fig. 45 .
Fuel/Pump Relay	In underhood fuse block. See Fig. 45 .
Grille Lamps Relay	Below side air inlet cover.
HDLP Relay	In underhood fuse block. See Fig. 45 .
High Speed Blower Motor Relay	Attached to blower motor case. See Fig. 27 .
HI/LO BEAM Relay	In underhood fuse block. See Fig. 45 .
HI/LOW WPR Relay	In underhood fuse block. See Fig. 45 .
HORN Relay	In underhood fuse block. See Fig. 45 .
HVAC Relay	In underhood fuse block. See Fig. 45 .
ON/OFF WPR Relay	In underhood fuse block. See Fig. 45 .
PCM CNTRL Relay	In underhood fuse block. See Fig. 45 .
PRK/LP Relay	In underhood fuse block. See Fig. 45 .
PWR/TRN Relay	In underhood fuse block. See Fig. 45 .
RAP/ACCY Relay	In underhood fuse block. See Fig. 45 .
Roof Lamps Relay	Below side air inlet cover.
RR DEFOG Relay	In underhood fuse block. See Fig. 45 .
RUN/CRNK Relay	In underhood fuse block. See Fig. 45 .
SPARE-1 Relay	In underhood fuse block. See Fig. 45 .
SPARE-2 Relay	In underhood fuse block. See Fig. 45 .

CIRCUIT PROTECTION DEVICES

2006 Hummer H3

2006 GENERAL MOTORS H3

CIRCUIT PROTECTION DEVICES LOCATION

Component	Location
A/C CLUTCH Relay Diode	In underhood fuse block. See Fig. 45 .
Blower Motor Resistor Assembly	Bottom of blower motor. See Fig. 27 .
Diode (Wiper)	In underhood fuse block. See Fig. 45 .
Seat Circuit Breaker	Under driver seat near C307.
Underhood Fuse Block	Above left front wheel well. See Fig. 17 .

CONTROL UNITS

CONTROL UNITS LOCATION

Component	Location
Audio Amplifier	Left rear of passenger compartment. See Fig. 8 .
Automatic Transmission Floor Shift Control	Beneath center console.
Body Control Module (BCM)	Behind right front kick panel. See Fig. 10 .
Digital Radio Receiver	Behind right side dash area. See Fig. 8 .
Electronic Brake Control Module (EBCM)	Left of master cylinder. See Fig. 3 .
Heated Seat Module - Driver	In driver seat bottom.
Heated Seat Module - Passenger	In passenger seat bottom.
HVAC Control Module	Beneath radio. See Fig. 27 .
Inflatable Restraint Passenger Presence System (PPS) Module	On underside of cushion. See Fig. 37 .
Inflatable Restraint Sensing And Diagnostic Module (SDM)	Beneath lower console. See Fig. 34 .
Powertrain Control Module (PCM)	At left front side of engine compartment. See Fig. 17 .
Transfer Case Shift Control Module	Behind glove box. See Fig. 41 .

2006 Hummer H3

2006 GENERAL MOTORS H3

Vehicle Communication Interface Module (VCIM)	Center of dash below HVAC control head. See Fig. 29 .
Window Wiper/Washer Module (Rear)	In endgate. See Fig. 15 .
Windshield Wiper/Washer Module	Center top of firewall. See Fig. 42 .

MOTORS**MOTORS LOCATION**

Component	Location
Air Temperature Actuator - Left	Mounted to left side of HVAC Module assembly. See Fig. 27 .
Air Temperature Actuator - Right	Mounted to left side of HVAC Module assembly. See Fig. 27 .
Blower Motor	Below right side of dash. See Fig. 27 .
Bolster Motor	In seat back. See Fig. 38 .
Chassis Differential Lock Actuator	On rear differential. See Fig. 16 .
Door Lock Actuator - Driver	In center rear of driver door, near door latch. See Fig. 12 .
Door Lock Actuator - Endgate	On right side of endgate. See Fig. 15 .
Door Lock Actuator - LR	In center rear of left rear door, near door latch. See Fig. 54 .
Door Lock Actuator - Passenger	In center rear of passenger door, near door latch. See Fig. 13 .
Door Lock Actuator - RR	In center rear of right rear door, near door latch.
Fuel Pump And Sender Assembly	Mounted on top of fuel tank. See Fig. 21 .
Ignition Lock Cylinder Control Actuator	On upper right side of steering column. See Fig. 33 .
Lumbar Pump Motor - Driver	In driver seat.
Lumbar Pump Motor - Passenger	In passenger seat. See Fig. 37 .
Mode Actuator	On side of heater box. See Fig. 27 .
Rear Differential Lock Actuator	Mounted to center of rear axle.

2006 Hummer H3

2006 GENERAL MOTORS H3

Rear Window Washer Fluid Pump	In right rear engine compartment area.
Rear Window Wiper Motor	Center of endgate. See Fig. 15 .
Recirculation Actuator	Upper right corner of heater case. See Fig. 27 .
Seat Motors - Driver	Under driver seat. See Fig. 38 .
Seat Motors - Passenger	Under passenger seat. See Fig. 37 .
Starter Motor	Mounted to left side of engine. See Fig. 22 .
Sunroof Motor	At front of sunroof module. See Fig. 25 .
Swinggate Lock Actuator -Right	In rear endgate. See Fig. 56 .
Transfer Case Encoder Motor	Part of transfer case. See Fig. 6 .
Window Motor - Driver	Attached to interior of left front door. See Fig. 12 .
Window Motor - LR	Attached to interior of left rear door. See Fig. 14 .
Window Motor - Passenger	Attached to interior of right front door. See Fig. 13 .
Window Motor - RR	Attached to interior of right rear door.
Windshield Washer Fluid Pump	Mounted on fluid reservoir. See Fig. 42 .
Windshield Washer Fluid Pump (Rear)	On fluid reservoir. See Fig. 42 .
Windshield Wiper Motor	Under center of front cowl. See Fig. 42 .

SENDING UNITS & SENSORS**SENDING UNITS & SENSORS LOCATION**

Component	Location
Accelerator Pedal Position (APP) Sensor	On accelerator pedal bracket. See Fig. 2 .
A/C Refrigerant Pressure Sensor	On high pressure hose connection to compressor. See Fig. 26 .

2006 Hummer H3

2006 GENERAL MOTORS H3

Ambient Air Temperature Sensor	Attached to front center of radiator support. See Fig. 26 .
Ambient Light Sensor	Right side of dash upper trim panel. See Fig. 1 .
Camshaft Position (CMP) Actuator Solenoid - Bank 1 Exhaust	Top right front of engine.
Camshaft Position (CMP) Sensor - Exhaust	Top left front of engine. See Fig. 19 .
Camshaft Position (CMP) Sensor - Intake	Top front right of engine. See Fig. 19 .
Crankshaft Position (CKP) Sensor	Left rear of engine block, below starter. See Fig. 19 .
Engine Coolant Temperature (ECT) Sensor	Top rear center of engine. See Fig. 18 .
Evaporator Temperature Sensor	Behind right lower dash. See Fig. 27 .
Fuel Tank Pressure (FTP) Sensor	Top of fuel pump and sender assembly. See Fig. 21 .
Heated Oxygen Sensor (HO2S) 1	On exhaust manifold on right side of engine. See Fig. 18 .
Heated Oxygen Sensor (HO2S) 2	In exhaust pipe, adjacent to transmission. See Fig. 6 .
Inflatable Restraint Front End Sensor - Left	Left lower radiator support. See Fig. 26 .
Inflatable Restraint Front End Sensor - Right	Right lower radiator support. See Fig. 26 .
Inflatable Restraint Passenger Presence System (PPS) Sensor	In front passenger seat cushion.
Inflatable Restraint Passenger Seat Belt Tension Sensor	Part of seat belt buckle. See Fig. 36 .
Inflatable Restraint Seat Position Sensor (SPS) - Left	On driver seat track. See Fig. 35 .
Inflatable Restraint Seat Position Sensor (SPS) - Right	On driver seat track. See Fig. 36 .

2006 Hummer H3

2006 GENERAL MOTORS H3

Inflatable Restraint Side Impact Sensor (SIS) - Left	In left front door. See Fig. 12 .
Inflatable Restraint Side Impact Sensor (SIS) - Right	In right front door. See Fig. 34 .
Inflatable Restraint Vehicle Rollover Sensor	Under center console. See Fig. 3 .
Input Speed Sensor (ISS) Assembly	On transmission assembly. See Fig. 5 .
Knock Sensor (KS) Bank 2	Below intake manifold, near front of engine. See Fig. 19 .
Longitudinal Accelerometer Sensor	Under driver seat near C307.
Manifold Absolute Pressure (MAP) Sensor	At top right side rear of engine, on intake manifold. See Fig. 18 .
Mass Air Flow (MAF)/Intake Air Temperature (IAT) Sensor	Between air cleaner and throttle body. See Fig. 17 .
Steering Wheel Position Sensor	Near base of steering column. See Fig. 33 .
Tire Pressure Monitor Sensor - LF	In left front tire. See Fig. 40 .
Tire Pressure Monitor Sensor - LR	In left rear tire. See Fig. 40 .
Tire Pressure Monitor Sensor - RF	In left rear tire. See Fig. 40 .
Tire Pressure Monitor Sensor - RR	In right rear tire. See Fig. 40 .
Vehicle Speed Sensor (VSS)	Left rear of transfer case. See Fig. 5 .
Wheel Speed Sensor (WSS) - LF	Attached to left front wheel hub. See Fig. 4 .
Wheel Speed Sensor (WSS) - LR	Attached to left side of rear axle. See Fig. 4 .
Wheel Speed Sensor (WSS) - RF	Attached to right front wheel hub. See Fig. 4 .
Wheel Speed Sensor (WSS) - RR	Attached to right side of rear axle. See Fig. 4 .
Yaw Rate/Lateral & Longitudinal Accelerometer Sensor	Under driver seat near C307. See Fig. 3 .

SOLENOIDS & SOLENOID VALVES

SOLENOIDS & SOLENOID VALVES LOCATION

Component	Location
A/C Compressor Clutch	Part of A/C compressor. See Fig. 26 .
A/T Shift Lock Control Solenoid	Part of automatic transmission floor shift control. See Fig. 39 .
Camshaft Position (CMP) Actuator Solenoid (Bank 1 Exhaust)	Right front of cylinder head. See Fig. 18 .
Evaporative Emission (EVAP) Canister Purge Solenoid Valve	Below intake, in back of alternator. See Fig. 19 .
Evaporative Emission (EVAP) Canister Vent Solenoid Valve	Above spare tire. See Fig. 21 .
Fuel Injector 1	Attached to fuel rail at No. 1 cylinder. See Fig. 20 .
Fuel Injector 2	Attached to fuel rail at No. 2 cylinder. See Fig. 20 .
Fuel Injector 3	Attached to fuel rail at No. 3 cylinder. See Fig. 20 .
Fuel Injector 4	Attached to fuel rail at No. 4 cylinder. See Fig. 20 .
Fuel Injector 5	Attached to fuel rail at No. 5 cylinder. See Fig. 20 .
Mode Actuator	Top left side of heater case.
Pressure Control (PC) Solenoid Valve	In automatic transmission. See Fig. 5 .
Starter Solenoid	Top of starter. See Fig. 19 .
Torque Converter Clutch Pulse Width Modulation (TCC PWM) Solenoid Valve	In automatic transmission. See Fig. 5 .
Torque Converter Clutch (TCC) Solenoid Valve	In automatic transmission. See Fig. 5 .
1-2 Shift Solenoid (SS) Valve	In automatic transmission. See Fig. 5 .
2-3 Shift Solenoid (2-3) (SS) Valve	In automatic transmission. See Fig. 5 .
3-2 Shift Solenoid (3-2) (SS) Valve	In automatic transmission. See Fig. 5 .

SWITCHES

SWITCHES LOCATION

Component	Location
Accessory Switch	In center of dash.
Automatic Transmission Fluid Pressure (TFP) Manual Valve Position Switch	In automatic transmission. See Fig. 5 .
Back-Up Lamp Switch (Automatic Transmission)	On top of transmission.
Backup Lamp Switch (Manual Transmission)	On top of transmission. See Fig. 31 .
Brake Fluid Level Switch	On left side of brake fluid reservoir. See Fig. 3 .
Clutch Release Switch	At top of clutch pedal assembly. See Fig. 23 .
Clutch Start Switch	At top of clutch pedal assembly. See Fig. 2 .
Door Ajar Switch - Driver	In lower left "B" pillar. See Fig. 30 .
Door Ajar Switch - LR	In lower left "C" pillar. See Fig. 30 .
Door Ajar Switch - Passenger	In lower right "B" pillar. See Fig. 30 .
Door Ajar Switch - RR	In lower right "C" pillar. See Fig. 30 .
Endgate Ajar Switch	In right "D" pillar. See Fig. 30 .
Engine Oil Pressure (EOP) Switch	Above oil filter. See Fig. 18 .
Park Brake Switch	Left lower side of dash. See Fig. 2 .
Park/Neutral Position (PNP) Switch	Left side of automatic transmission. See Fig. 7 .
Stop Lamp Switch	Above brake pedal assembly. See Fig. 2 .
TCC Brake/Cruise Release Switch	Top of brake pedal assembly. See Fig. 2 .
Turn Signal/Multifunction Switch	Top of steering column. See Fig. 33 .

MISCELLANEOUS

2006 Hummer H3

2006 GENERAL MOTORS H3

MISCELLANEOUS LOCATION

Component	Location
Audio Amplifier	Mounted next to subwoofer. See Fig. 24 .
Battery	Left side of engine compartment.
Blower Motor Resistor Assembly	Attached to bottom of blower.
Cellular Microphone	Mounted in left front headliner. See Fig. 9 .
Cellular, Navigation & Digital Radio Antenna	Mounted to right front roof area. See Fig. 7 .
Data Link Connector (DLC)	Left side of dash. See Fig. 29 .
Digital Radio Receiver	Right side of dash. See Fig. 29 .
Engine Block Heater	Left side of engine block. See Fig. 19 .
Generator	At left front of engine. See Fig. 22 .
Global Positioning System (GPS) Antenna	Behind right dash cluster. See Fig. 32 .
Heater Element Seat Back - Driver	In driver seat back. See Fig. 38 .
Heater Element Seat Back - Passenger	In passenger seat back. See Fig. 37 .
Heater Element Seat Cushion - Driver	In driver seat bottom. See Fig. 38 .
Heater Element Seat Cushion - Passenger	In passenger seat bottom. See Fig. 37 .
Horn	Front of vehicle, behind grill. See Fig. 28 .
Ignition Coil 1	In center front of cam cover at No. 1 cylinder. See Fig. 18 .
Ignition Coil 2	In center front of cam cover at No. 2 cylinder. See Fig. 18 .
Ignition Coil 3	In center front of cam cover at No. 3 cylinder. See Fig. 18 .
Ignition Coil 4	In center front of cam cover at No. 4 cylinder. See Fig. 18 .
Ignition Coil 5	In center front of cam cover at No. 5 cylinder. See Fig. 18 .

2006 Hummer H3

2006 GENERAL MOTORS H3

Inflatable Restraint Steering Wheel Module Coil	Mounted to steering wheel. See Fig. 33 .
Seat Belt Pretensioner - LF	At left inner "B" pillar. See Fig. 34 .
Seat Belt Pretensioner - RF	At right inner "B" pillar. See Fig. 34 .
Seat Belt Switch - Left	Part of seat belt buckle (Driver).
Seat Belt Switch - Right	Part of seat belt buckle (Passenger).

CONNECTORS**CONNECTORS LOCATION**

Component	Location
C100 (Black, 4 Pin)	In engine harness to front axle jumper harness.
C101 (Black, 6 Pin)	Rear center of engine. See Fig. 18 .
C115 (Black, 16 Pin)	Right of left front fog lamp. See Fig. 28 .
C116 (Black, 8 Pin)	Behind left headlamp assembly. See Fig. 28 .
C117 (Black, 8 Pin)	Behind right headlamp assembly. See Fig. 28 .
C125 (Black, 16 Pin)	Near battery. See Fig. 43 .
C130 (Black, 2 Pin)	In body harness to battery cable harness. See Fig. 48 .
C150 (Black, 16 Pin)	Behind battery next to EBCM. See Fig. 48 .
C155 (Black, 4 Pin)	Next to EBCM. See Fig. 48 .
C175 (20 Pin)	Right side of transmission.
C200 (Black, 40 Pin)	Behind left of dash. See Fig. 11 .
C201 (Blue/Gray, 22 Pin)	Base of steering column. See Fig. 11 .
C203 (White, 8 Pin)	Near blower motor. See Fig. 11 .
C204 (Blue/Gray, 22 Pin)	Behind right kick panel. See Fig. 10 .
C205 (White, 12 Pin)	Near blower motor. See Fig. 11 .
C207 (White, 12 Pin)	Behind left of dash. See Fig. 11 .

2006 Hummer H3

2006 GENERAL MOTORS H3

C208 (Yellow, 4 Pin)	Behind left of dash. See Fig. 11 .
C275 (Yellow, 4 Pin)	Next to C201. See Fig. 33 .
C307 (White, 8 Pin)	Under driver seat. See Fig. 38 .
C308 (White, 4 Pin)	In body harness to driver seat belt switch jumper harness.
C315 (White, 12 Pin)	Under passenger seat. See Fig. 37 .
C318 (Black, 3 Pin)	In passenger seat bottom.
C319 (Black, 3 Pin)	In driver seat bottom.
C320 (w/o Seat Heater) (4 Pin)	In body harness to passenger seat belt switch jumper harness.
C320 (w/Seat Heater) (8 Pin)	In body harness to passenger seat belt switch jumper harness.
C330 (White, 8 Pin)	Behind upper left A-pillar trim panel. See Fig. 25 .
C335 (White, 6 Pin)	Behind upper left A-pillar trim panel. See Fig. 25 .
C350 (White, 6 Pin)	Behind right lower A-pillar trim. See Fig. 50 .
C370 (White, 12 Pin)	In left rear passenger door. See Fig. 14 .
C380 (White, 12 Pin)	In right rear passenger door. See Fig. 50 .
C410 (Black, 4 Pin)	Behind right rear quarter trim panel near D-pillar. See Fig. 51 .
C420 (w/Heavy Duty harness) (Black, 16 Pin)	Rearward of left wheel well. See Fig. 55 .
C420 (w/o Heavy Duty Harness) (Gray, 4 Pin)	Rearward of left wheel well. See Fig. 55 .
C430 (White, 4 Pin)	Behind left rear quarter trim panel near D-pillar. See Fig. 51 .
C450 (White, 12 Pin)	Behind left rear quarter trim panel near D-pillar. See Fig. 15 .
C500 (Black/White, 30 Pin)	In driver door. See Fig. 12 .

2006 Hummer H3

2006 GENERAL MOTORS H3

C510 (White, 8 Pin)	Inside middle front of drivers door, near A-pillar. See Fig. 12 .
C600 (Black/White, 30 Pin)	Body harness to passenger door harness, in passenger door. See Fig. 13 .
C901 (White, 12 Pin)	Left middle of end gate near pass-through. See Fig. 15 .

GROUND S

GROUND S LOCATION

Component	Location
G100	In engine compartment, mounted to the LF inner fender, behind the battery. See Fig. 22 .
G102	On lower left side of engine block, rearward of G103. See Fig. 44 .
G103	On lower left side of engine block, forward of G102. See Fig. 44 .
G104	Left side of engine block, in front of starter. See Fig. 44 .
G105	On left inner front wheel well, behind battery. See Fig. 44 .
G106	On right inner front wheel well, behind battery. See Fig. 44 .
G110	Left side of engine block, forward of G103. See Fig. 44 .
G120	On left lower inner wheel well, near engine mount. See Fig. 44 .
G300	Under driver seat carpet, on floor board. See Fig. 44 .
G310	Mounted under left side of passenger seat. See Fig. 44 .
	Under rear of middle console carpet,

2006 Hummer H3

2006 GENERAL MOTORS H3

G320	on floor board. See Fig. 44 .
G340	Behind right rear quarter trim, near wheel well. See Fig. 44 .
G345	Behind left rear quarter trim, near wheel well. See Fig. 44 .
G350	Behind left rear quarter trim, near wheel well. See Fig. 44 .
G420	Mounted to left side of rear cross member, near C420. See Fig. 44 .

SPLICES**SPLICES LOCATION**

Component	Location
S101	In dealer installed off road harness, 1.5cm (5.9in) from roof lamps relay, near master cylinder.
S102	In dealer installed off road harness, 1.5cm (5.9in) from roof lamps relay, near master cylinder.
S103	In engine compartment harness, near grille lamps relay, by master cylinder.
S104	In dealer installed grille lamps off road harness, near left side grille lamp connector.
S105	In dealer installed grille lamps off road harness, near left side grille lamp connector.
S109	In forward lamp harness, approximately 43 cm (17 in) from C115. See Fig. 28 .
S110	In body harness near EBCM, approximately 7.5 cm (3 in) back from EBCM. See Fig. 48 .

2006 Hummer H3

2006 GENERAL MOTORS H3

S112	In forward lamp harness, near left upper radiator support. See Fig. 28 .
S120	In forward lamp harness, near center point of top of radiator. See Fig. 28 .
S134	In forward lamp harness, approximately 15 cm (5.9 in) from C115. See Fig. 28 .
S141	In body harness, approximately 5 cm (0.2 in) before breakout to EBCM. See Fig. 48 .
S143	In body harness, approximately 2 cm (0.8 in) before breakout to C125. See Fig. 48 .
S185	In forward lamp harness, approximately 25 cm (9.8 in) from C115. See Fig. 28 .
S205	In I/P harness, approximately 5 cm (2 in) right of breakout to left footwell lamp. See Fig. 46 .
S206	In I/P harness, approximately 7 cm (2.8 in) right of breakout to right footwell lamp. See Fig. 46 .
S209	In body harness, approximately 6 cm (2.4 in) to right of stop lamp switch breakout in main harness. See Fig. 49 .
S210	In body harness, approximately 16 cm (6.3 in) before left front tweeter breakout. See Fig. 49 .
S213	In body harness, approximately 11 cm (4.3 in) to right of stop lamp switch breakout in main harness. See Fig. 49 .
S214	In I/P harness, approximately 2.5 cm (1 in) to right of data link connector in main bundle. See Fig. 46 .

2006 Hummer H3

2006 GENERAL MOTORS H3

S215	In body harness, approximately 14 cm (5.5 in) to right of stop lamp switch breakout in main harness. See Fig. 49 .
S220	In blower motor resistor jumper harness, approximately 15 cm (6 in) from C203. See Fig. 47 .
S224	In body harness, approximately 15 cm (5.9 in) from main harness into breakout to sunroof. See Fig. 49 .
S230	In HVAC harness, approximately 10 cm (3.9 in) back from right air temperature actuator connector. See Fig. 47 .
S234	In I/P harness center dash area, approximately 5 cm (2 in) left of breakouts to HVAC in main bundle. See Fig. 46 .
S240	In HVAC harness, approximately 28.5 cm (11.2 in) back from right air temperature actuator connector. See Fig. 47 .
S244	In body harness behind passenger side dash area, approximately 25 cm (9.8 in) before breakout to right front door. See Fig. 50 .
S245	In body harness left front kick panel area, approximately 26 cm (10.2 in) rearward of left body pass through. See Fig. 49 .
S247	In body harness behind passenger side dash area, approximately 5 cm (2 in) before breakout to right front door. See Fig. 50 .
	In HVAC harness, approximately 13.5

2006 Hummer H3

2006 GENERAL MOTORS H3

S250	cm (5.3 in) before breakout to evaporator temperature sensor. See Fig. 47 .
S251	In I/P harness, approximately 0.5 cm (0.2 in) right of breakout to left foot well lamp. See Fig. 46 .
S260	In HVAC harness, approximately 23.5 cm (9.3 in) back from right air temperature actuator connector. See Fig. 47 .
S264	In body harness, approximately 24.5 cm (9.6 in) rearward of body pass through in breakout to left door. See Fig. 49 .
S292	In body harness right kick panel area, approximately 3 cm (1.2 in) rearward of breakout to BCM. See Fig. 50 .
S294	In body harness, approximately 3 cm (1.2 in) to left of park brake switch breakout. See Fig. 49 .
S295	In body harness, approximately 3 cm (1.2 in) to right of park brake switch breakout. See Fig. 49 .
S300	In body harness, approximately 20 cm (7.9 in) forward of left rocker channel cover. See Fig. 49 .
S301	In dealer installed off road harness, under roof-mounted light bar near drivers side lamp connector.
S302	In dealer installed off road harness, under roof-mounted light bar near drivers side lamp connector.
S305	In body harness under right door sill plate, approximately 18 cm (7 in) from

2006 Hummer H3

2006 GENERAL MOTORS H3

	breakout to C204. See Fig. 50 .
S306	In driver seat harness in breakout to lumbar adjuster/heater switch.
S309	In body harness under left door sill plate, approximately 41 cm (16.1 in) rearward of body pass through in main bundle. See Fig. 49 .
S310	In body harness, approximately 4.5 cm (1.8 in) left of breakout to A/T floor shift control. See Fig. 50 .
S312	In driver seat harness, approximately 28.5cm (11.2in) back from C307.
S313	In passenger seat heater element jumper harness.
S314	In body harness, approximately 44.5 cm (17.5 in) rearward of breakout to left seat belt pretensioner. See Fig. 51 .
S315	In body harness, approximately 47 cm (18.5 in) rearward of breakout to right seat belt pretensioner. See Fig. 50 .
S316	In passenger seat harness, approximately 5cm (2in) before breakout to seat adjuster and lumbar adjuster/heater switches.
S317	In passenger seat heater element jumper harness.
S318	In passenger seat heater element jumper harness.
S319	In passenger seat heater element jumper harness.
S320	In body harness rear seat area along sill, approximately 20 cm (7.9 in) rearward of breakout to G320. See Fig. 50 .

2006 Hummer H3

2006 GENERAL MOTORS H3

S321	In driver seat heater element jumper harness.
S322	In driver seat heater element jumper harness.
S323	In body harness, approximately 13 cm (5.1 in) right of breakout to G310. See Fig. 50 .
S324	In driver seat heater element jumper harness.
S325	In driver seat heater element jumper harness.
S330	In dome lamp jumper harness, approximately 5 cm (2 in) before breakout to right sunshade. See Fig. 52 .
S340	In dome lamp jumper harness, approximately 10 cm (3.9 in) before breakout to right sunshade. See Fig. 52 .
S341	In passenger seat harness, approximately 10cm (3.9in) before breakout to seat adjuster and lumbar adjuster/heater switches.
S344	In body harness, approximately 20 cm (7 in) to left of SDM breakout. See Fig. 49 .
S347	In body harness, approximately 42 cm (16.5 in) rearward of breakout to right seat belt pretensioner. See Fig. 50 .
S350	In dome lamp jumper harness, approximately 5 cm (2 in) before breakout to dome/reading lamp. See Fig. 52 .
	In chassis harness, approximately 22.5

2006 Hummer H3

2006 GENERAL MOTORS H3

S359	cm (8.9 in) from fuel pump and sender assembly connector. See Fig. 55 .
S514	In driver door harness, approximately 6.5 cm (2.6 in) before breakouts to door lock and window switch. See Fig. 53 .
S529	In driver door harness, approximately 7.5 cm (3 in) before breakout to power window motor. See Fig. 53 .
S590	In driver door harness, approximately 7.5 cm (3 in) before breakout to OSRVM. See Fig. 53 .
S900	In endgate harness, approximately 19.5 cm (7.7 in) rearward of endgate grommet. See Fig. 56 .

COMPONENT LOCATION GRAPHICS

NOTE: Figures may show multiple component locations. Refer to appropriate table for proper figure references.

2006 Hummer H3

2006 GENERAL MOTORS H3

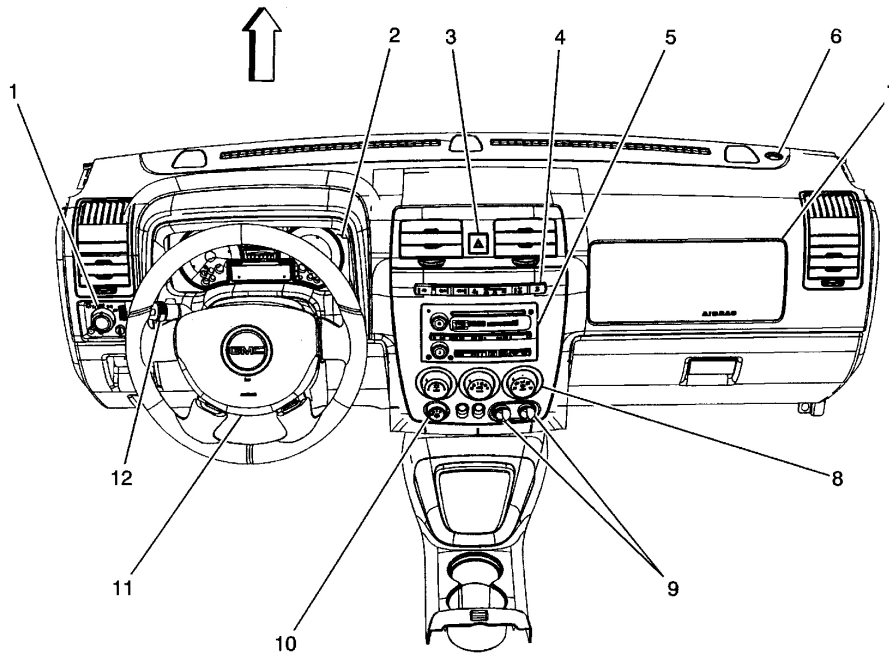

- | | |
|-------------------------------------|---|
| (1) Headlamp Switch | (9) Auxiliary Power Outlets - Front |
| (2) Instrument Panel Cluster (IPC) | (10) Rear Window Wiper/Washer Switch |
| (3) Hazard Switch | (11) Inflatable Restraint Steering Wheel Module |
| (4) Accessory Switch | (12) Turn Signal/Multifunction Switch |
| (5) Radio | |
| (6) Ambient Light Sensor | |
| (7) Inflatable Restraint I/P Module | |
| (8) HVAC Control Module | |

G00419101

Fig. 1: Dash
Courtesy of GENERAL MOTORS CORP.

2006 Hummer H3

2006 GENERAL MOTORS H3

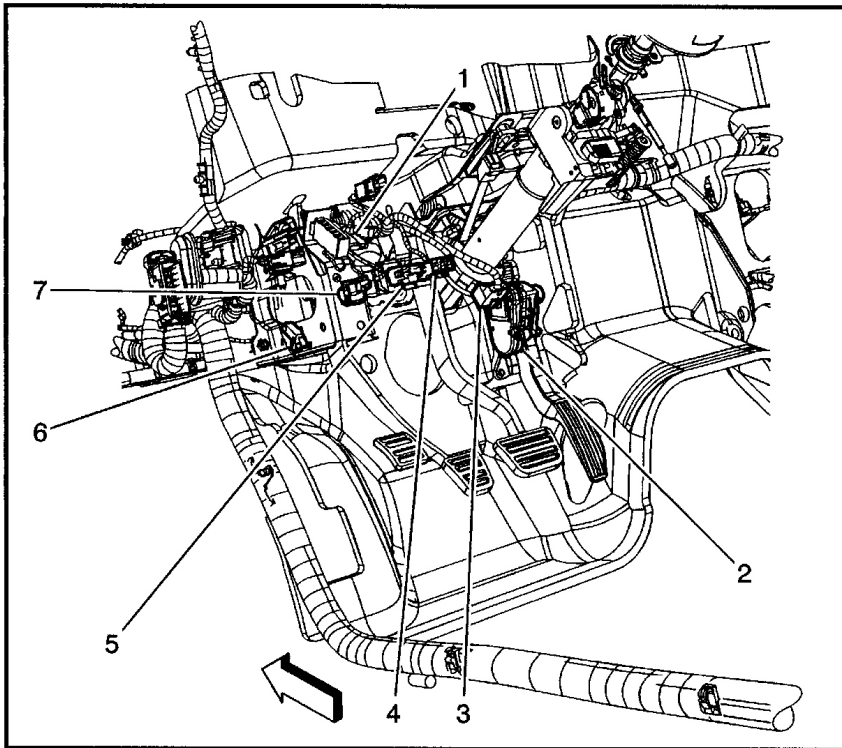
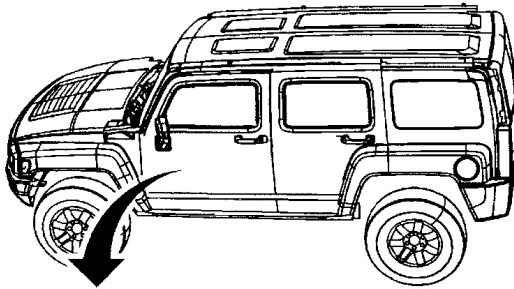

- (1) Clutch Start Switch (MA5)
- (2) Accelerator Pedal Position (APP) Sensor
- (3) Steering Wheel Position Sensor (JL4)
- (4) TCC Brake/Cruise Release Switch
- (5) Stop Lamp Switch
- (6) Park Brake Switch
- (7) Clutch Release Switch (MA5)

G00419102

Fig. 2: Lower Left Side Of Dash
Courtesy of GENERAL MOTORS CORP.

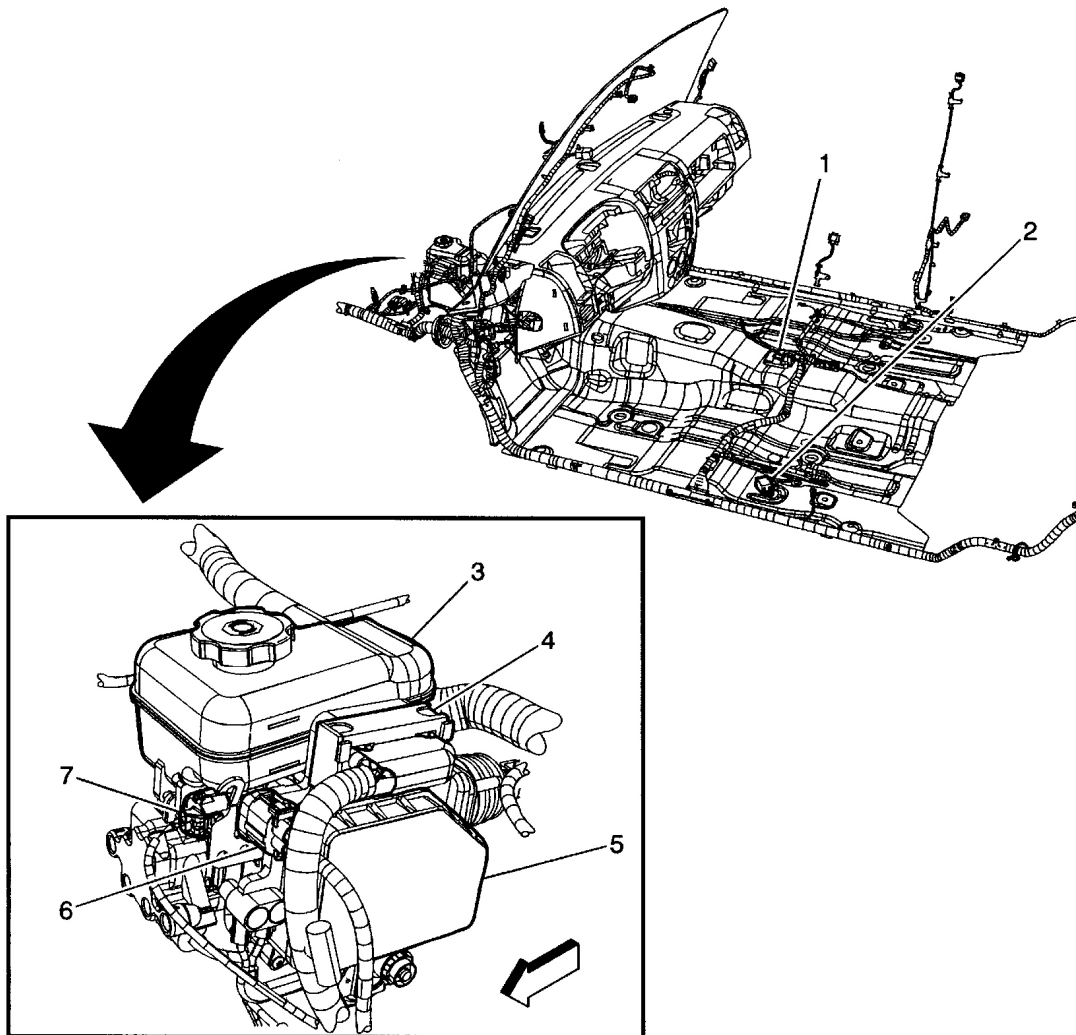

- (1) Inflatable Restraint Vehicle Rollover Sensor (ASF)
- (2) Yaw Rate/Lateral and Longitudinal Accelerometer Sensor (JL4)
- (3) Brake Fluid Reservoir
- (4) Electronic Brake Control Module (EBCM) C2
- (5) Electronic Brake Control Module (EBCM)
- (6) Electronic Brake Control Module (EBCM) C1
- (7) Brake Fluid Level Switch

G00419103

Fig. 3: Brake Components
Courtesy of GENERAL MOTORS CORP.

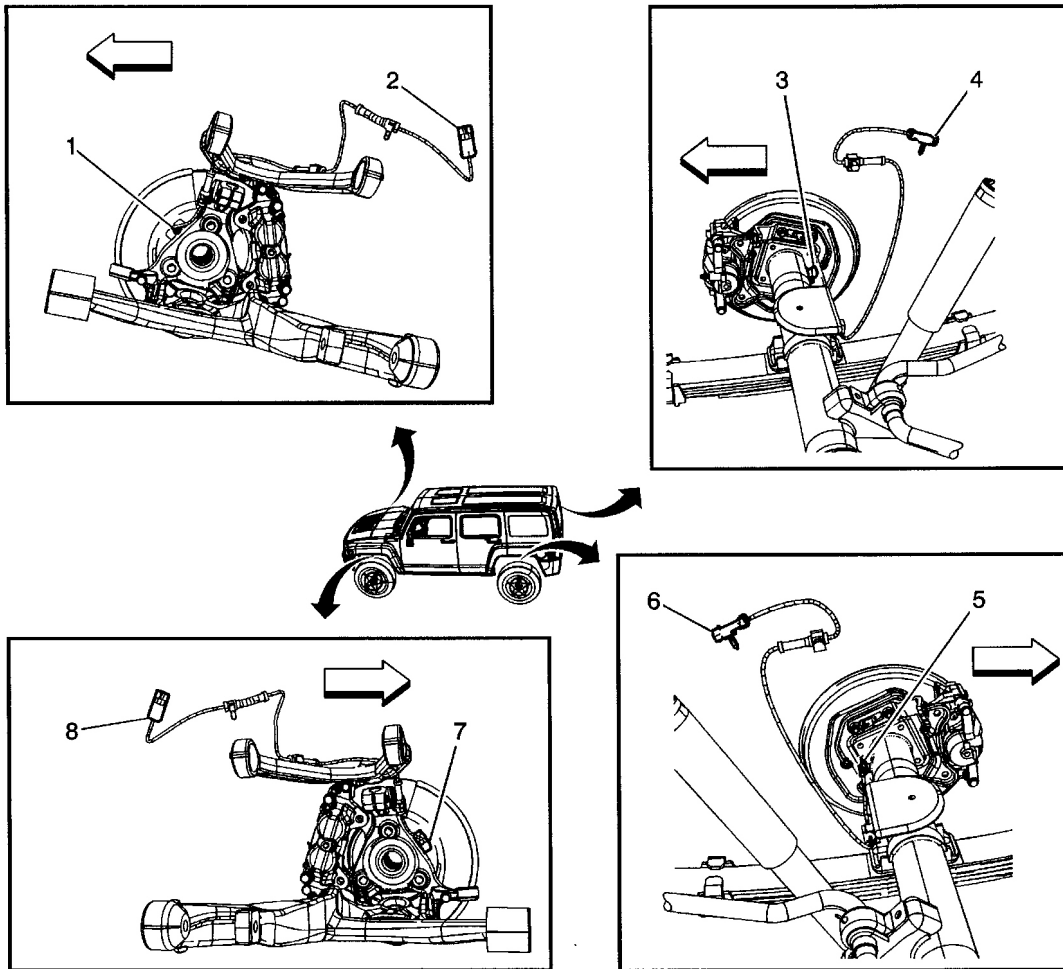

- (1) Wheel Speed Sensor (WSS) - RF
- (2) Wheel Speed Sensor (WSS) - RF Connector
- (3) Wheel Speed Sensor (WSS) - RR
- (4) Wheel Speed Sensor (WSS) - RR Connector
- (5) Wheel Speed Sensor (WSS) - LR
- (6) Wheel Speed Sensor (WSS) - LR Connector
- (7) Wheel Speed Sensor (WSS) - LF
- (8) Wheel Speed Sensor (WSS) - LF Connector

G00419104

Fig. 4: Wheel Speed Sensors
Courtesy of GENERAL MOTORS CORP.

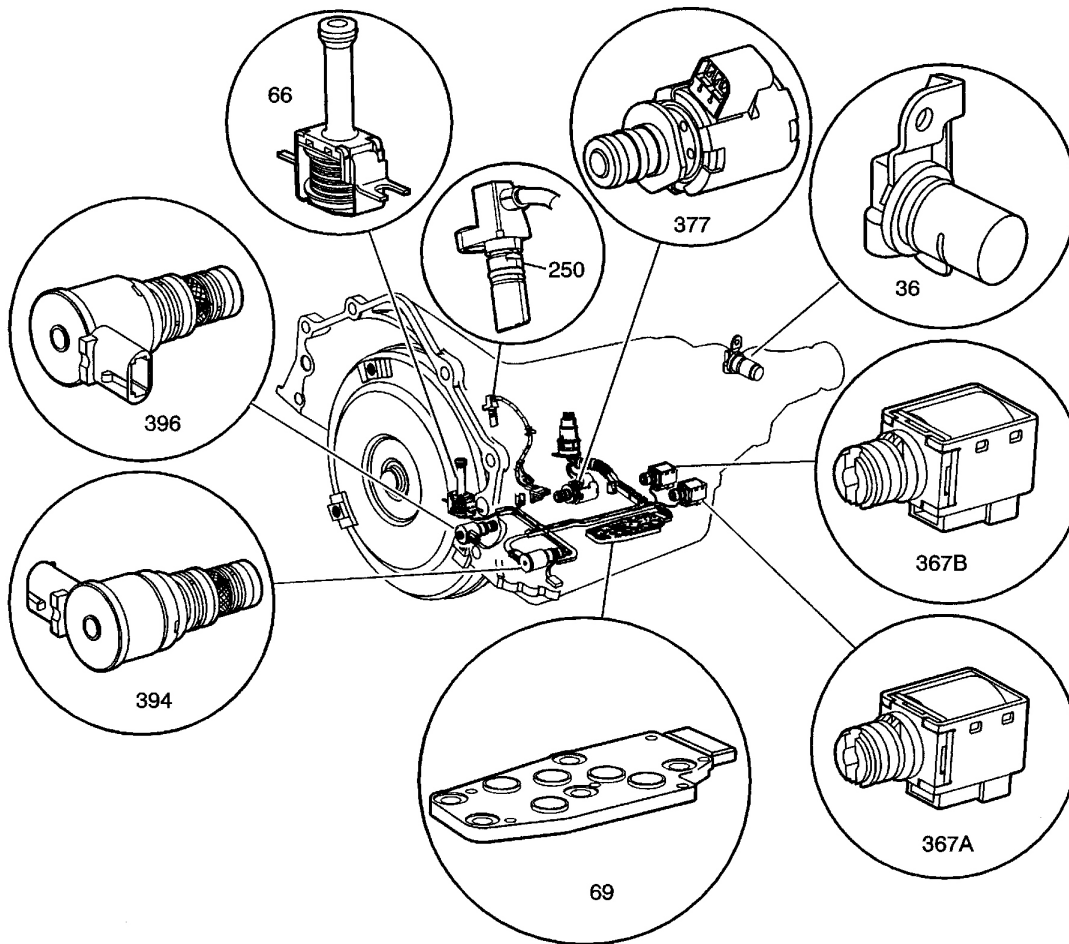

- (36) Vehicle Speed Sensor (VSS) - Model Dependent
- (66) Torque Converter Clutch (TCC) Solenoid Valve
- (69) Automatic Transmission Fluid Pressure (TFP) Manual Valve Position Switch
- (250) Input Speed Sensor (ISS) Assembly - Model Dependent
- (367a) 1-2 Shift Solenoid (SS) Valve
- (367b) 2-3 Shift Solenoid (SS) Valve
- (377) Pressure Control (PC) Solenoid Valve
- (394) 3-2 Shift Solenoid (SS) Valve Assembly
- (396) Torque Converter Clutch Pulse Width Modulation (TCC PWM) Solenoid Valve

G00419105

Fig. 5: Transmission Assembly
Courtesy of GENERAL MOTORS CORP.

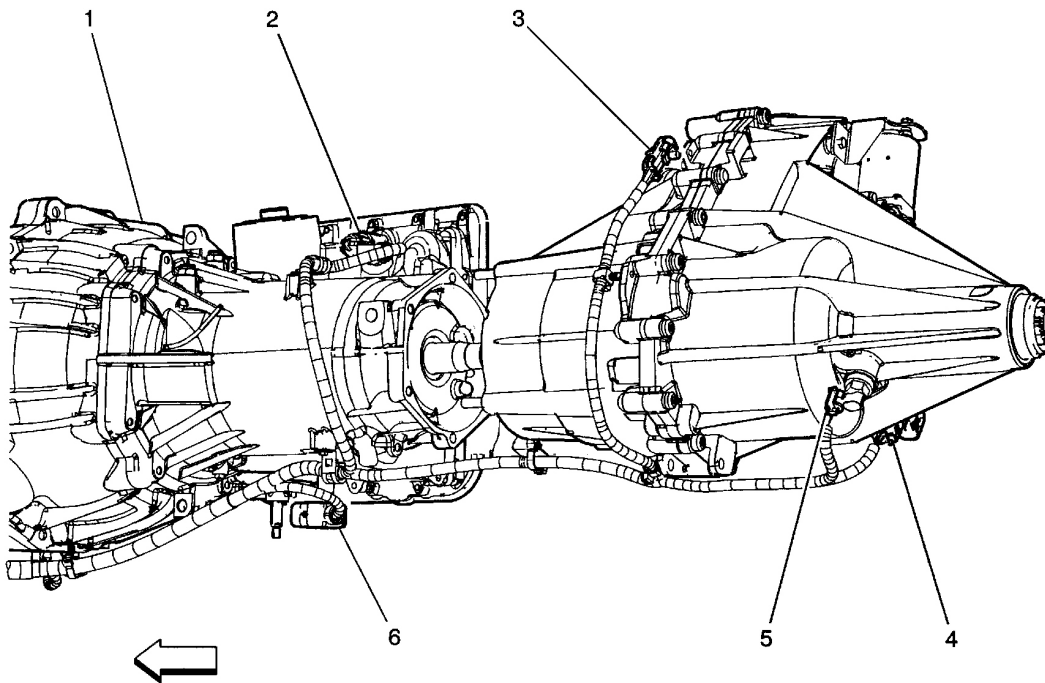

- (1) Transmission Case
- (2) C175 Engine Harness to Transmission Internal Harness
- (3) Heated Oxygen Sensor (HO2S) 2
- (4) Transfer Case Encoder Motor Connector
- (5) Vehicle Speed Sensor (VSS) Connector
- (6) Park / Neutral Position (PNP) Switch

G00419106

Fig. 6: Transmission Assembly
Courtesy of GENERAL MOTORS CORP.

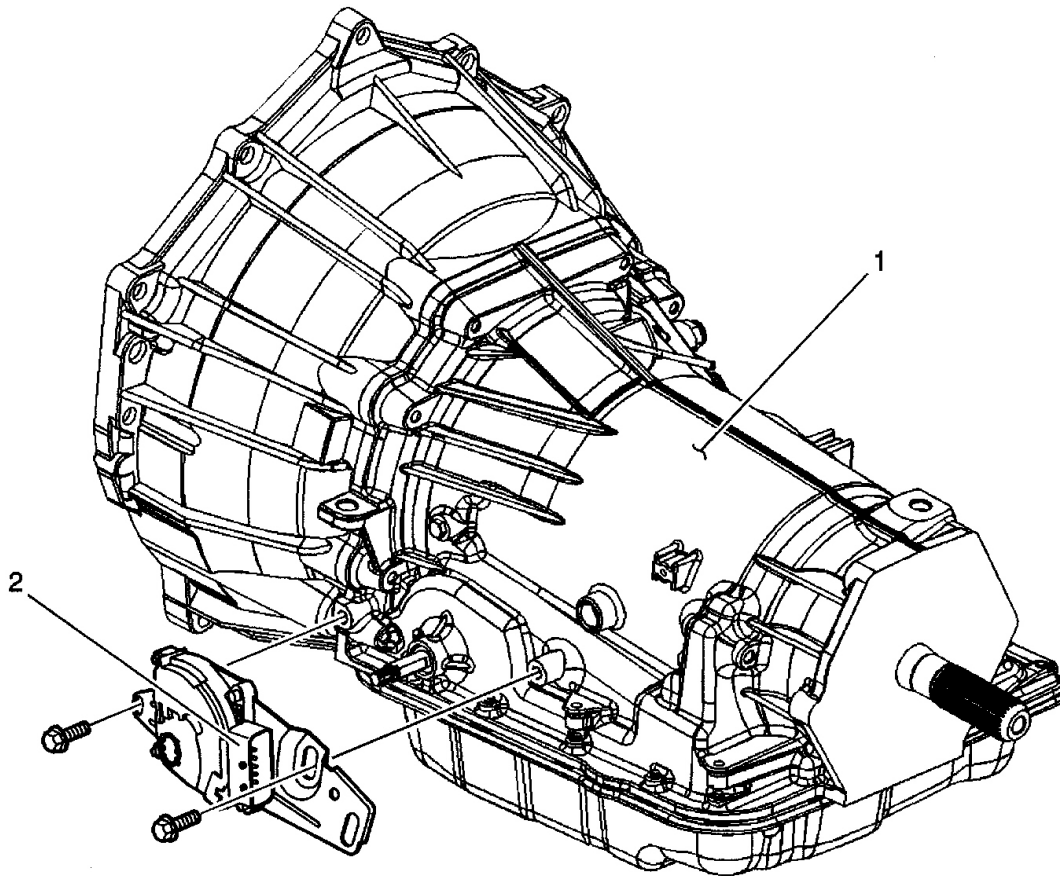

- (1) Automatic Transmission 4L60-E/4L65-E
- (2) Park/Neutral Position (PNP) Switch

G00419107

Fig. 7: Transmission Assembly
Courtesy of GENERAL MOTORS CORP.

2006 Hummer H3

2006 GENERAL MOTORS H3

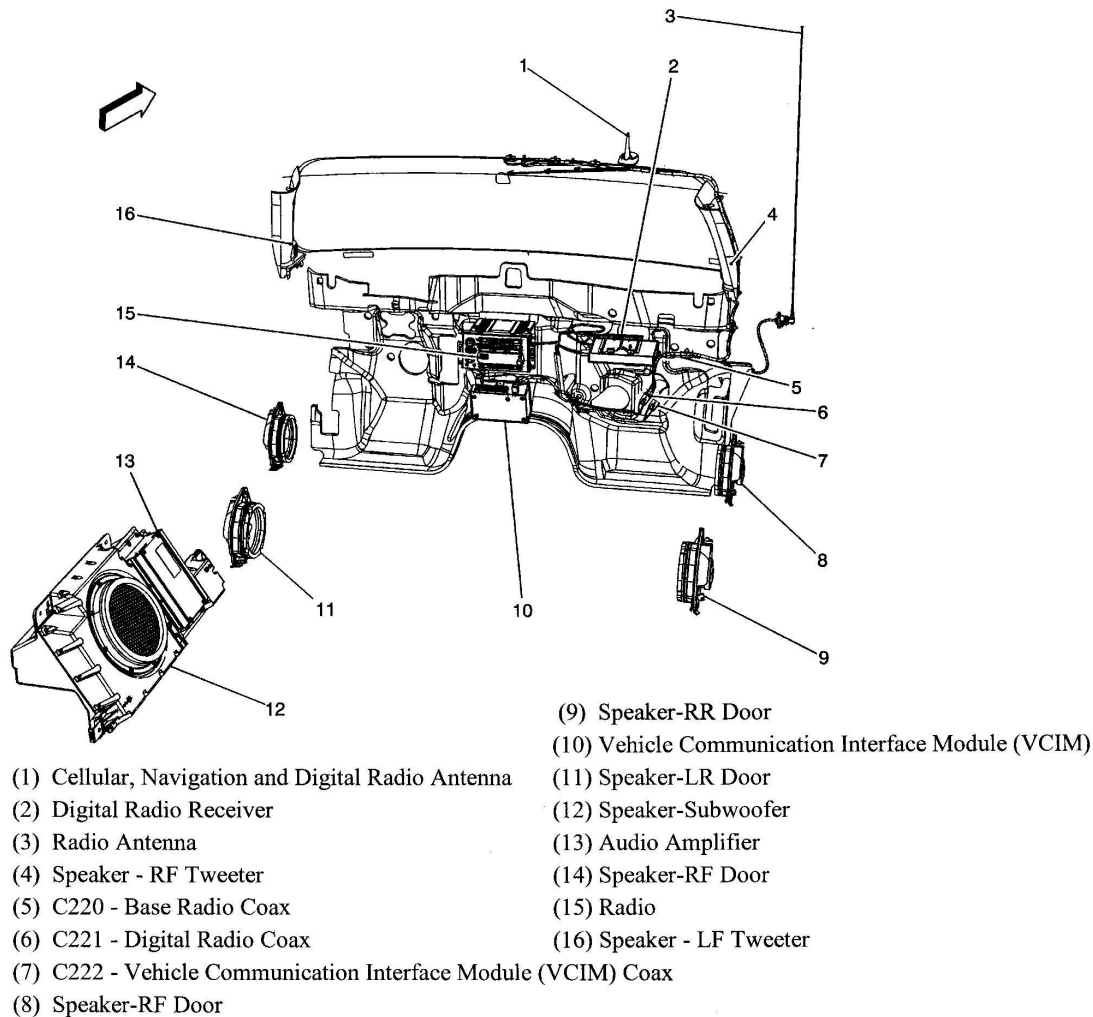

G00419108

Fig. 8: Entertainment Components
Courtesy of GENERAL MOTORS CORP.

2006 Hummer H3

2006 GENERAL MOTORS H3

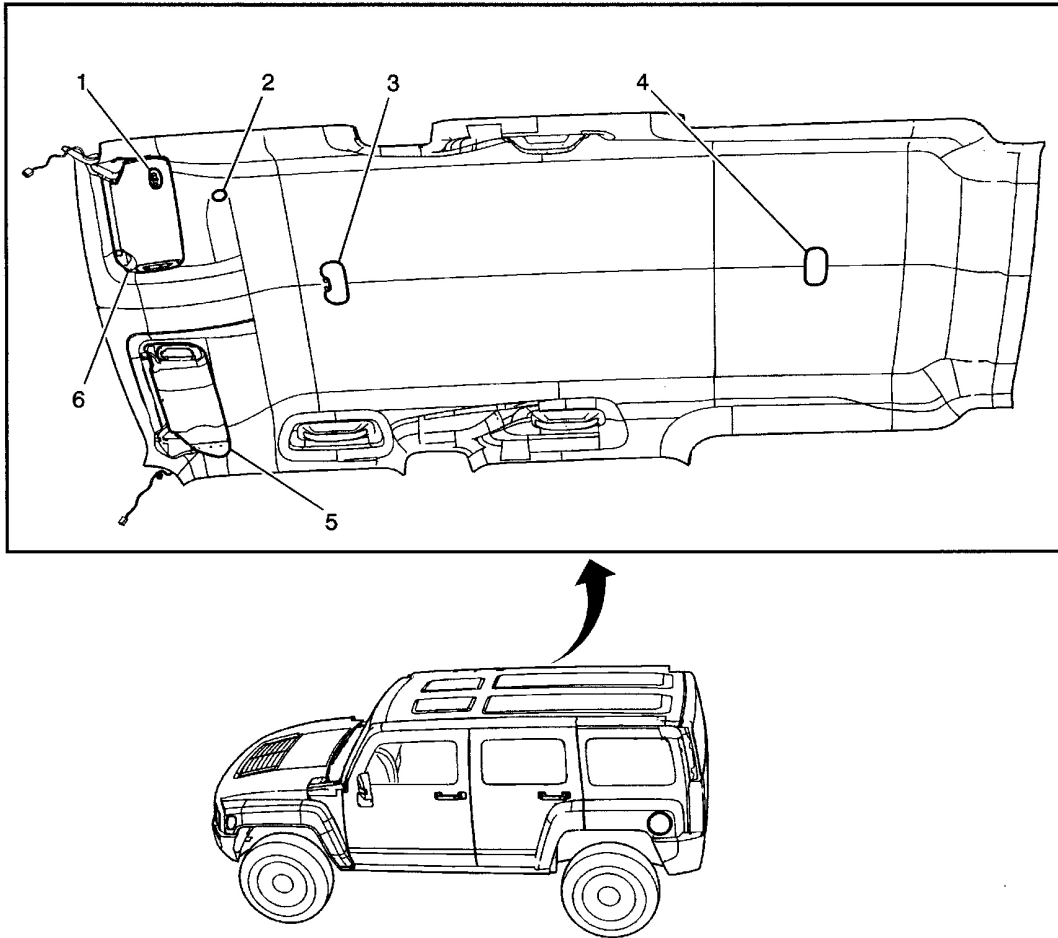

- (1) Garage Door Opener
- (2) Cellular Microphone
- (3) Dome/Reading Lamps
- (4) Dome Lamp
- (5) Sunshade - Right (YC3)
- (6) Sunshade - Left (YC3)

G00419110

Fig. 9: Headliner Components
Courtesy of GENERAL MOTORS CORP.

2006 Hummer H3

2006 GENERAL MOTORS H3

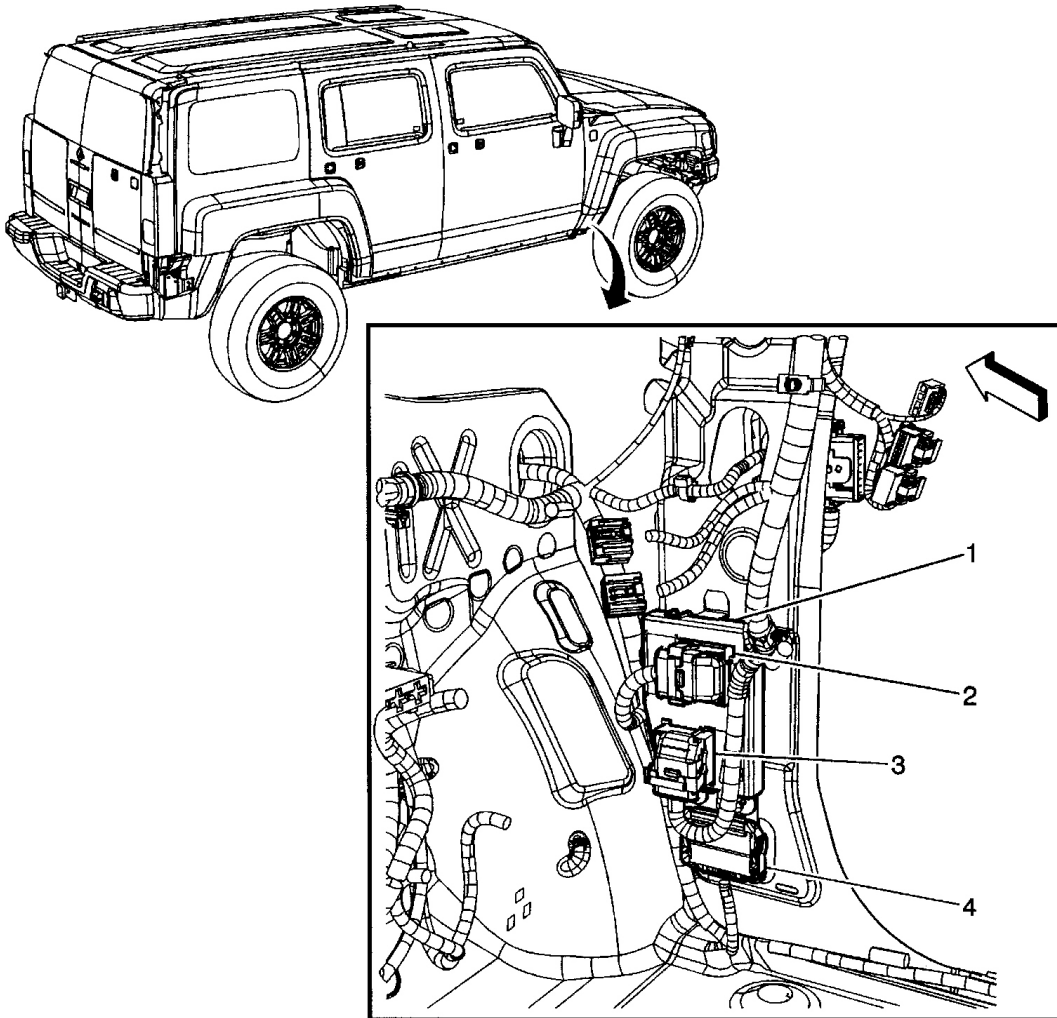

- (1) Body Control Module (BCM)
- (2) Body Control Module (BCM) C1 (Body Harness)
- (3) Body Control Module (BCM) C2 (I/P Harness)
- (4) C204 I/P Harness to Body Harness

G00419111

Fig. 10: Right Front Kick Panel
Courtesy of GENERAL MOTORS CORP.

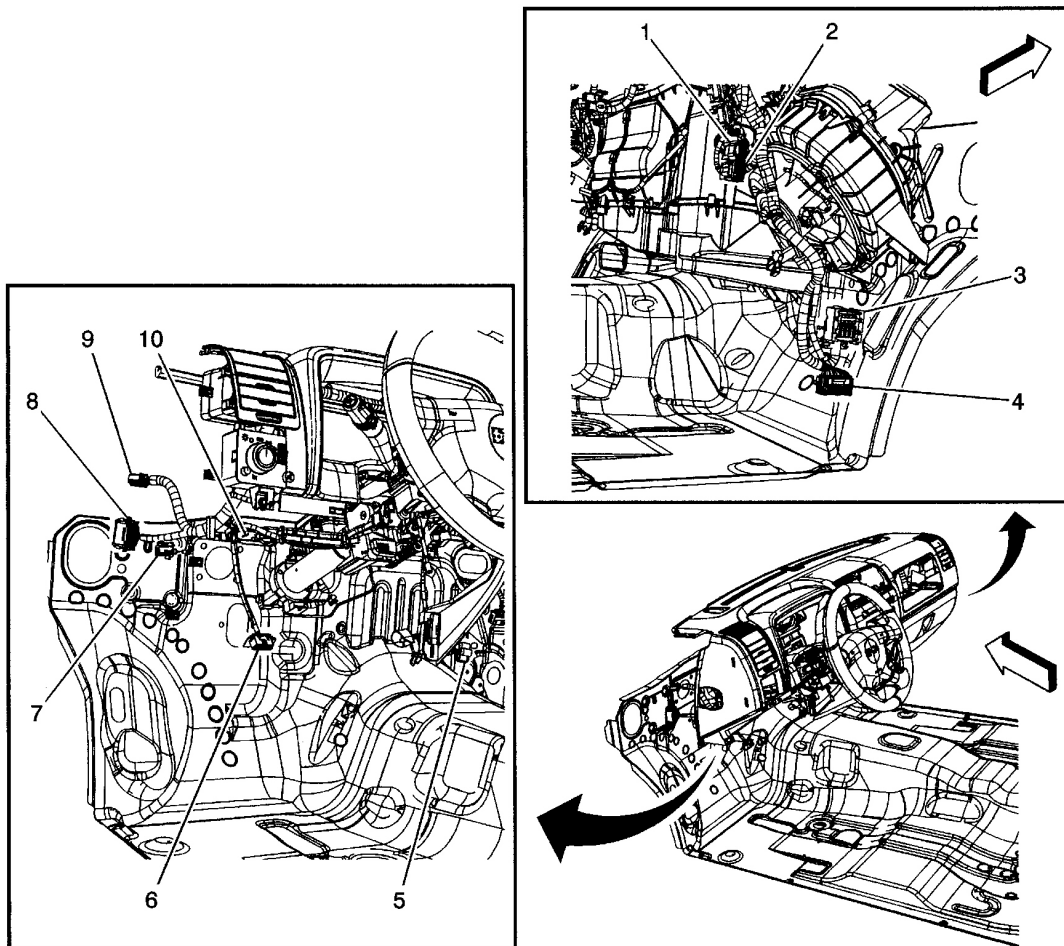

- (1) C203 I/P Harness to HVAC Module Harness
- (2) C205 I/P Harness to HVAC Module Harness
- (3) Body Control Module (BCM) Connector
- (4) C204 I/P Harness to Body Harness
- (5) Trailer Blunt-Cut Harness Wires
- (6) Data Link Connector (DLC)
- (7) C208 I/P Harness to Body Harness
- (8) C200 I/P Harness to Body Harness
- (9) C207 I/P Harness to Body Harness
- (10) C201 I/P Harness to Steering Column Harness

G00419112

Fig. 11: Dash Harness
Courtesy of GENERAL MOTORS CORP.

2006 Hummer H3

2006 GENERAL MOTORS H3

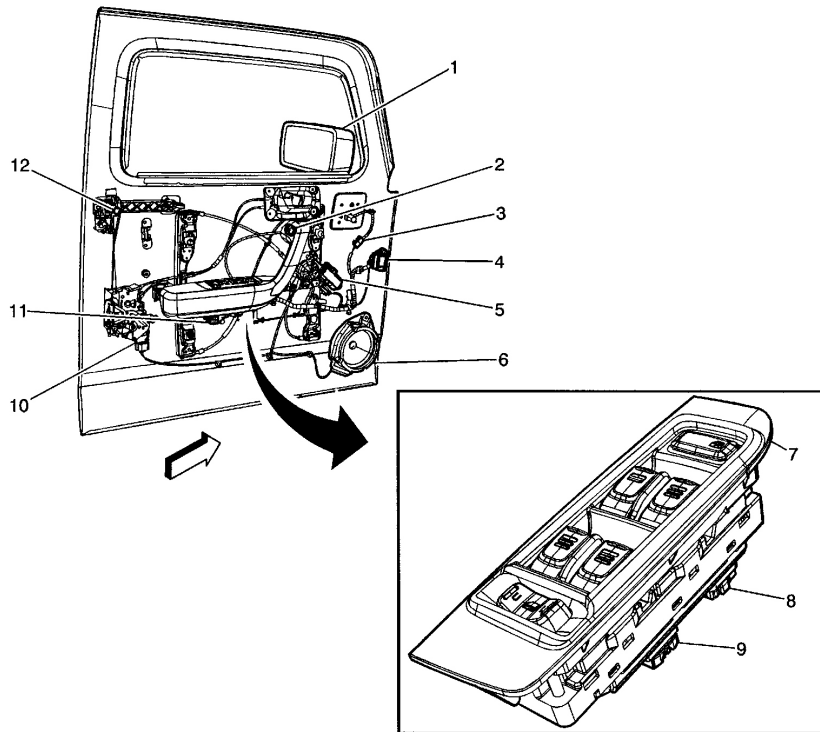

- (1) Outside Rearview Mirror - Driver
- (2) Outside Rearview Mirror Switch
- (3) C510 Driver Door Harness to Outside Rearview Mirror Harness
- (4) C500 Door Harness to Body Harness
- (5) Window Motor - Driver
- (6) Speaker - LF Door
- (7) Door Lock and Window Switch - Driver
- (8) Door Lock and Window Switch - Driver C1
- (9) Door Lock and Window Switch - Driver C2
- (10) Door Lock Actuator - Driver
- (11) Inflatable Restraint Side Impact Sensor (SIS) - Left
- (12) Key Lock Cylinder

G00419113

Fig. 12: Driver Door
Courtesy of GENERAL MOTORS CORP.

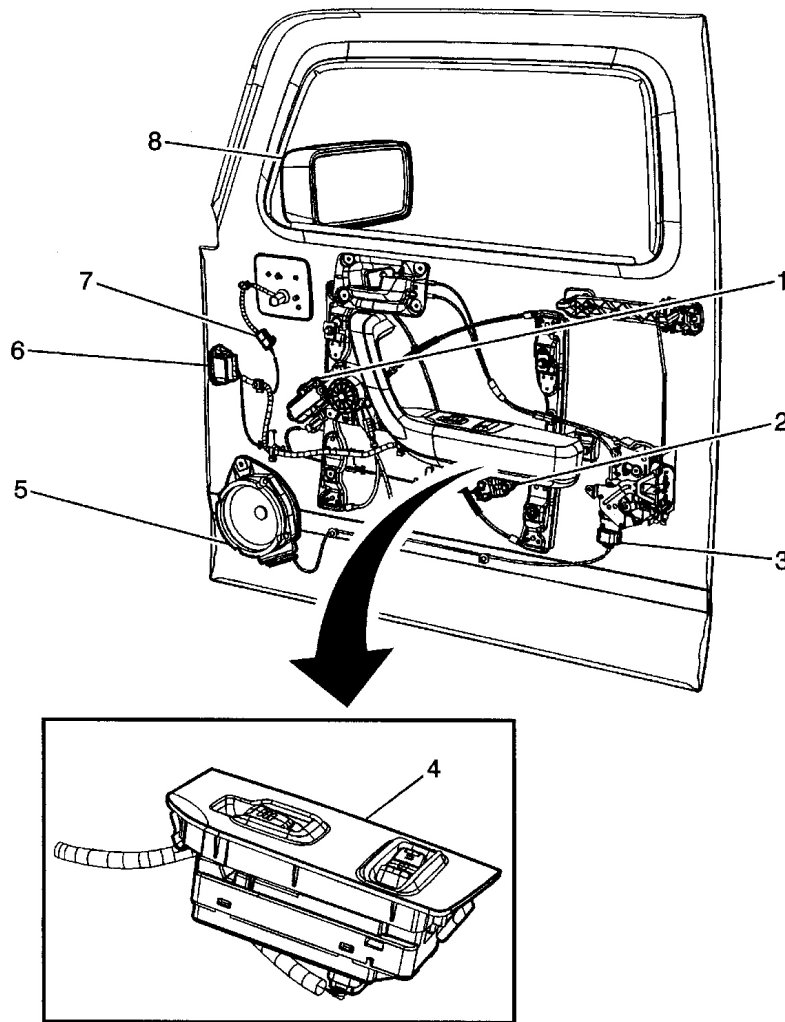

- (1) Window Motor - Passenger
- (2) Inflatable Restraint Side Impact Sensor (SIS) - Right (ASF)
- (3) Door Lock Actuator - Passenger
- (4) Door Lock/Window Switch - Passenger
- (5) Speaker - RF
- (6) C600 Passenger Door Harness to Body Harness
- (7) C610 Passenger Door Harness to Rearview Mirror Harness
- (8) Outside Rearview Mirror - Passenger

G00419114

Fig. 13: Front Passenger's Door
Courtesy of GENERAL MOTORS CORP.

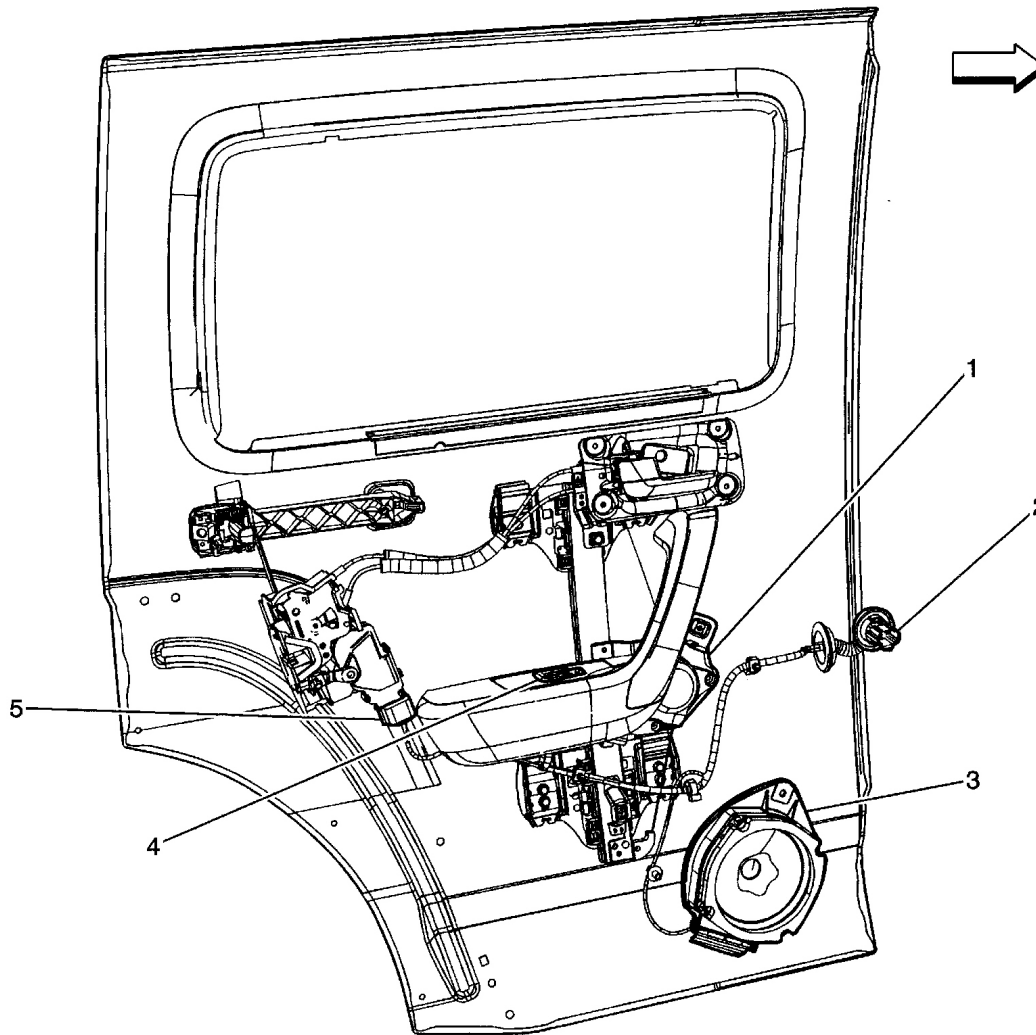

- (1) Window Motor - LR
- (2) C370 Left Rear Door Harness to Body Harness
- (3) Speaker - LR
- (4) Window Switch - LR
- (5) Door Lock Actuator - LR

G00419115

Fig. 14: Left Rear Door
Courtesy of GENERAL MOTORS CORP.

2006 Hummer H3

2006 GENERAL MOTORS H3

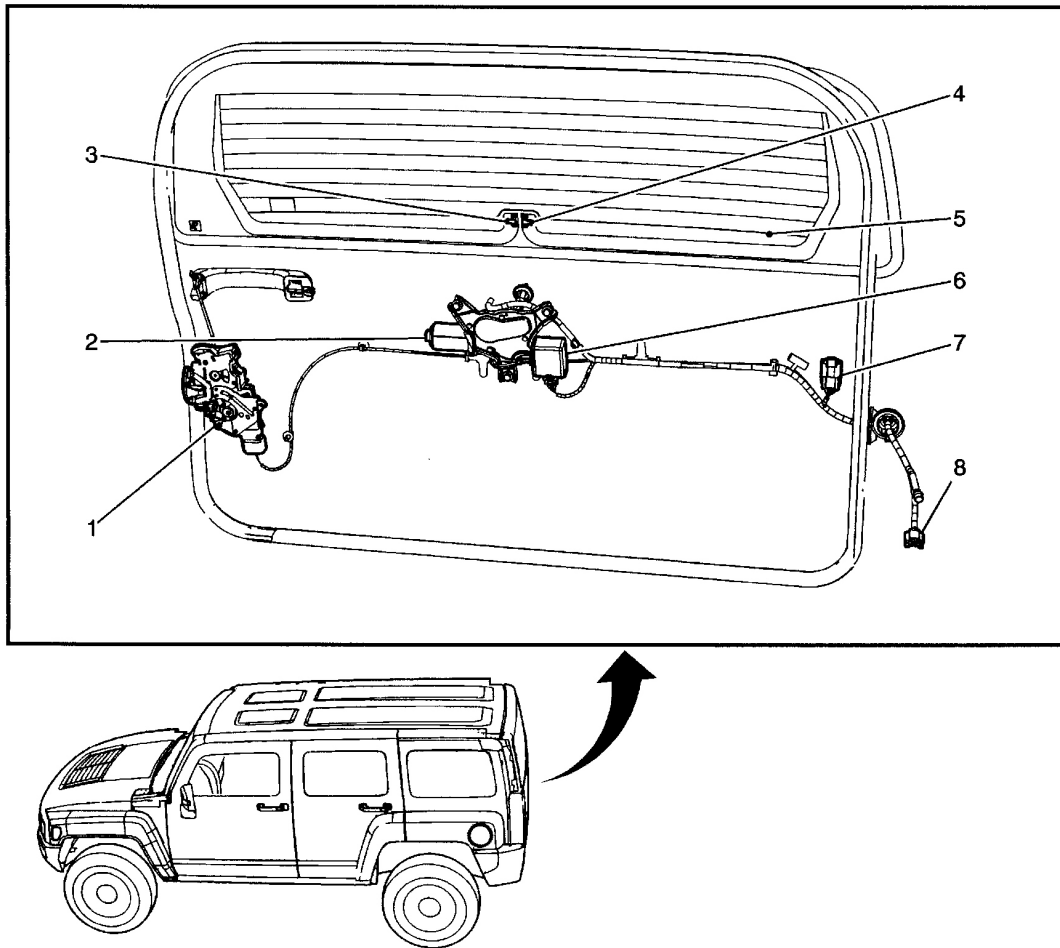

- (1) Door Lock Actuator - Endgate
- (2) Rear Window Wiper Motor
- (3) Rear Window Defogger Connector
- (4) Rear Window Defogger Connector
- (5) Rear Window Defogger
- (6) Rear Window Wiper/Washer Module
- (7) C901 CHMSL Jumper Harness to Endgate Harness
- (8) C450 Body Harness to Endgate Harness

G00419116

Fig. 15: Endgate Components
Courtesy of GENERAL MOTORS CORP.

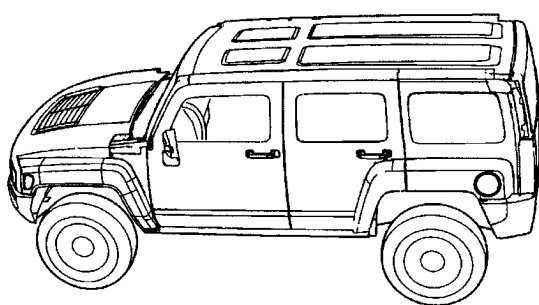
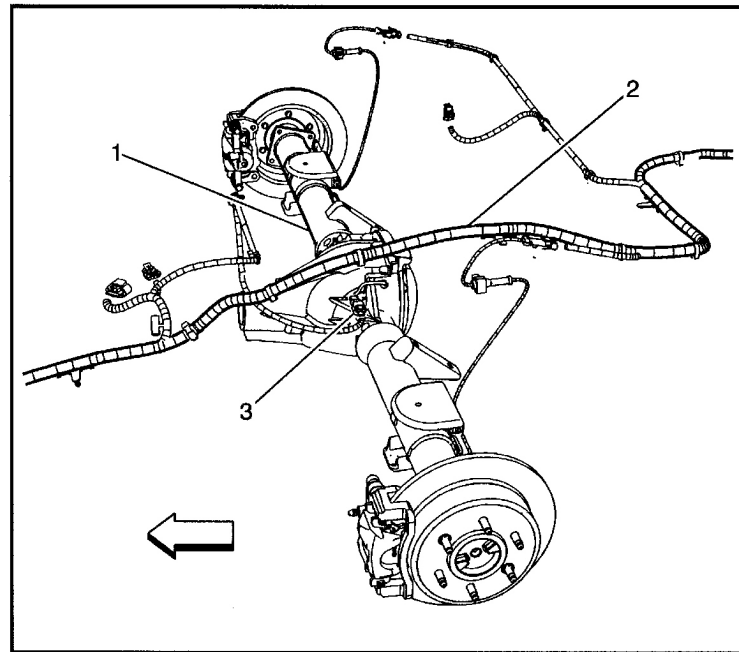

- (1) Rear Axle
- (2) Chassis Harness
- (3) Rear Differential Lock Actuator

G00419117

Fig. 16: Rear Axle Assembly
Courtesy of GENERAL MOTORS CORP.

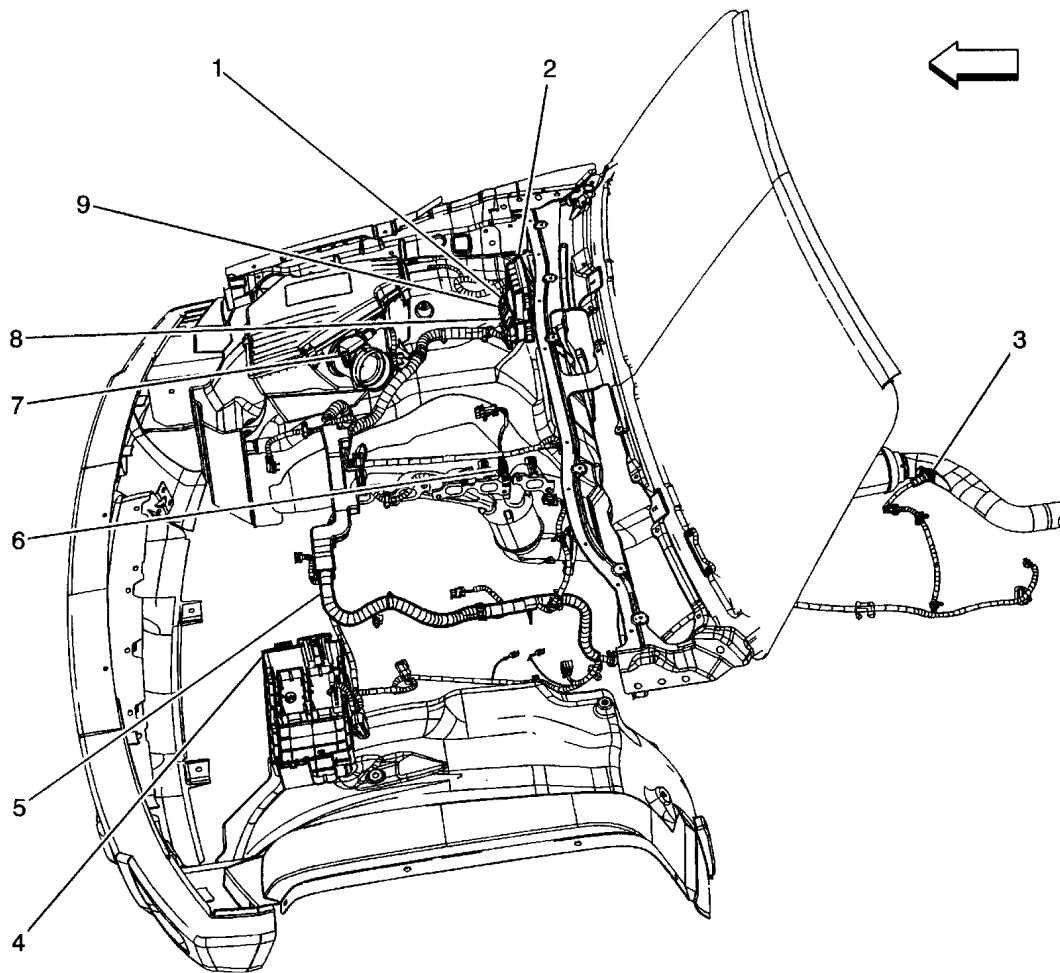

- (1) Powertrain Control Module C1 (Body Harness)
- (2) Powertrain Control Module
- (3) Heated Oxygen Sensor (HO2S) 2
- (4) Fuse Block - Underhood
- (5) Engine Harness
- (6) Heated Oxygen Sensor (HO2S) 1
- (7) Mass Air Flow (MAF)/Intake Air Temperature (IAT) Sensor
- (8) Powertrain Control Module C3 (Engine Harness)
- (9) Powertrain Control Module C2 (Engine Harness)

G00419118

Fig. 17: Engine Compartment
Courtesy of GENERAL MOTORS CORP.

2006 Hummer H3

2006 GENERAL MOTORS H3

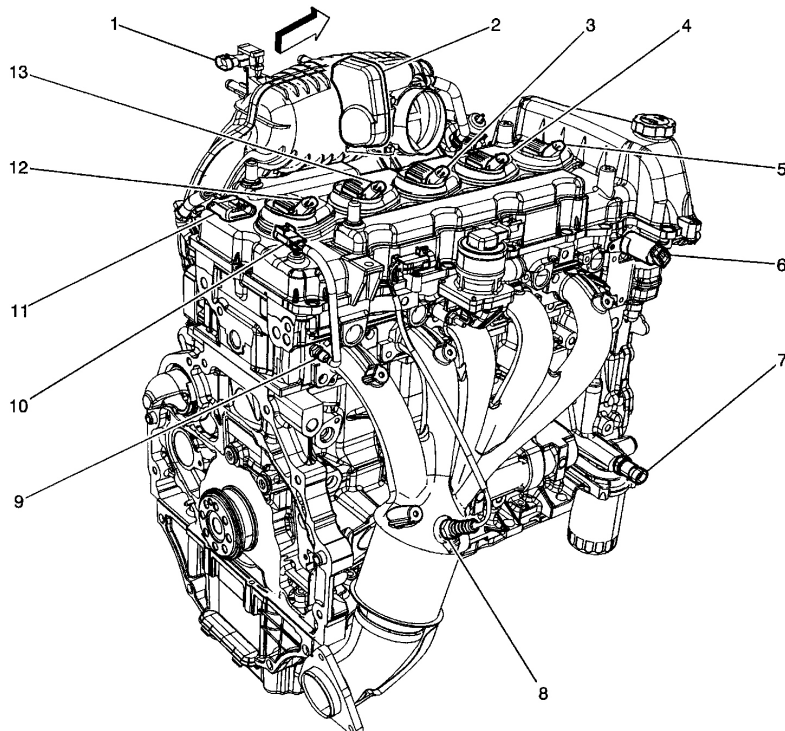

- | | |
|--|--|
| (1) Manifold Absolute Pressure (MAP) Sensor | (9) Engine Coolant Temperature (ECT) Sensor |
| (2) Throttle Body | (10) Engine Coolant Temperature (ECT) Sensor Connector |
| (3) Ignition Coil 3 | (11) C101 Fuel Injector Harness to Engine Harness |
| (4) Ignition Coil 2 | (12) Ignition Coil 5 |
| (5) Ignition Coil 1 | (13) Ignition Coil 4 |
| (6) Camshaft Position (CMP) Actuator Solenoid - Bank 1 Exhaust | |
| (7) Engine Oil Pressure (EOP) Switch | |
| (8) Heated Oxygen Sensor (HO2S) 1 | |

G00419119

Fig. 18: Right Side Of Engine Assembly
Courtesy of GENERAL MOTORS CORP.

2006 Hummer H3

2006 GENERAL MOTORS H3

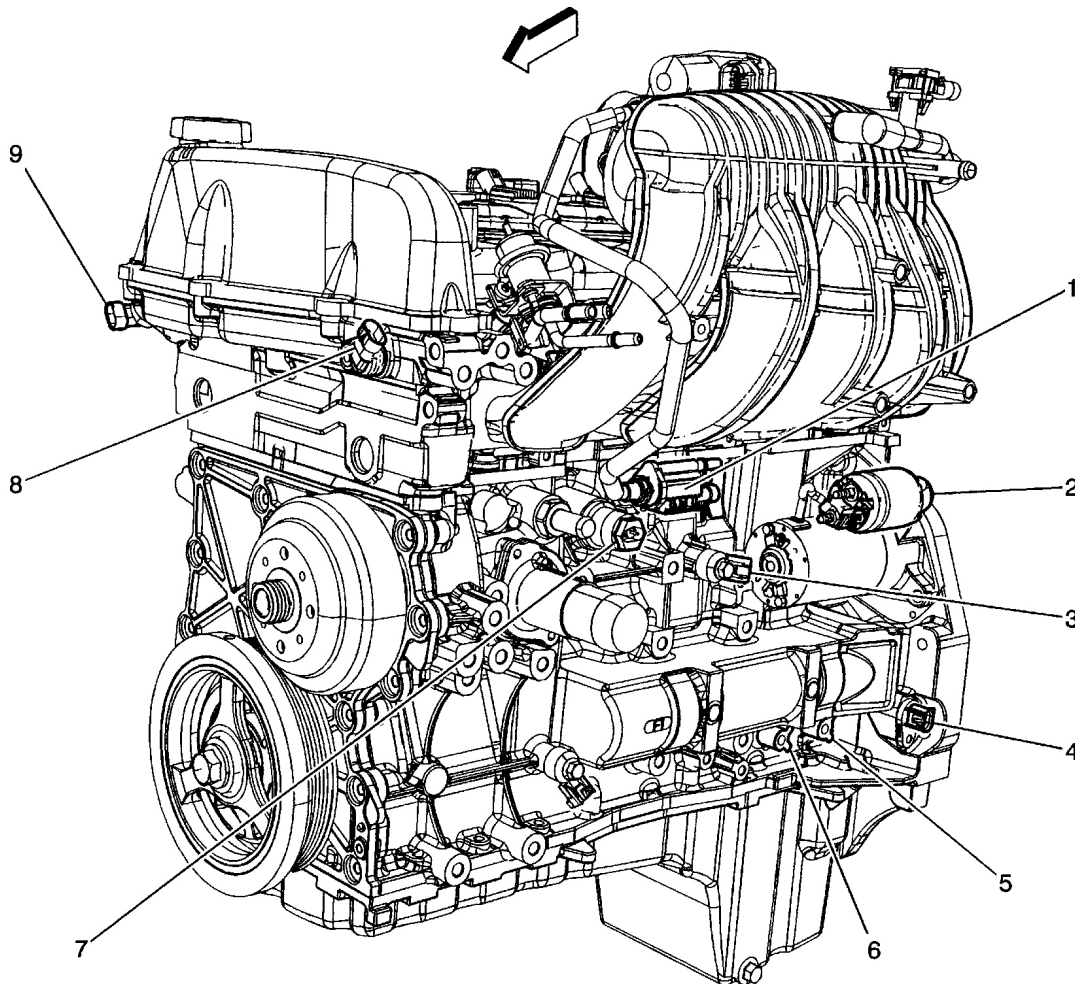

- (1) Evaporative Emission (EVAP) Canister Purge Solenoid Valve
- (2) Starter Solenoid
- (3) Knock Sensor (KS) Bank 2
- (4) Crankshaft Position (CKP) Sensor
- (5) G102
- (6) G103
- (7) Engine Block Heater
- (8) Camshaft Position (CMP) Sensor - Intake
- (9) Camshaft Position (CMP) Sensor - Exhaust

G00419120

Fig. 19: Left Side Of Engine
Courtesy of GENERAL MOTORS CORP.

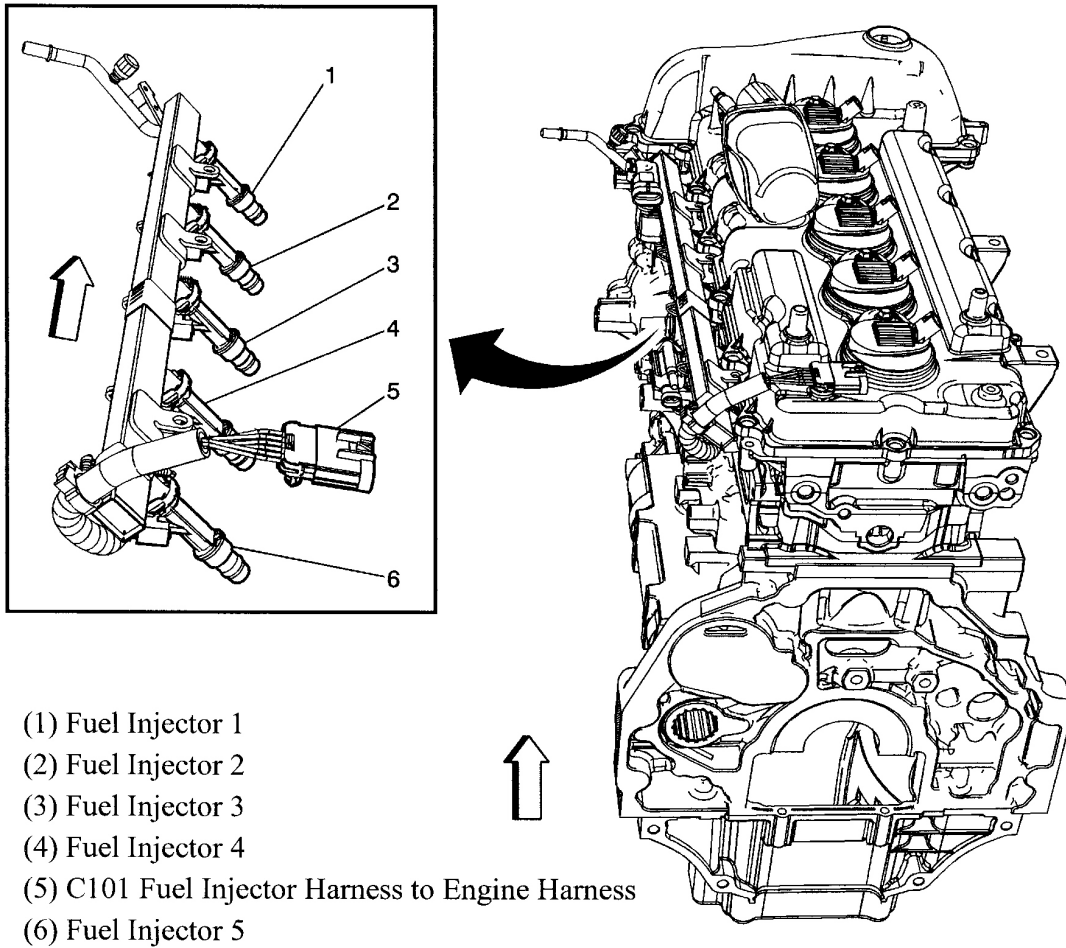

G00419121

Fig. 20: Top Of Engine
Courtesy of GENERAL MOTORS CORP.

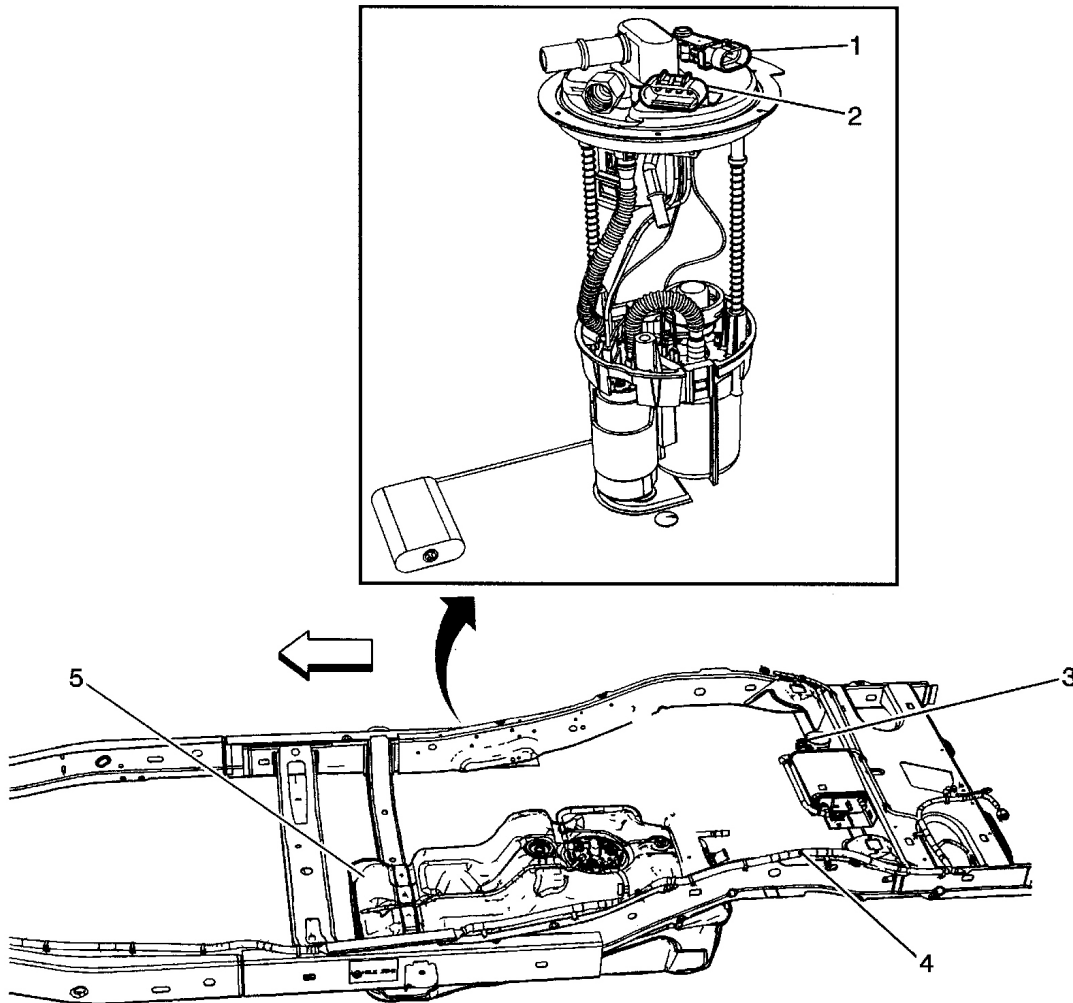

- (1) Fuel Tank Pressure (FTP) Sensor Connector
- (2) Fuel Pump and Sender Assembly
- (3) Evaporative Emission (EVAP) Canister Vent Solenoid Valve
- (4) Chassis Harness
- (5) Fuel Tank

G00419122

Fig. 21: Frame Rail
Courtesy of GENERAL MOTORS CORP.

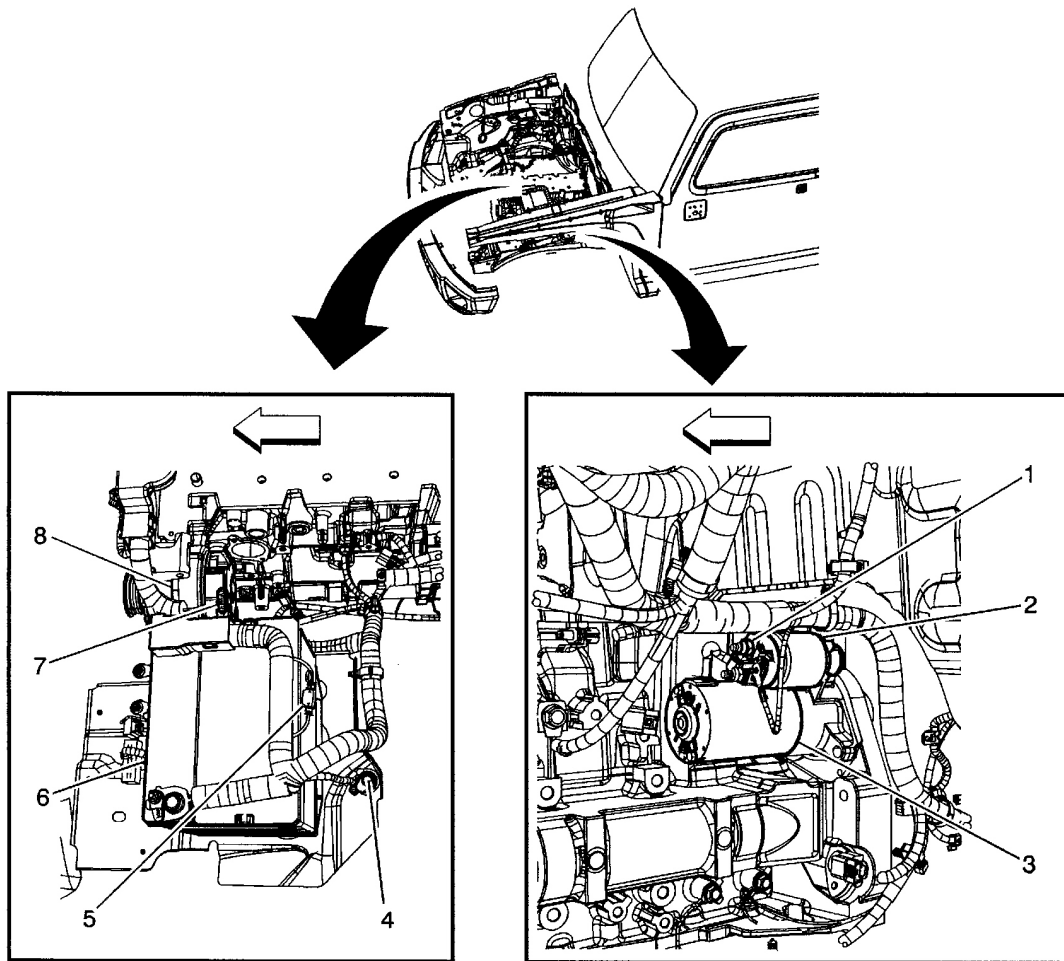

- (1) Battery Positive Cable
- (2) Starter Solenoid
- (3) Starter Motor
- (4) G100
- (5) OnStar Fuse
- (6) Battery
- (7) Generator Connector
- (8) Generator

G00419123

Fig. 22: Engine Electrical Components
Courtesy of GENERAL MOTORS CORP.

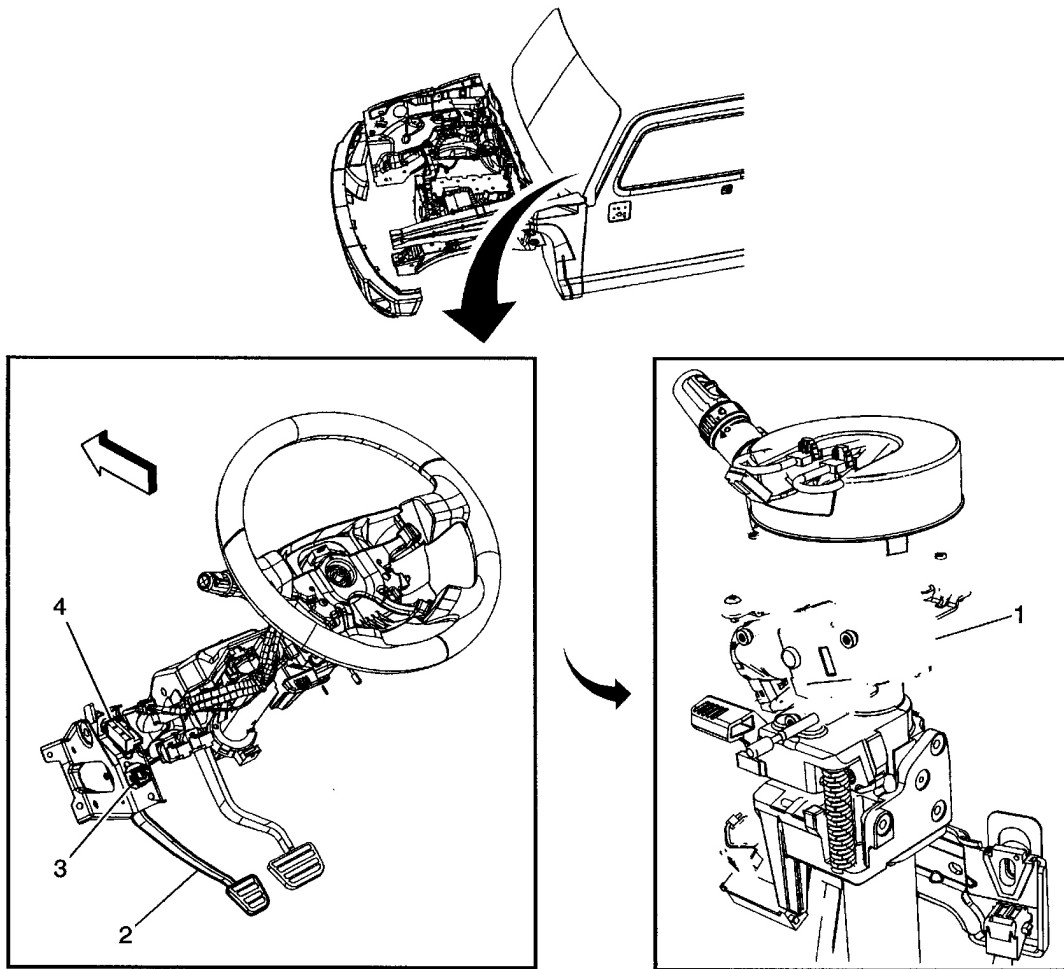

- (1) Ignition Switch
- (2) Clutch Pedal (MA5)
- (3) Clutch Release Switch (MA5)
- (4) Clutch Start Switch (MA5)

G00419124

Fig. 23: Engine Electrical Components
Courtesy of GENERAL MOTORS CORP.

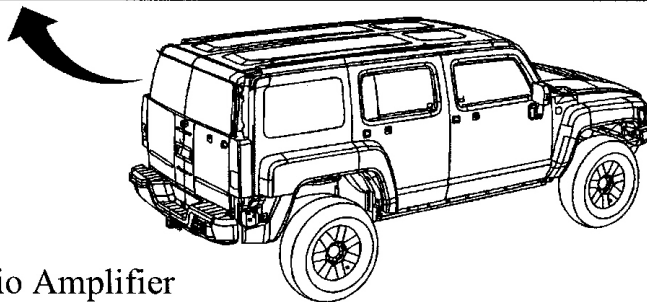
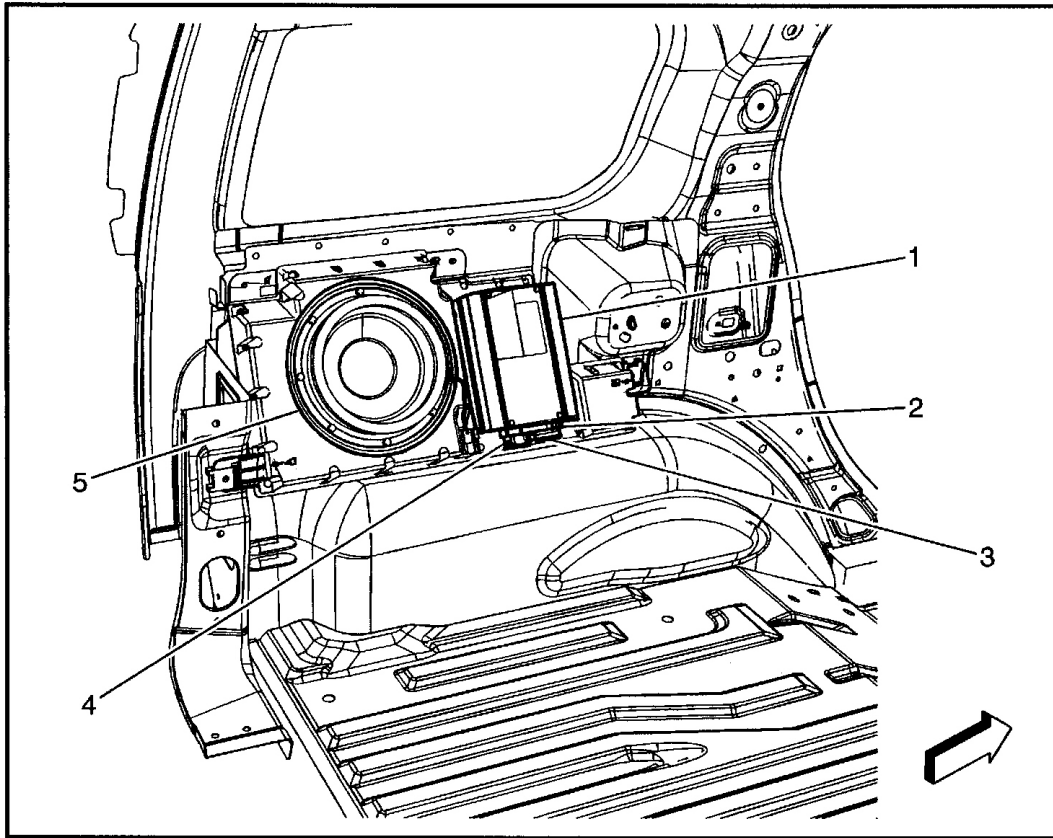

- (1) Audio Amplifier
- (2) Audio Amplifier - C1
- (3) Audio Amplifier - C2
- (4) Audio Amplifier - C3
- (5) Speaker - Subwoofer

G00419125

Fig. 24: Left Rear Of Cargo Area
Courtesy of GENERAL MOTORS CORP.

2006 Hummer H3

2006 GENERAL MOTORS H3

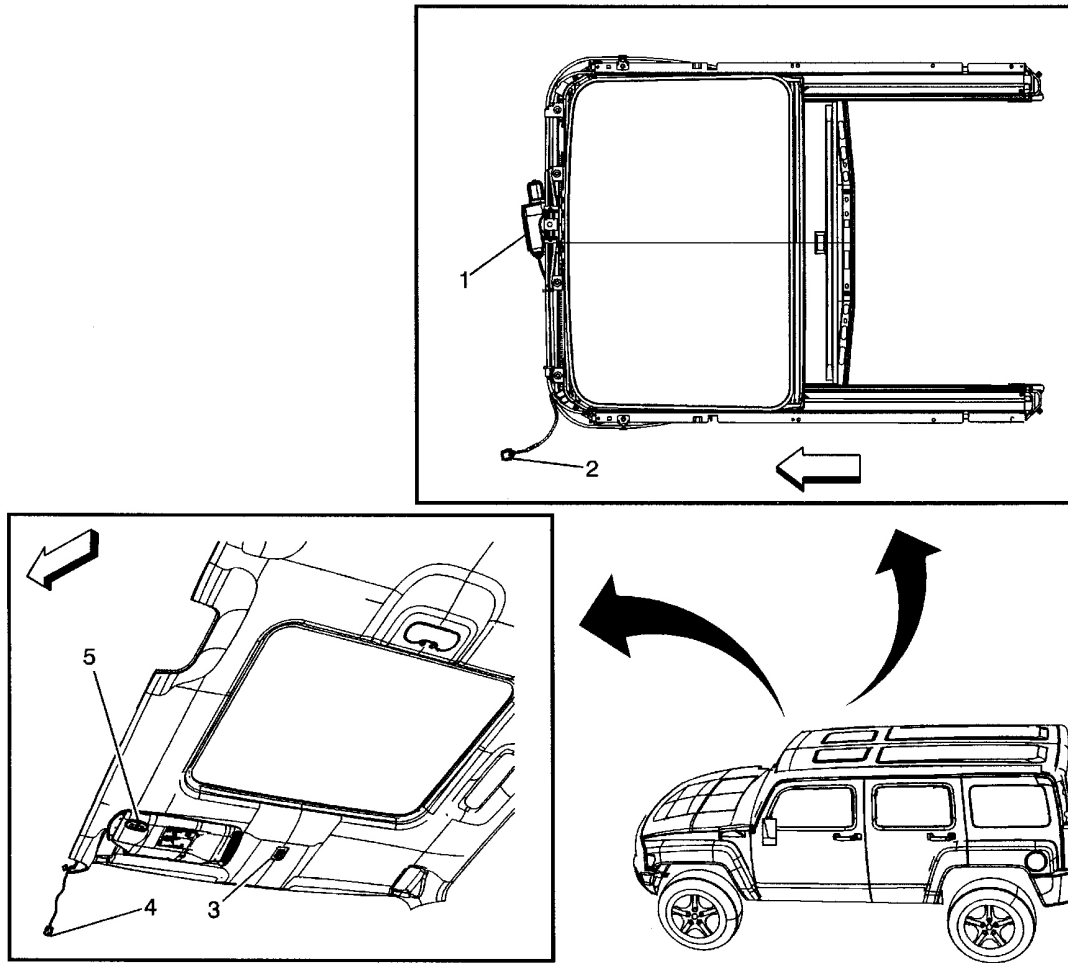

- (1) Sunroof Motor
- (2) C330 Sunroof Jumper Harness to Body Harness
- (3) Sunroof Switch
- (4) C335 Sunroof Jumper Harness to Body Harness
- (5) Garage Door Opener

G00419126

Fig. 25: Sunroof Component Views
Courtesy of GENERAL MOTORS CORP.

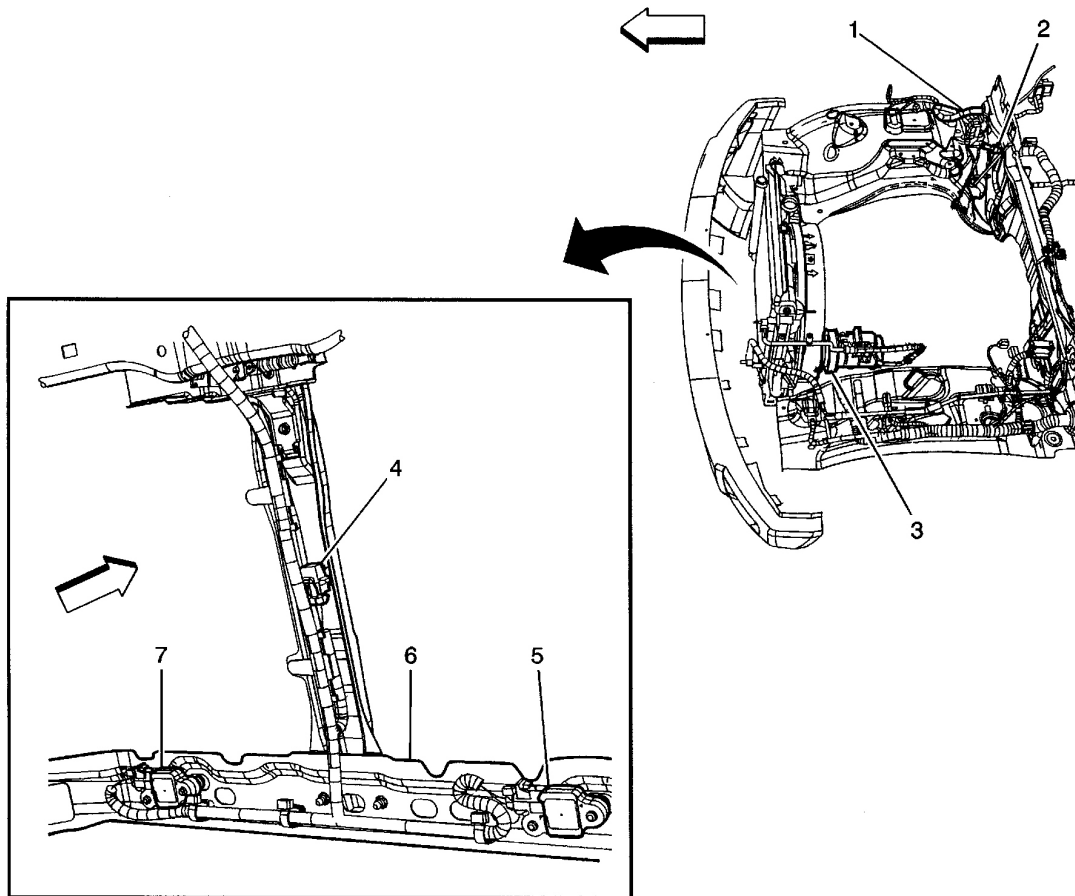

- (1) Body Harness
- (2) A/C Refrigerant Pressure Sensor
- (3) A/C Compressor Clutch
- (4) Ambient Air Temperature Sensor
- (5) Inflatable Restraint Front End Sensor - Right
- (6) Lower Radiator Support
- (7) Inflatable Restraint Front End Sensor - Left

G00419127

Fig. 26: Engine Compartment
Courtesy of GENERAL MOTORS CORP.

2006 Hummer H3

2006 GENERAL MOTORS H3

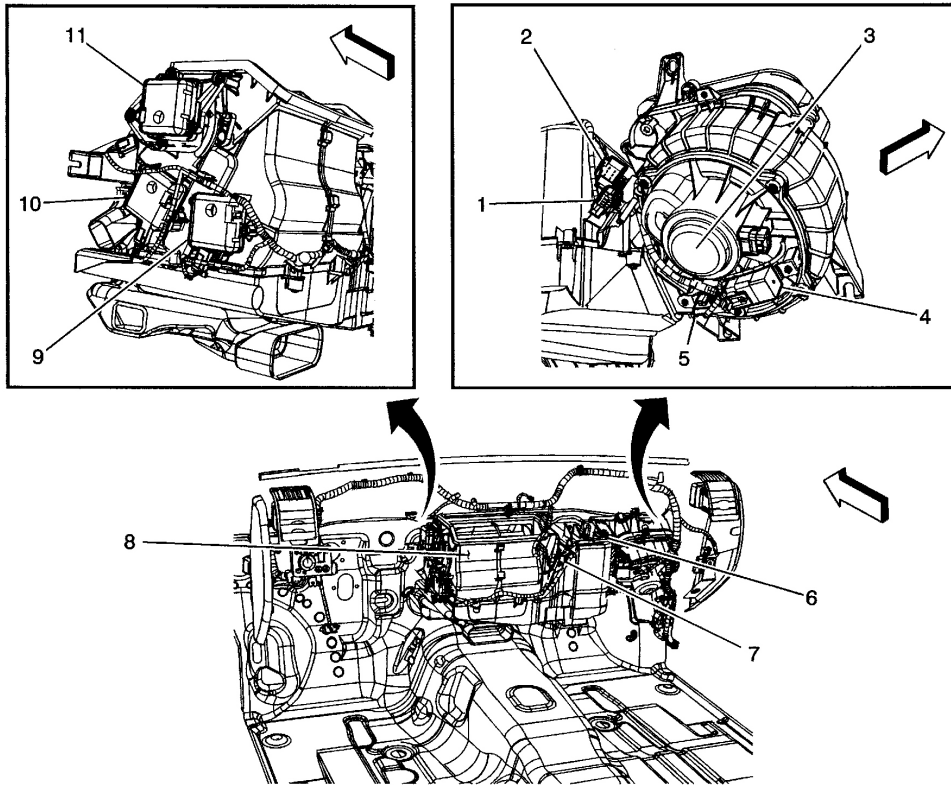

- (1) C205 HVAC Harness to I/P Harness
- (2) C203 Blower Motor Resistor Harness to I/P Harness
- (3) Blower Motor
- (4) High Speed Blower Motor Relay
- (5) Blower Motor Resistor Assembly
- (6) Recirculation Actuator
- (7) Evaporator Temperature Sensor
- (8) HVAC Module
- (9) Air Temperature Actuator - Right
- (10) Air Temperature Actuator - Left
- (11) Mode Actuator

G00419128

Fig. 27: HVAC Components
Courtesy of GENERAL MOTORS CORP.

2006 Hummer H3

2006 GENERAL MOTORS H3

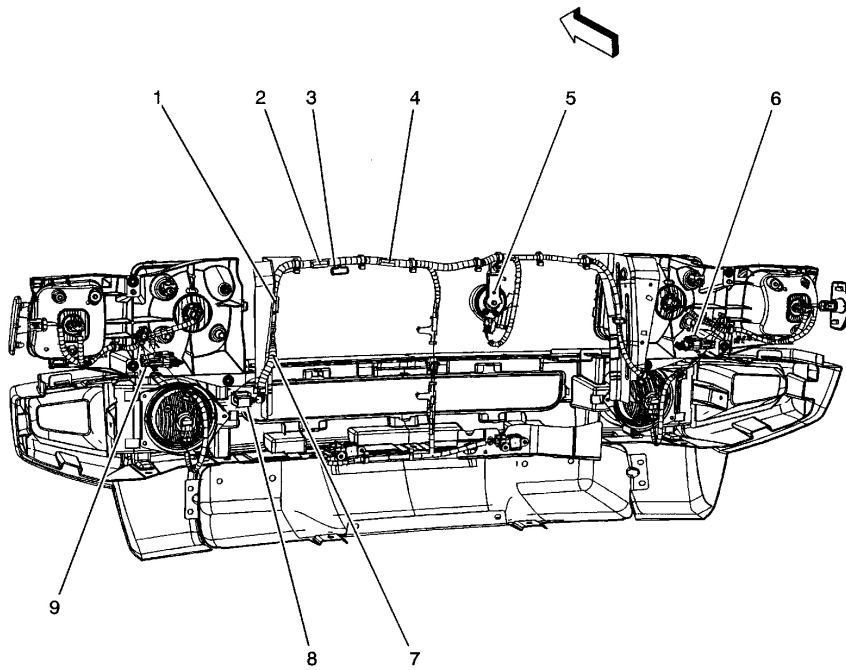

- | | |
|--|--|
| (1) S185 | (7) S134 |
| (2) S109 | (8) C115 Forward Lamp Harness to Body Harness |
| (3) S112 | (9) C116 Forward Lamp Harness to Headlamp Jumper Harness |
| (4) S120 | |
| (5) Horn | |
| (6) C117 Forward Lamp Harness to Headlamp Jumper Harness | |

G00419129

Fig. 28: Forward Lamp Harness
Courtesy of GENERAL MOTORS CORP.

2006 Hummer H3

2006 GENERAL MOTORS H3

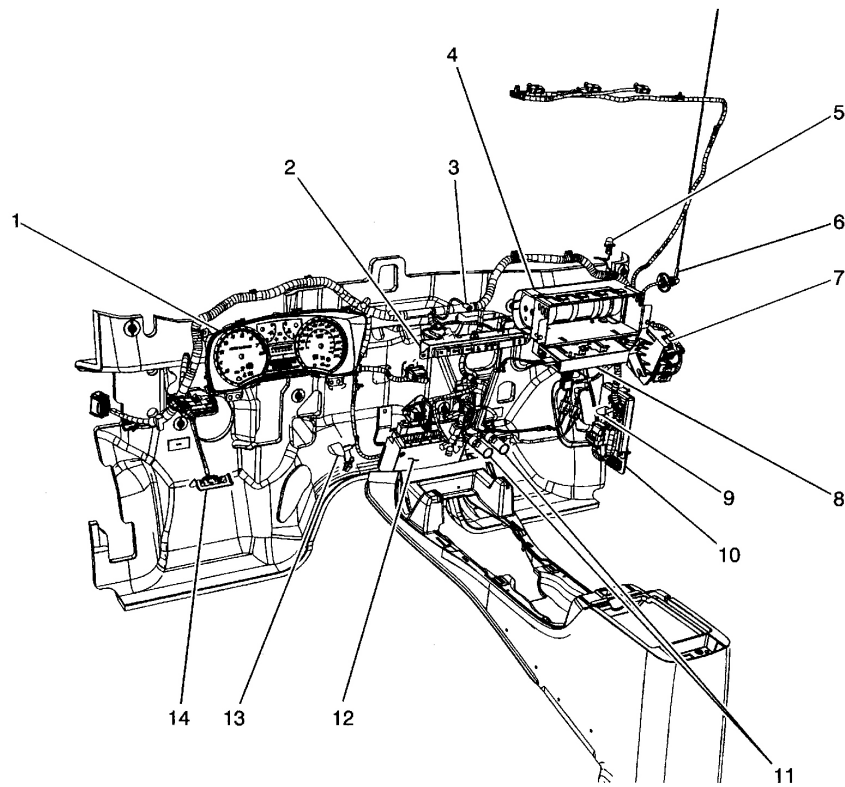

- | | |
|--|--|
| (1) Instrument Panel Cluster (IPC) | (9) Courtesy Lamp Footwell - Right |
| (2) Accessory Switch | (10) Body Control Module (BCM) |
| (3) Hazard Switch | (11) Auxiliary Power Outlets - Front |
| (4) Inflatable Restraint I/P Module | (12) Vehicle Communication Interface Module (VCIM) |
| (5) Ambient Light Sensor | (13) Courtesy Lamp Footwell - Left |
| (6) Antenna - Base | (14) Data Link Connector (DLC) |
| (7) Transfer Case Shift Control Module | |
| (8) Digital Radio Receiver | |

G00419130

Fig. 29: Dash Harness
Courtesy of GENERAL MOTORS CORP.

2006 Hummer H3

2006 GENERAL MOTORS H3

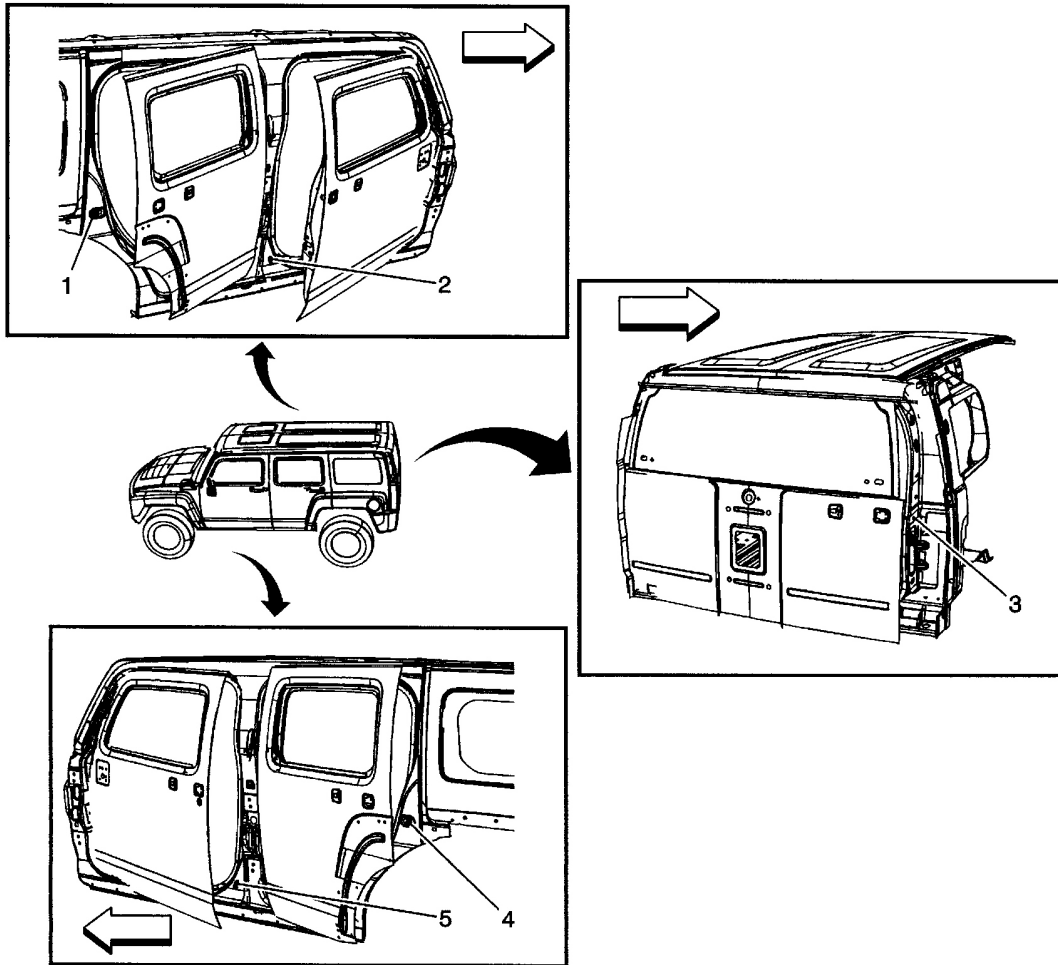

- (1) Door Ajar Switch - RR
- (2) Door Ajar Switch - Passenger
- (3) Endgate Ajar Switch
- (4) Door Ajar Switch - LR
- (5) Door Ajar Switch - Driver

G00419131

Fig. 30: Vehicle Overview
Courtesy of GENERAL MOTORS CORP.

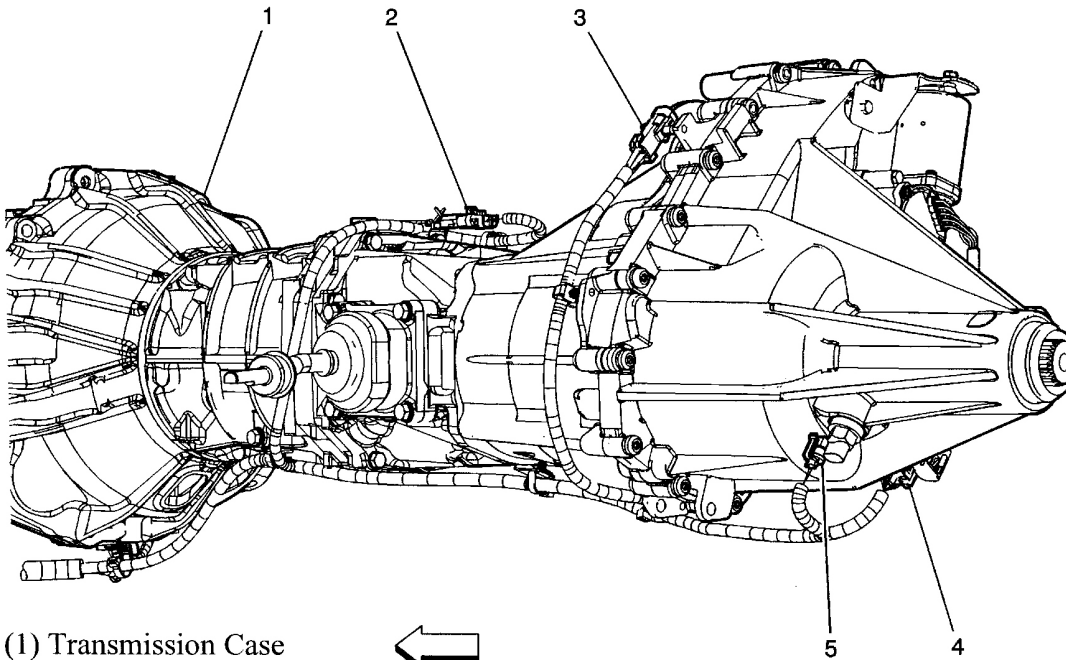

- (1) Transmission Case
- (2) Backup Lamp Switch
- (3) Heated Oxygen Sensor (HO2S) 2
- (4) Transfer Case Encoder Motor Connector
- (5) Vehicle Speed Sensor (VSS) Connector

G00419132

Fig. 31: Transmission Assembly
Courtesy of GENERAL MOTORS CORP.

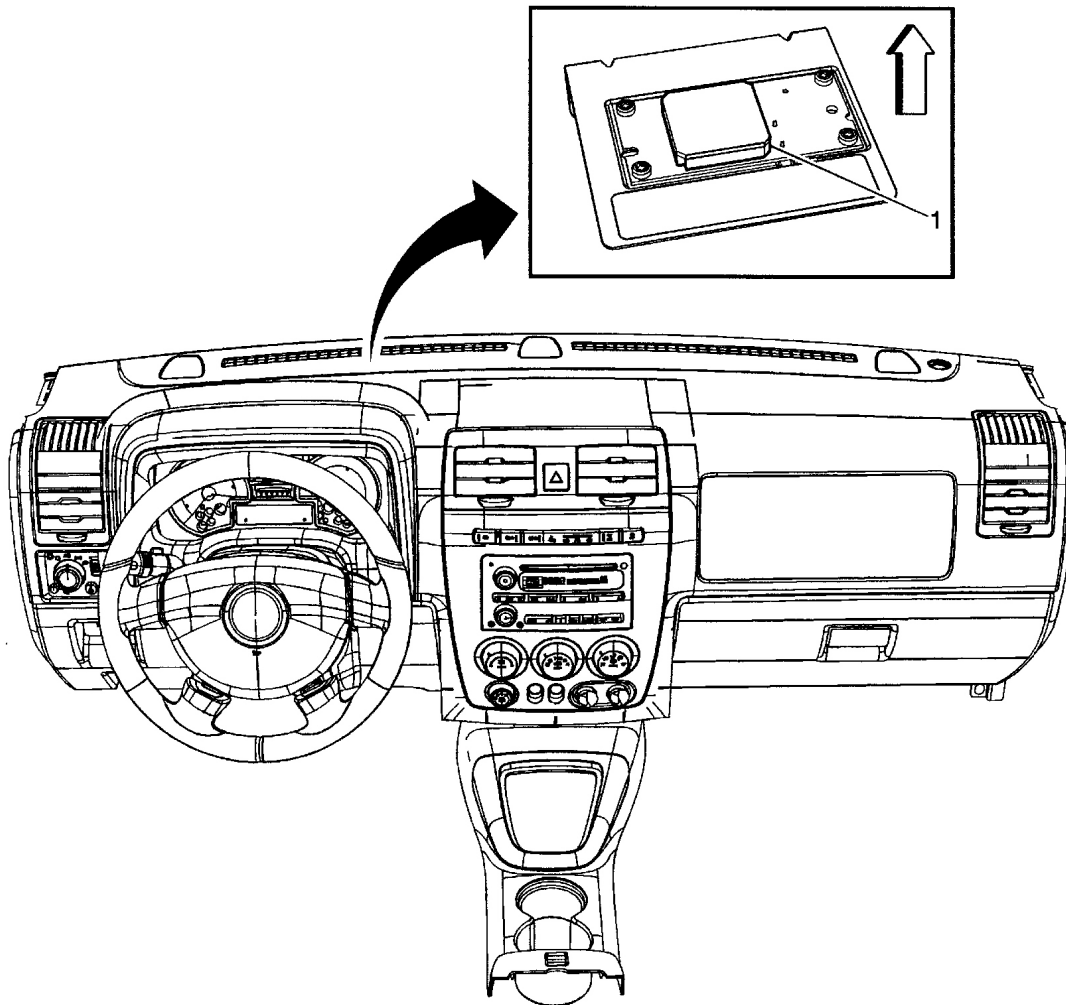

(1) Global Positioning System (GPS) Antenna

G00419133

Fig. 32: Dash
Courtesy of GENERAL MOTORS CORP.

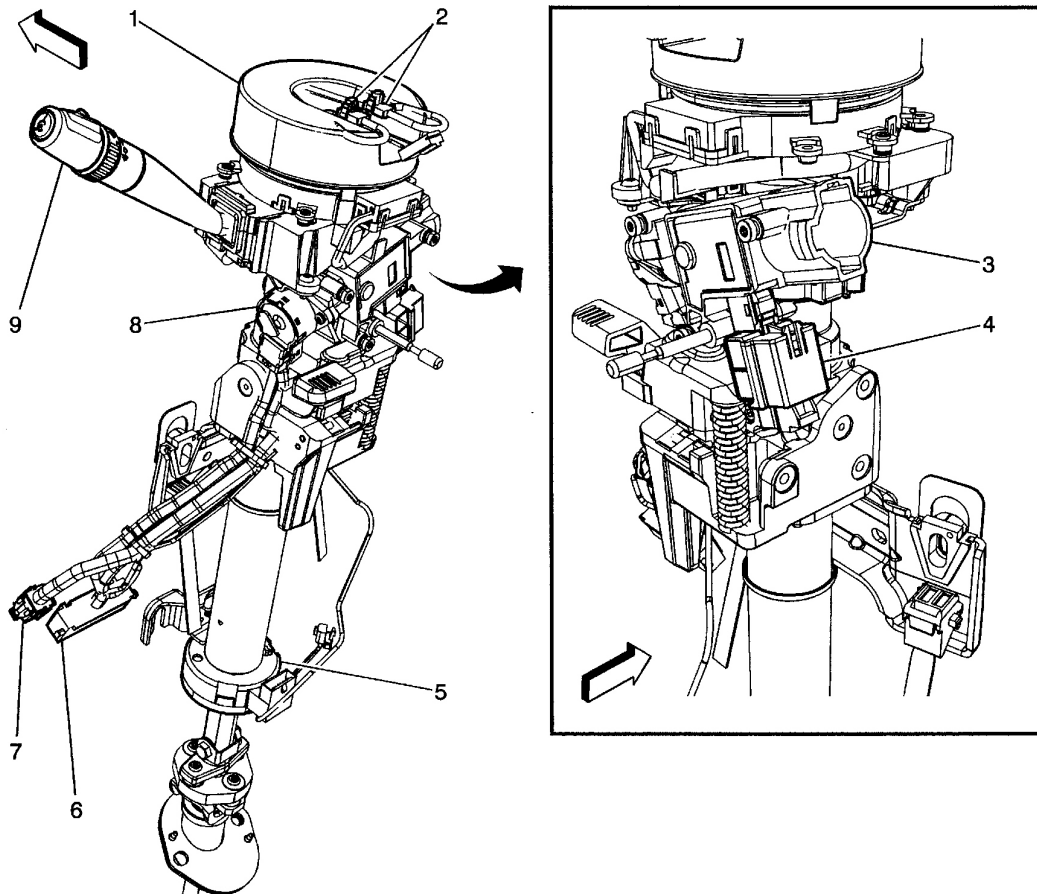

- (1) Inflatable Restraint Steering Wheel Module Coil
- (2) Inflatable Restraint Steering Wheel Module Connectors
- (3) Ignition Switch
- (4) Ignition Lock Cylinder Control Actuator (M30)
- (5) Steering Wheel Position Sensor (JL4)
- (6) C201 Steering Column Harness to I/P Harness
- (7) C275 Steering Column Harness to I/P Harness
- (8) Ignition Switch
- (9) Turn Signal/Multifunction Switch

G00419134

Fig. 33: Steering Column
Courtesy of GENERAL MOTORS CORP.

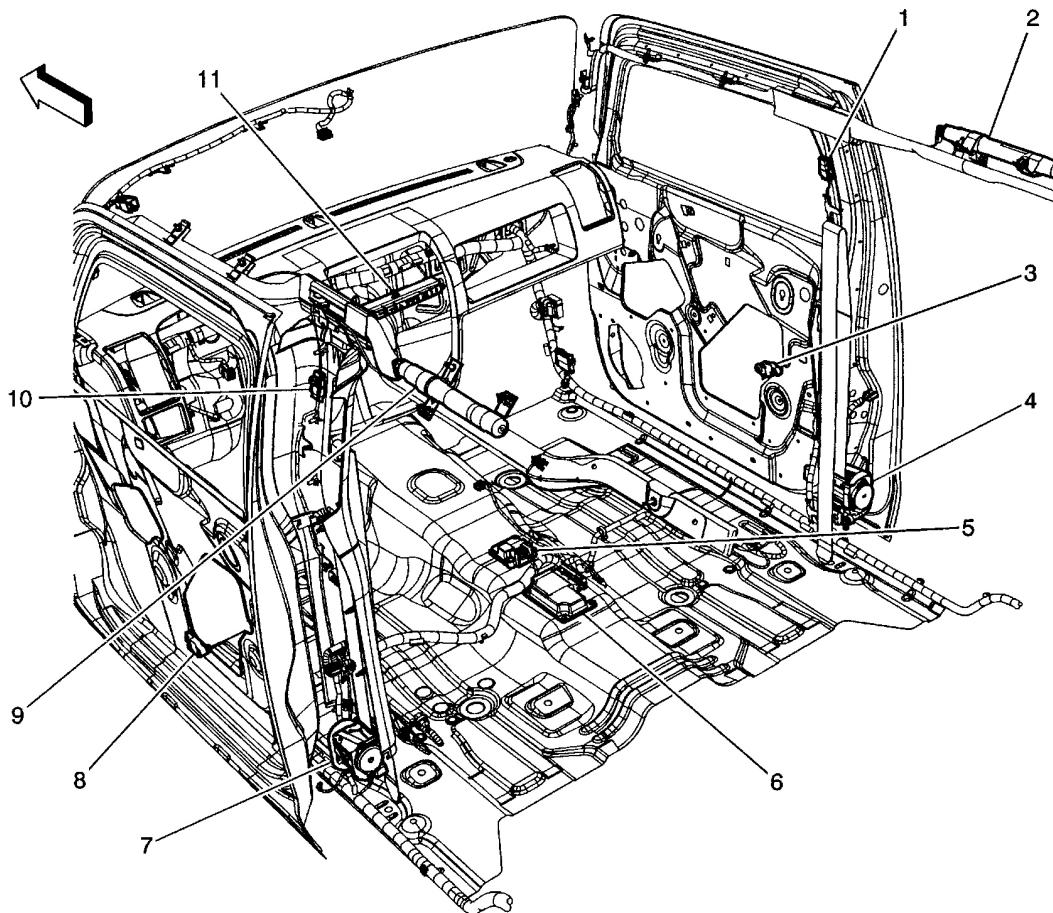

- (1) Inflatable Restraint Roof Rail Module - Right Connector (ASF)
- (2) Inflatable Restraint Roof Rail Module - Right (ASF)
- (3) Inflatable Restraint Side Impact Sensor (SIS) - Right (ASF)
- (4) Seat Belt Pretensioner - RF
- (5) Inflatable Restraint Vehicle Rollover Sensor (ASF)
- (6) Inflatable Restraint Sensing and Diagnostic Module (SDM)
- (7) Seat Belt Pretensioner - LF
- (8) Inflatable Restraint Side Impact Sensor (SIS) - Left (ASF)
- (9) Inflatable Restraint Roof Rail Module - Left (ASF)
- (10) Inflatable Restraint Roof Rail Module - Left Connector (ASF)
- (11) Inflatable Restraint Front Passenger Presence System (PPS) Indicator

G00419135

Fig. 34: Side Impact Sensor (SIR) Components
Courtesy of GENERAL MOTORS CORP.

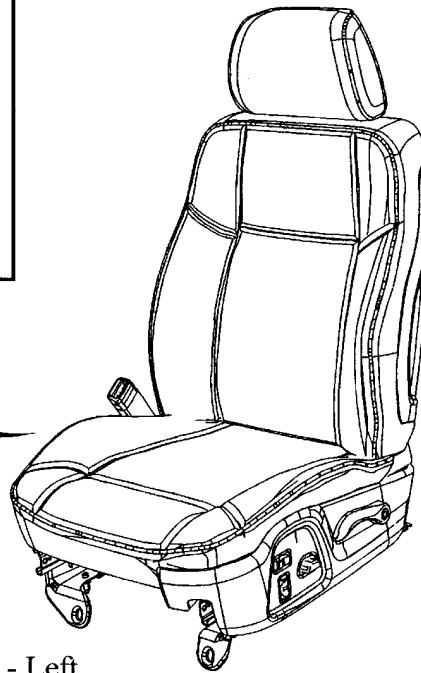
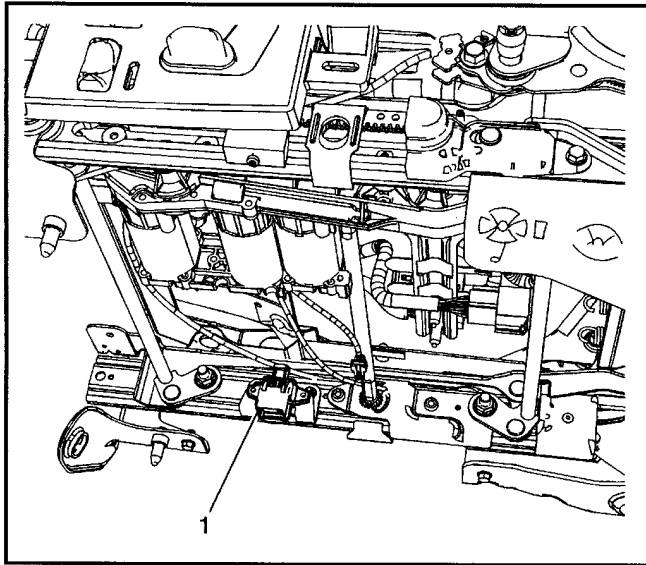

(1) Inflatable Restraint Seat Position Sensor (SPS) - Left

G00419136

Fig. 35: Driver's Seat
Courtesy of GENERAL MOTORS CORP.

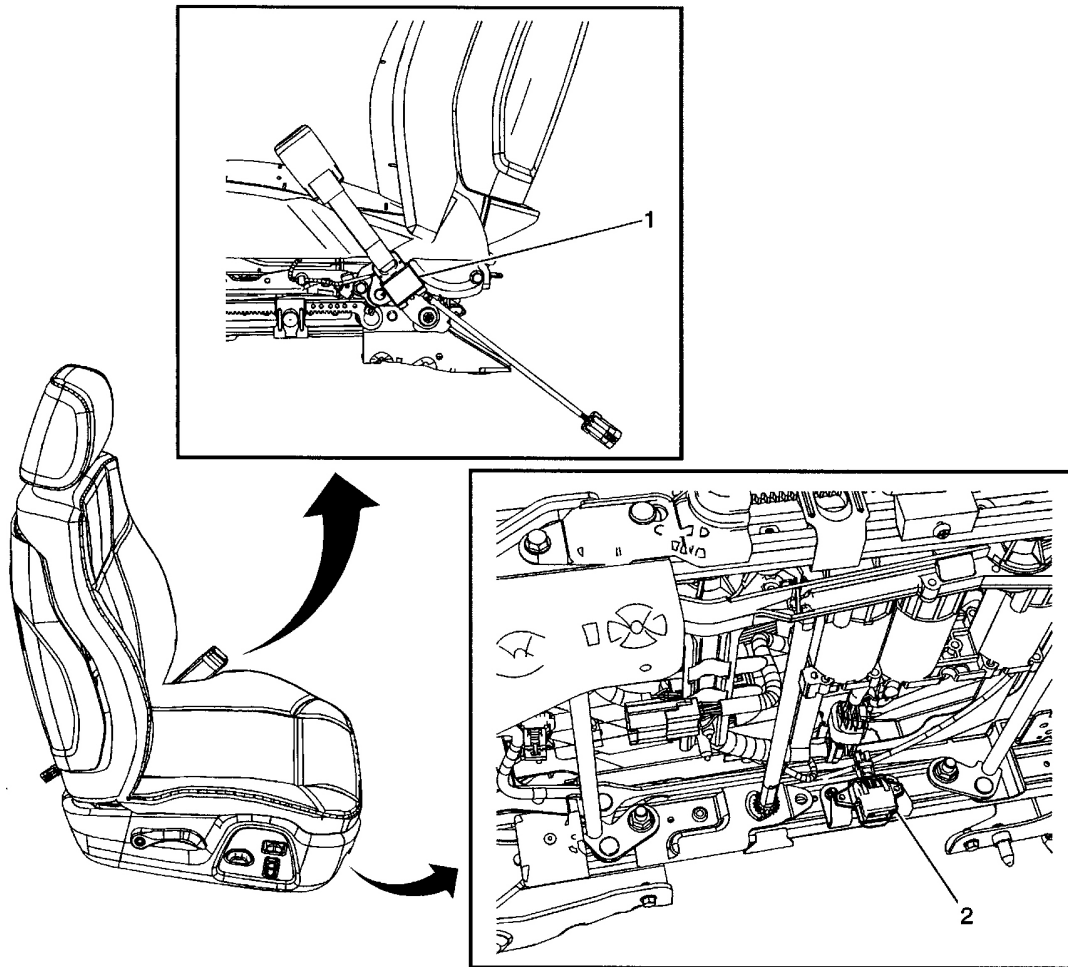

(1) Inflatable Restraint Passenger Seat Belt Tension Sensor

(2) Inflatable Restraint Seat Position Sensor (SPS) - Left

G00419137

Fig. 36: Passenger's Seat
Courtesy of GENERAL MOTORS CORP.

2006 Hummer H3

2006 GENERAL MOTORS H3

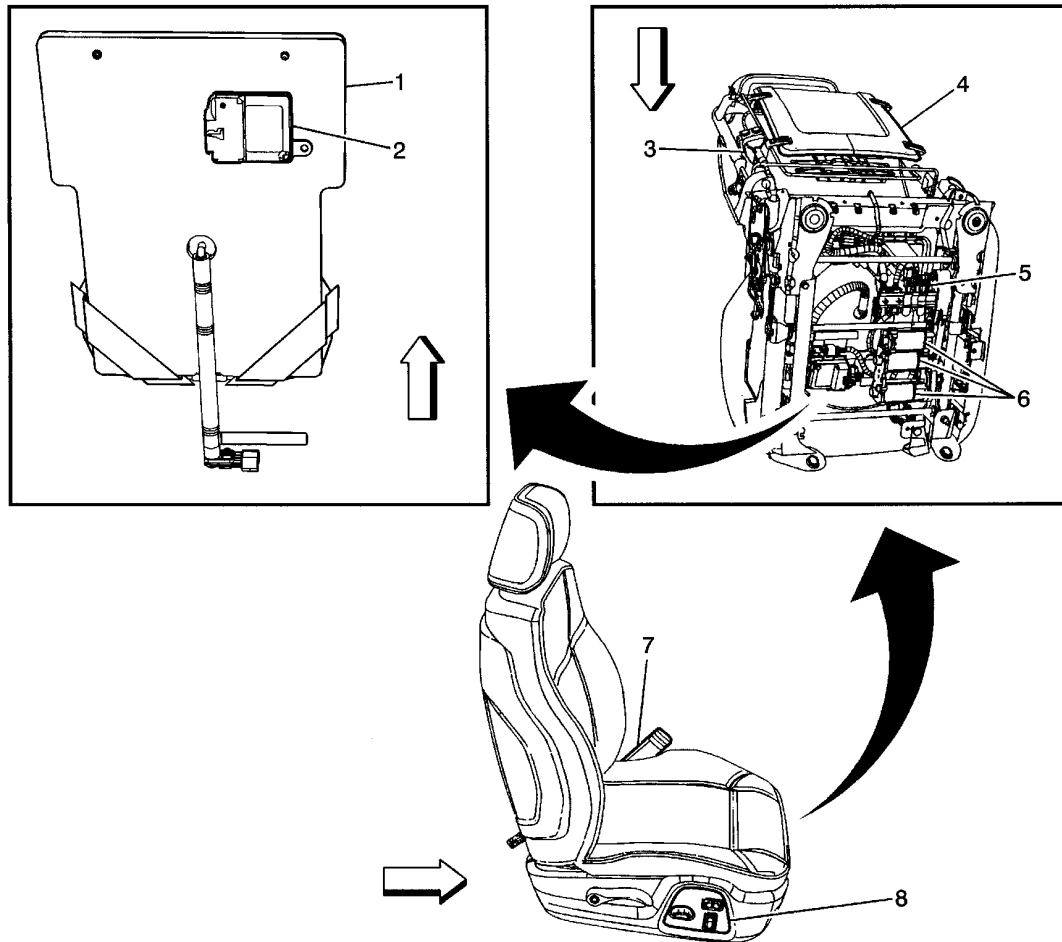

- (1) Heater Element Seat Cushion - Passenger (KA1)
- (2) Inflatable Restraint Passenger Presence Module
- (3) Lumbar Pump Motor - Passenger
- (4) Heater Element Seat Back - Passenger (KA1)
- (5) C315 Passenger Seat Harness to Body Harness
- (6) Seat Motors - Passenger
- (7) Seat Belt Buckle - Passenger
- (8) Seat Adjuster Switch - Passenger

G00419138

Fig. 37: Passenger Seat Assembly
Courtesy of GENERAL MOTORS CORP.

2006 Hummer H3

2006 GENERAL MOTORS H3

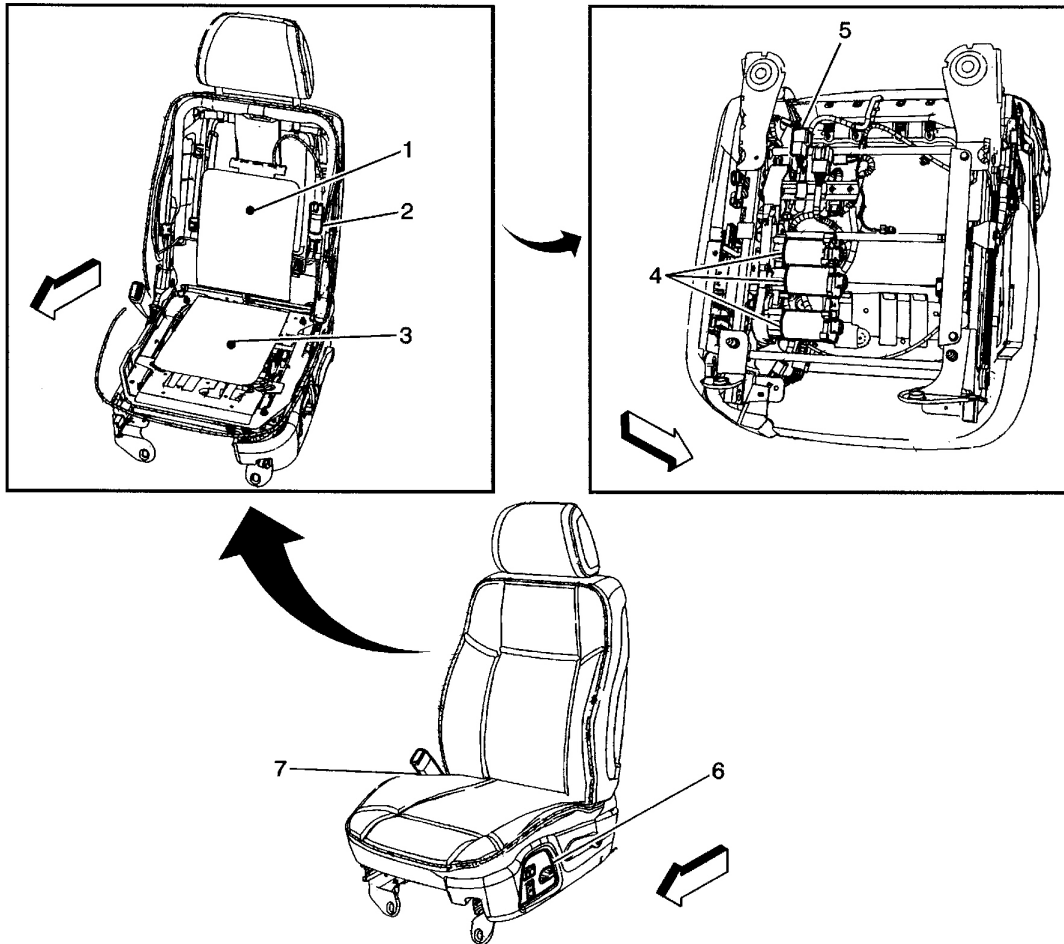

- (1) Heater Element Seat Back - Driver (KA1)
- (2) Bolster Motor
- (3) Heater Element Seat Cushion - Driver (KA1)
- (4) Seat Motors - Driver
- (5) C307 Driver Seat Harness to Body Harness
- (6) Seat Adjuster Switch - Driver
- (7) Seat Belt Buckle - Driver

G00419139

Fig. 38: Driver's Seat
Courtesy of GENERAL MOTORS CORP.

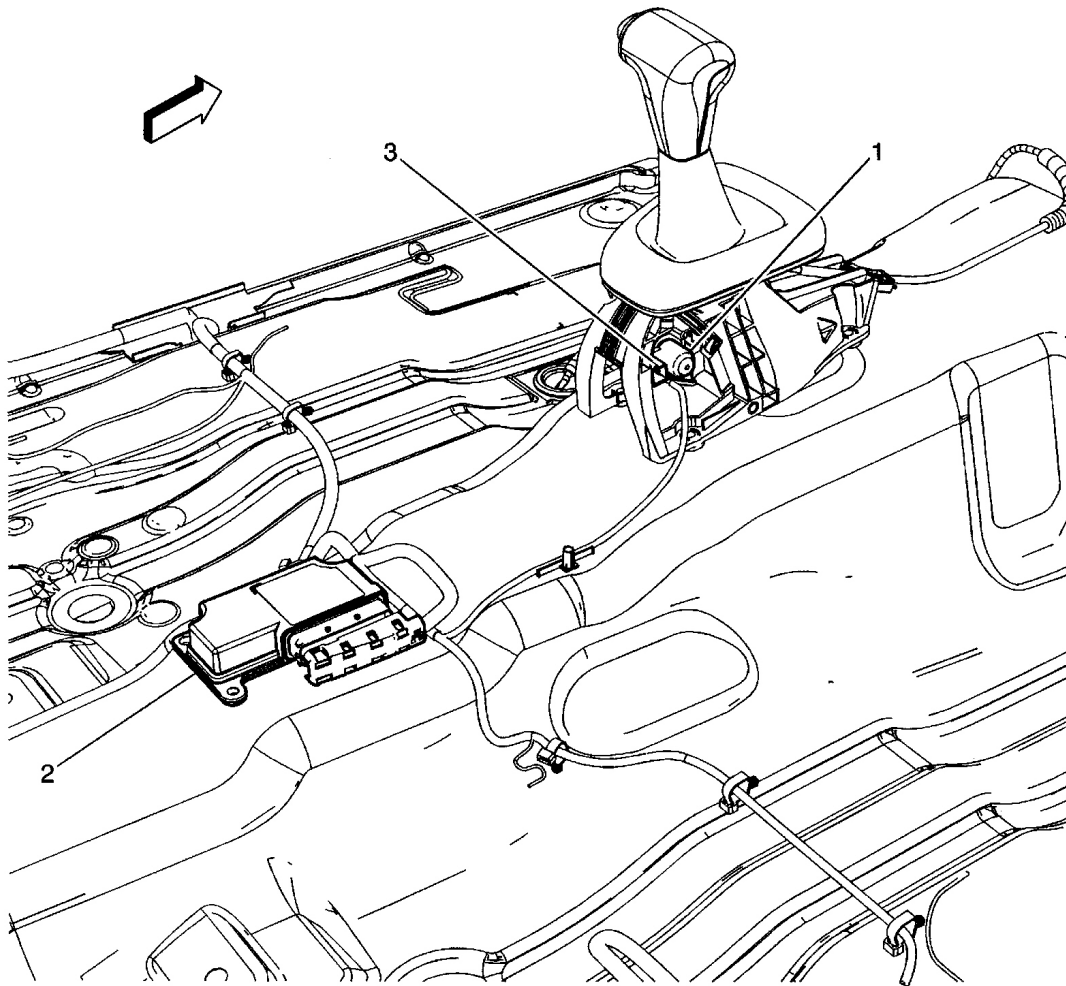

- (1) A/T Shift Lock Control Solenoid
- (2) Inflatable Restraint Sensing and Diagnostic Module (SDM)
- (3) Automatic Transmission Floor Shift Control

G00419140

Fig. 39: Floor Pan
Courtesy of GENERAL MOTORS CORP.

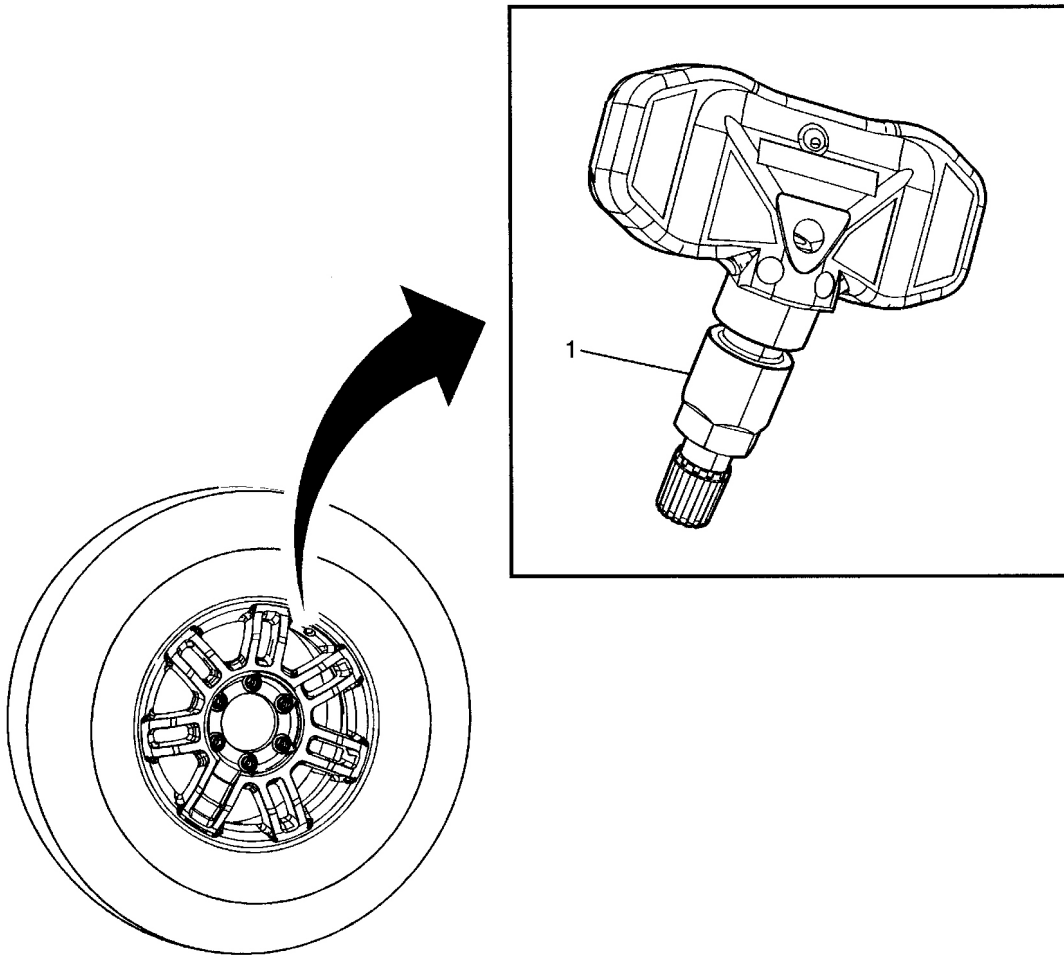

(1) Tire Pressure Monitor Sensor

G00419141

Fig. 40: Tire Assembly
Courtesy of GENERAL MOTORS CORP.

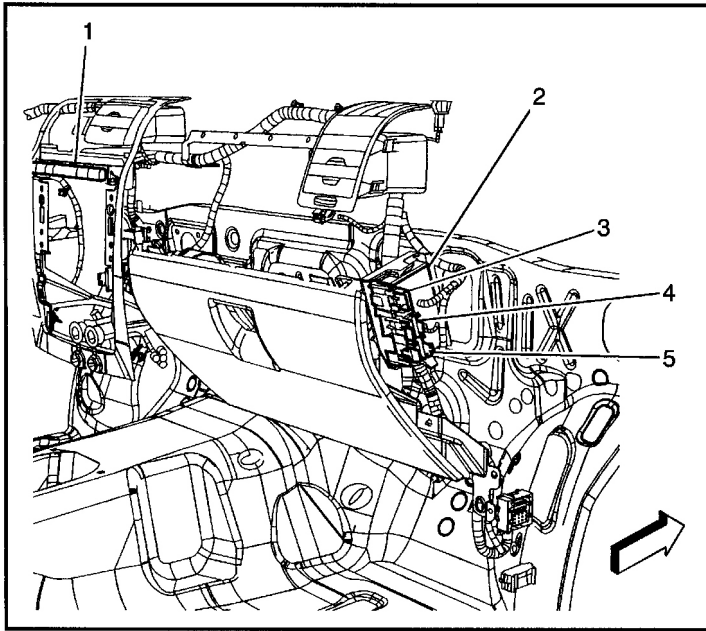

- (1) Accessory Switch
- (2) Transfer Case Shift Control Module
- (3) Transfer Case Shift Control Module C3
- (4) Transfer Case Shift Control Module C2
- (5) Transfer Case Shift Control Module C1

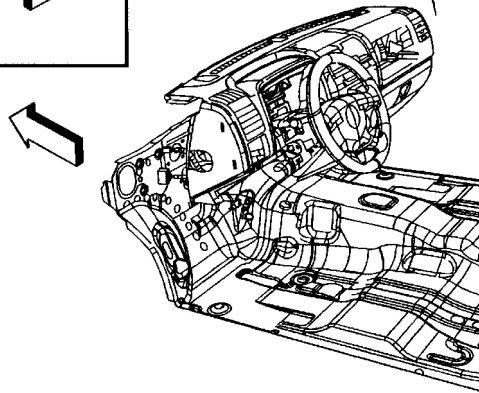

G00419142

Fig. 41: Right Side Of Dash
Courtesy of GENERAL MOTORS CORP.

2006 Hummer H3

2006 GENERAL MOTORS H3

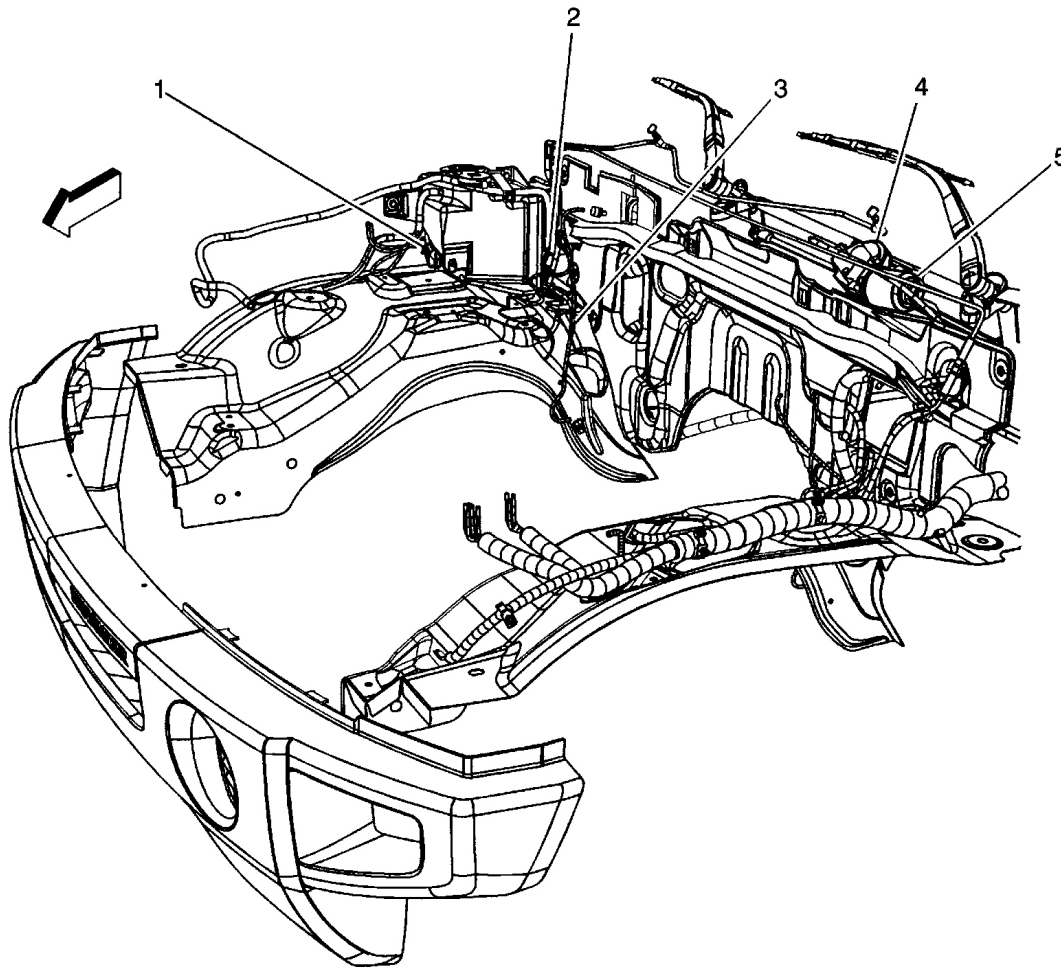

- (1) Rear Window Washer Fluid Pump
- (2) Windshield Washer Fluid Pump
- (3) Body Harness
- (4) Windshield Wiper/Washer Module
- (5) Windshield Wiper Motor

G00419143

Fig. 42: Engine Compartment
Courtesy of GENERAL MOTORS CORP.

2006 Hummer H3

2006 GENERAL MOTORS H3

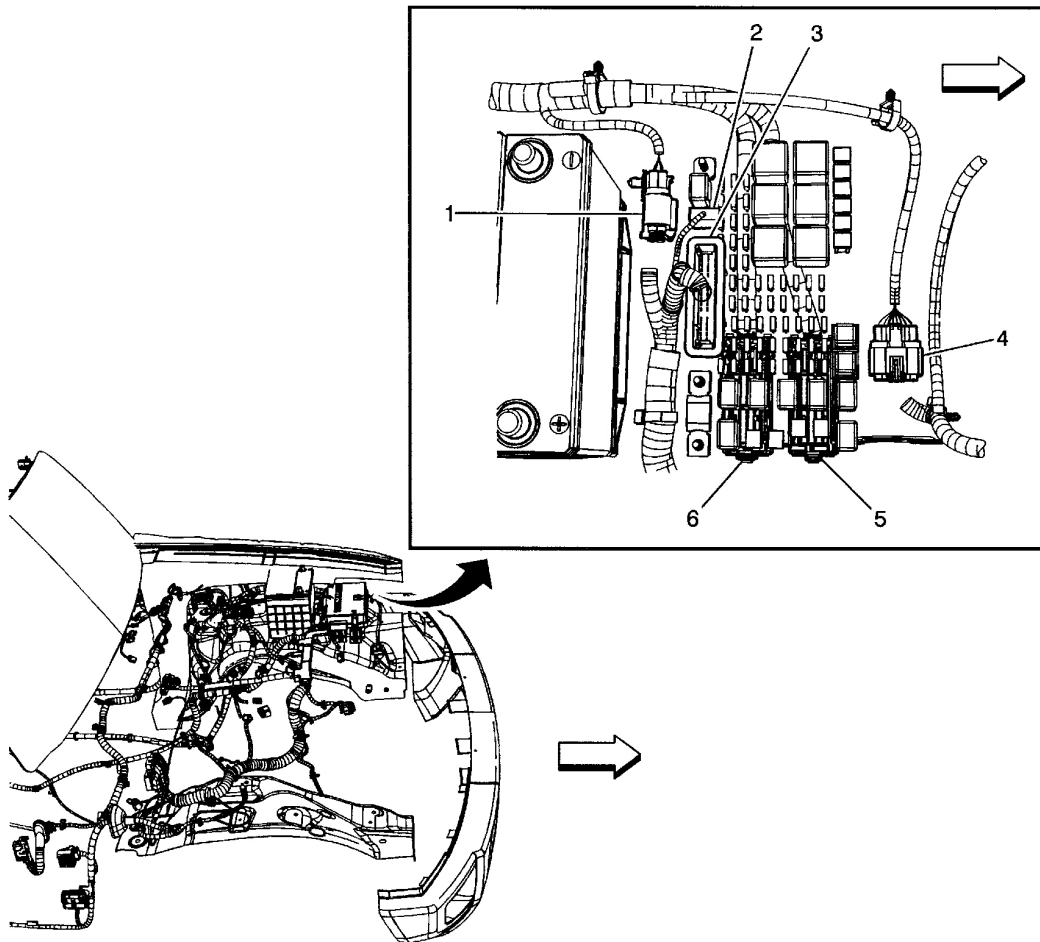

- (1) C125 Body Harness to Engine Harness (Transfer Case)
- (2) Fuse Block - Underhood C4 (Engine Harness)
- (3) Fuse Block - Underhood C3 (Engine Harness)
- (4) C115 Forward Lamp Harness to Body Harness
- (5) Fuse Block - Underhood C1 (Body Harness)
- (6) Fuse Block - Underhood C2 (Body Harness)

G00419144

Fig. 43: Front Engine Compartment
Courtesy of GENERAL MOTORS CORP.

2006 Hummer H3

2006 GENERAL MOTORS H3

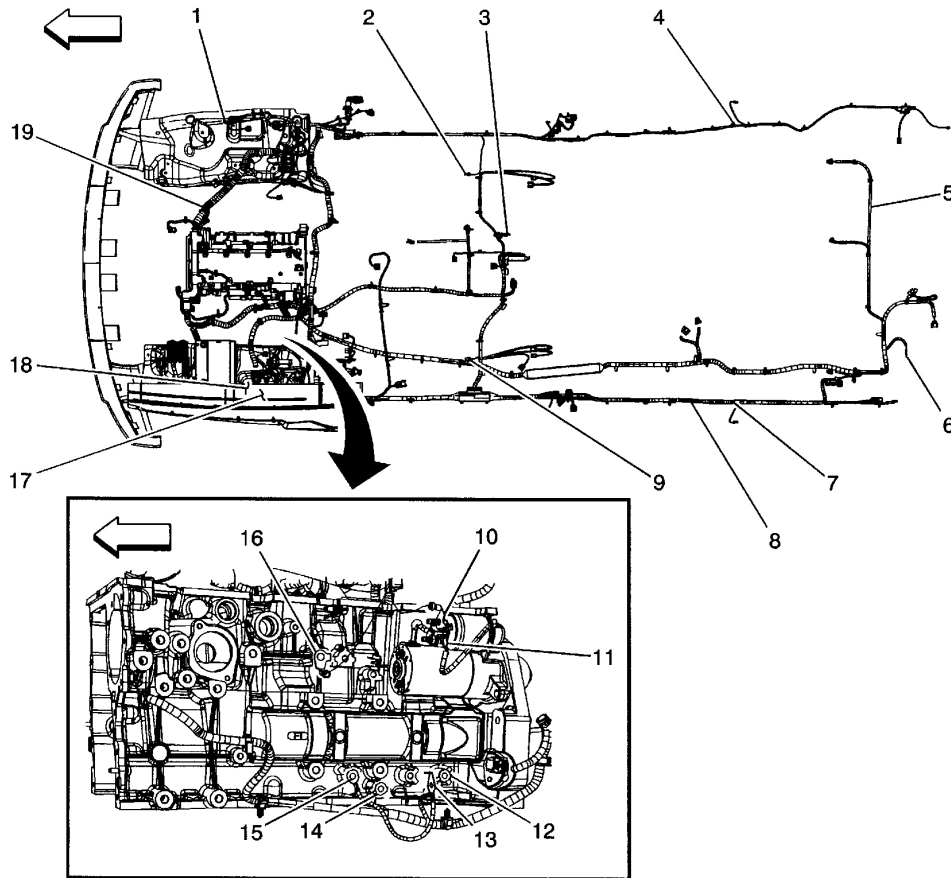

- | | |
|----------------------|--|
| (1) G106 | (9) G300 |
| (2) G320 | (10) Battery Positive Voltage (Starter Solenoid) |
| (3) G310 | (11) Starter Crank Voltage |
| (4) G340 | (12) G102 |
| (5) Chassis Harness | (13) G120 (Ground Strap-Chassis) |
| (6) G420 | (14) G103 |
| (7) G345 and or G350 | (15) G110 (Ground Strap-Engine Block) |
| (8) Body Harness | (16) G104 (Negative Battery Cable) |
| | (17) G105 |
| | (18) G100 (Battery Ground) |
| | (19) Engine Harness |

G00419145

Fig. 44: Vehicle Overview
Courtesy of GENERAL MOTORS CORP.

2006 Hummer H3

2006 GENERAL MOTORS H3

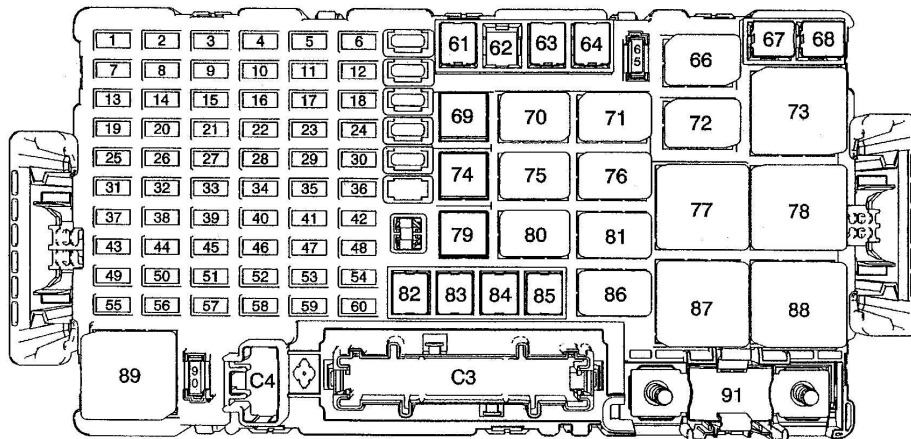

1. HTD/SEATS	20A	26. SPARE - 4	10A	44. AIR SOL	15A	61. PWR SEATS	40A	78. SPARE - 1	RLY
2. GRILLE GUARD	20A	27. AIRBAG	10A	45. AUX PWR 2	20A	62. AIR PUMP	20A	80. AIR SOL	RLY
3. FUEL/PUMP	15A	28. BCKUP	15A	46. ETC	15A	63. RT PWR WNDW	30A	81. PWR/TRN	RLY
4. ROOF LP	20A	29. ABS/VSES	10A	47. O2 SNBR	15A	64. ABS/VSES2 - MTR	30A	82. HVAC BLWR	30A
5. BATTIGN SWITCH	10A	30. RWDO DEFG	20A	48. A/C CLUTCH	10A	65. WPR	DIODE	83. E - BRAKE	30A
6. FRT/WPR	25A	31. CNSTR VENT	10A	49. RR PRK	10A	66. FUEL/PUMP	RLY	84. TRLR B+	30A
7. SPARE - 1	15A	32. SPARE - 5	10A	50. SCARs	10A	67. ABS/VSES1 - SOL	40A	85. STRTR	30A
8. PWR/LKS	20A	33. IGN1	15A	51. AUX PWR 1	20A	68. LT PWR WNDW	30A	86. SPARE - 2	RLY
9. SHOOF FRT/		34. TRANS	10A	52. VSES/ABS	10A	69. FOG/LP	RLY	87. HVAC	RLY
WPR PUMP	15A	35. CRUISE/MISC	10A	53. PWR HTR SWITCH	10A	70. HI/LO BEAM	RLY	88. RAP/ACDY	RLY
10. SPO	10A	36. HORN	10A	54. STOP	15A	71. RR DEFOG	RLY	89. PRK/LP	RLY
11. AIR CMPSR	25A	37. LR PRK	10A	55. TRLR	10A	72. ON/OFF WPR	RLY	90. A/C CLUTCH	DIODE
12. TCCM	30A	38. AMP	25A	56. FRT TRNHAZRD		73. HI/LOW WPR	RLY	91. MEGAFUSE	125A
13. RDO	10A	39. SPARE - 7	10A	/CTSY MIR	15A	74. HORN	RLY		
14. BCM	10A	40. RH HDLP	10A	57. PWR S/ROOF	30A	75. HDLP	RLY		
15. REAR WPR/MTR	15A	41. LH HDLP	10A	58. TCCM SWITCH	10A	76. A/C CLUTCH	RLY		
16. REAR WPR		42. TRLR BCKUP	10A	59. HVAC CNTRL HD	10A	77. PCM CNTRL	RLY		
SWTCH/PUMP	15A	43. FRT/PRK	10A	60. SPARE - B	10A	78. RUN/CRNK	RLY		
17. SPARE - 2	10A								
18. SPARE - 6	10A								
19. CLSTR	10A								
20. REAR TRNHAZRD	20A								
21. PCM - 1	10A								
22. ENG CNTRL SYS	15A								
23. INJ	15A								
24. FOG/LP	15A								
25. PCM - B	10A								

G00419146

Fig. 45: Underhood Fuse Block
Courtesy of GENERAL MOTORS CORP.

2006 Hummer H3

2006 GENERAL MOTORS H3

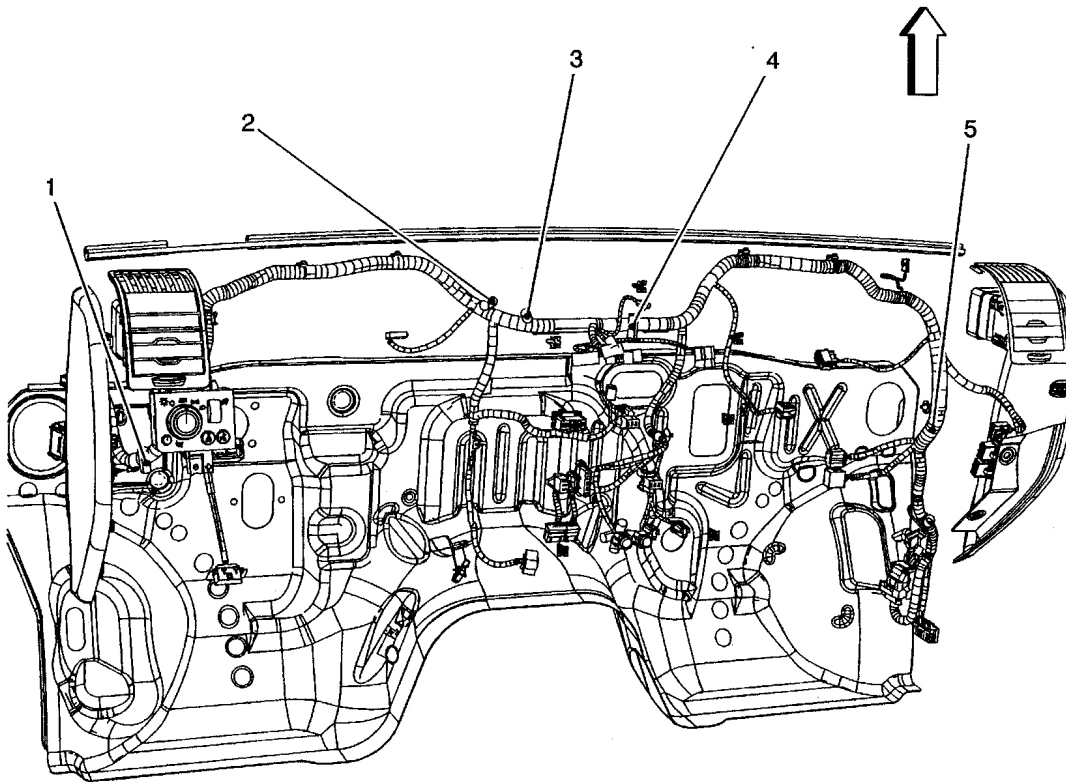

- (1) S214
- (2) S251
- (3) S205
- (4) S234 (UE1 and U2K)
- (5) S206

G00419147

Fig. 46: Dash Harness
Courtesy of GENERAL MOTORS CORP.

2006 Hummer H3

2006 GENERAL MOTORS H3

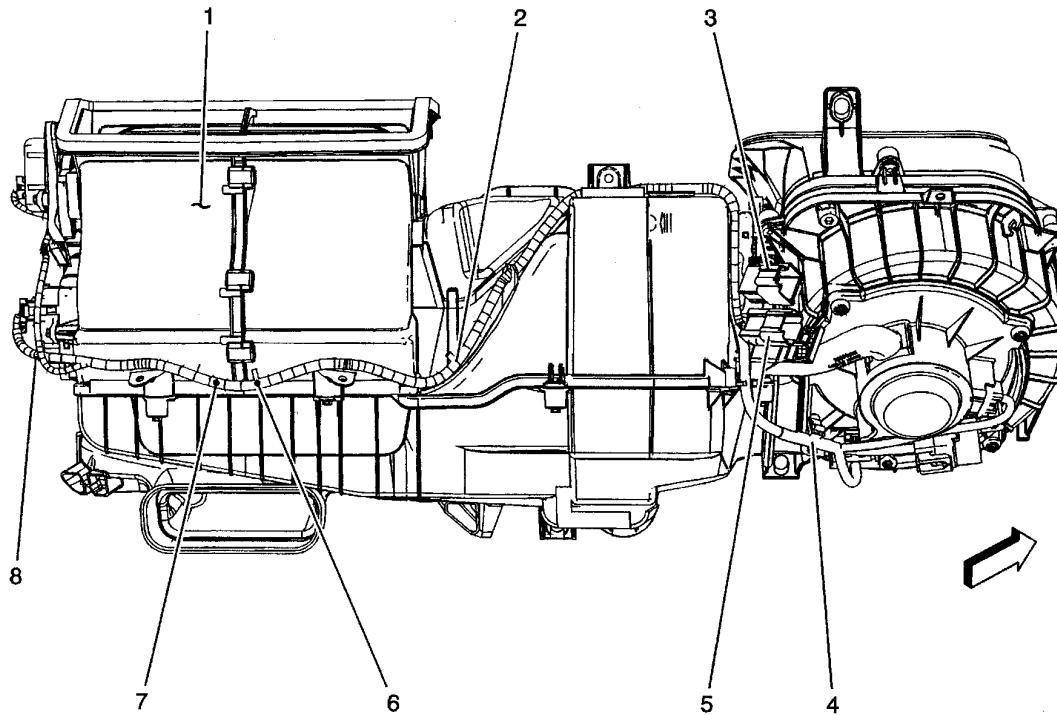

- (1) HVAC Box
- (2) S250
- (3) C203 Blower Motor Resistor Harness to I/P Harness
- (4) S220
- (5) C205 HVAC Harness to I/P Harness
- (6) S240
- (7) S260
- (8) S230

G00419148

Fig. 47: HVAC Module Harness
Courtesy of GENERAL MOTORS CORP.

2006 Hummer H3

2006 GENERAL MOTORS H3

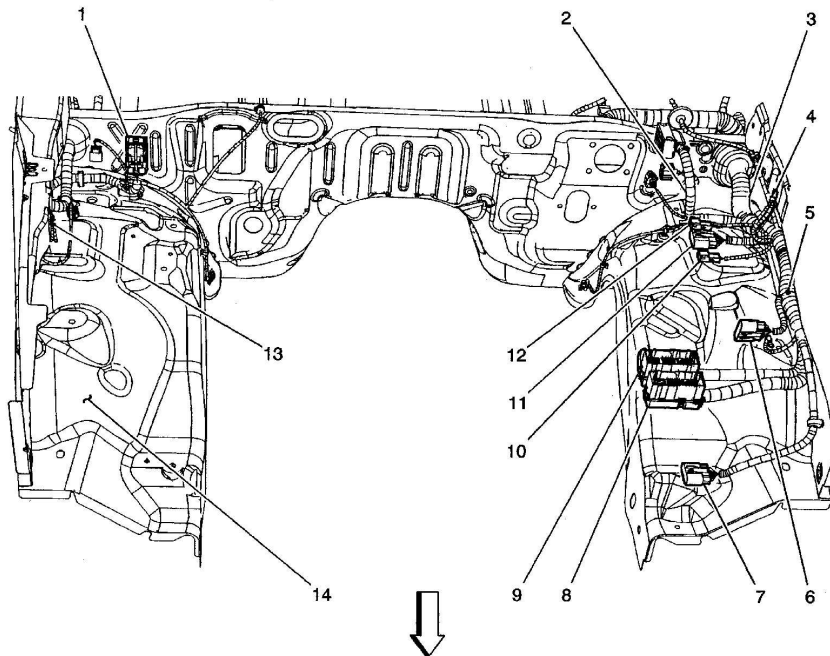

- | | |
|---|---|
| (1) Powertrain Control Module (PCM) C1 | (9) Fuse Block - Underhood C1 |
| (2) S110 | (10) C130 Body Harness to Battery Cable Harness (UE1) |
| (3) S141 | (11) C150 Body Harness to Chassis Harness |
| (4) G105 | (12) C155 Body Harness to Chassis Harness |
| (5) S143 | (13) Wheel Well-RF |
| (6) C125 Body Harness to Engine Harness | (14) G106 |
| (7) C115 Body Harness to Forward Lamp Harness | |
| (8) Fuse Block - Underhood C2 | |

G00419149

Fig. 48: Body Harness (Front)
Courtesy of GENERAL MOTORS CORP.

2006 Hummer H3

2006 GENERAL MOTORS H3

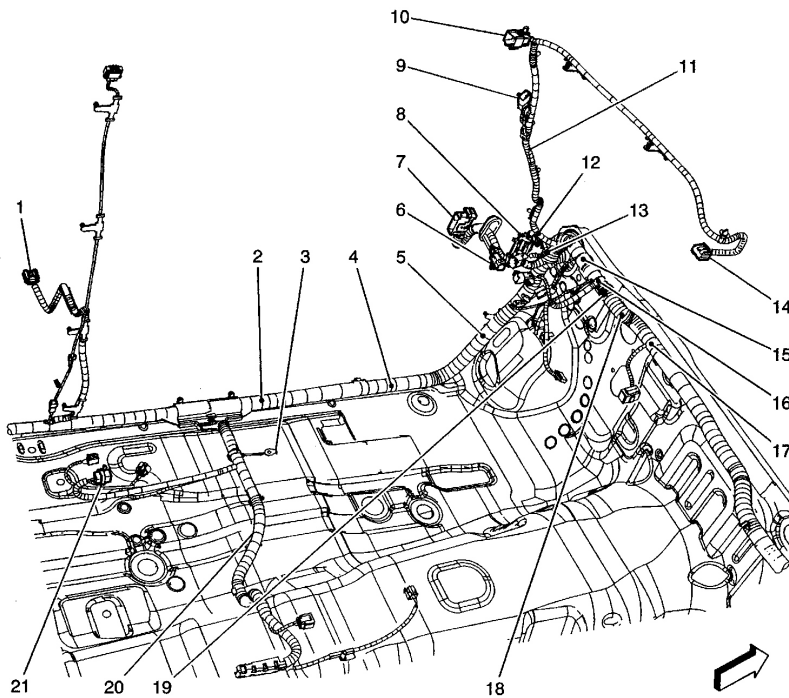

- (9) C335 Body Harness to Sunroof Switch Jumper Harness
- (10) C330 Body Harness to Sunroof Motor Harness (CF5)
- (11) S210
- (12) S224
- (13) S264
- (14) Inside Rearview Mirror Connector
- (15) S294
- (16) S295
- (17) S215
- (18) S213
- (19) S209
- (20) S344
- (21) C307 Body Harness to Driver Seat Harness (YC3)

G00419150

Fig. 49: Driver's Floor Pan
Courtesy of GENERAL MOTORS CORP.

2006 Hummer H3

2006 GENERAL MOTORS H3

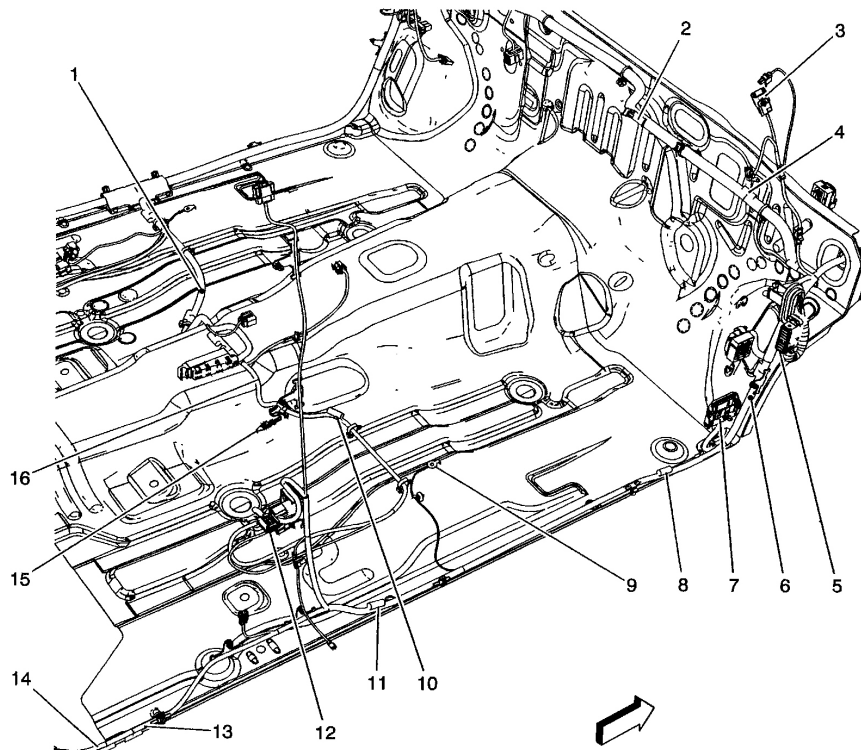

- | | |
|--|---|
| (1) S344 | (9) G320 |
| (2) S244 | (10) S323 |
| (3) C350 Body Harness to Dome Lamp Harness | (11) S320 |
| (4) S247 | (12) C380 Body Harness to Right Rear Door Harness |
| (5) C600 Body Harness to Driver Door Harness | (13) S347 |
| (6) S292 | (14) S315 |
| (7) C204 Body Harness to I/P Harness | (15) G310 |
| (8) S305 | (16) S310 |

G00419151

Fig. 50: Front Passenger's Floor Pan
Courtesy of GENERAL MOTORS CORP.

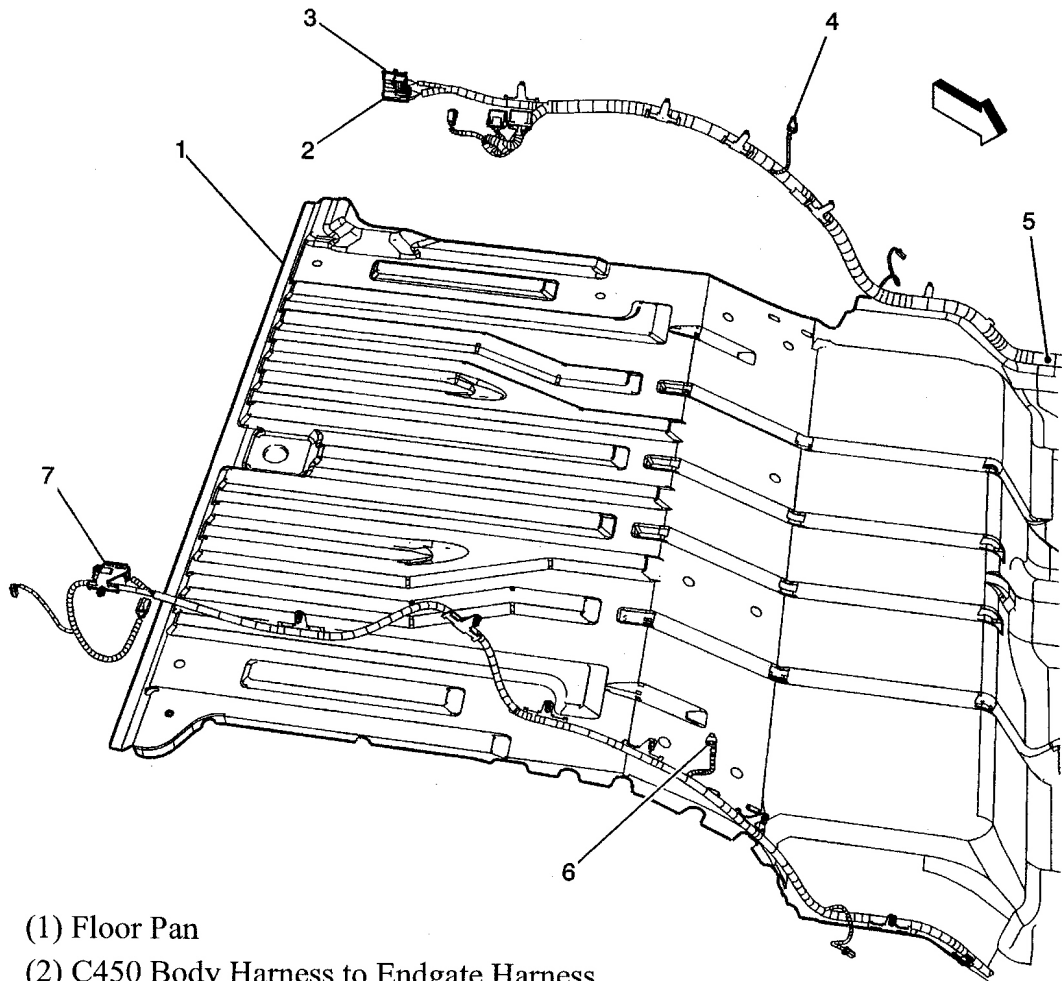

- (1) Floor Pan
- (2) C450 Body Harness to Endgate Harness
- (3) C430 Body Harness to Left Tail Lamp Harness
- (4) G345 and G350
- (5) S314
- (6) G340
- (7) C410 Body Harness to Right Tail Lamp Harness

G00419152

Fig. 51: Rear Floor Pan
Courtesy of GENERAL MOTORS CORP.

2006 Hummer H3

2006 GENERAL MOTORS H3

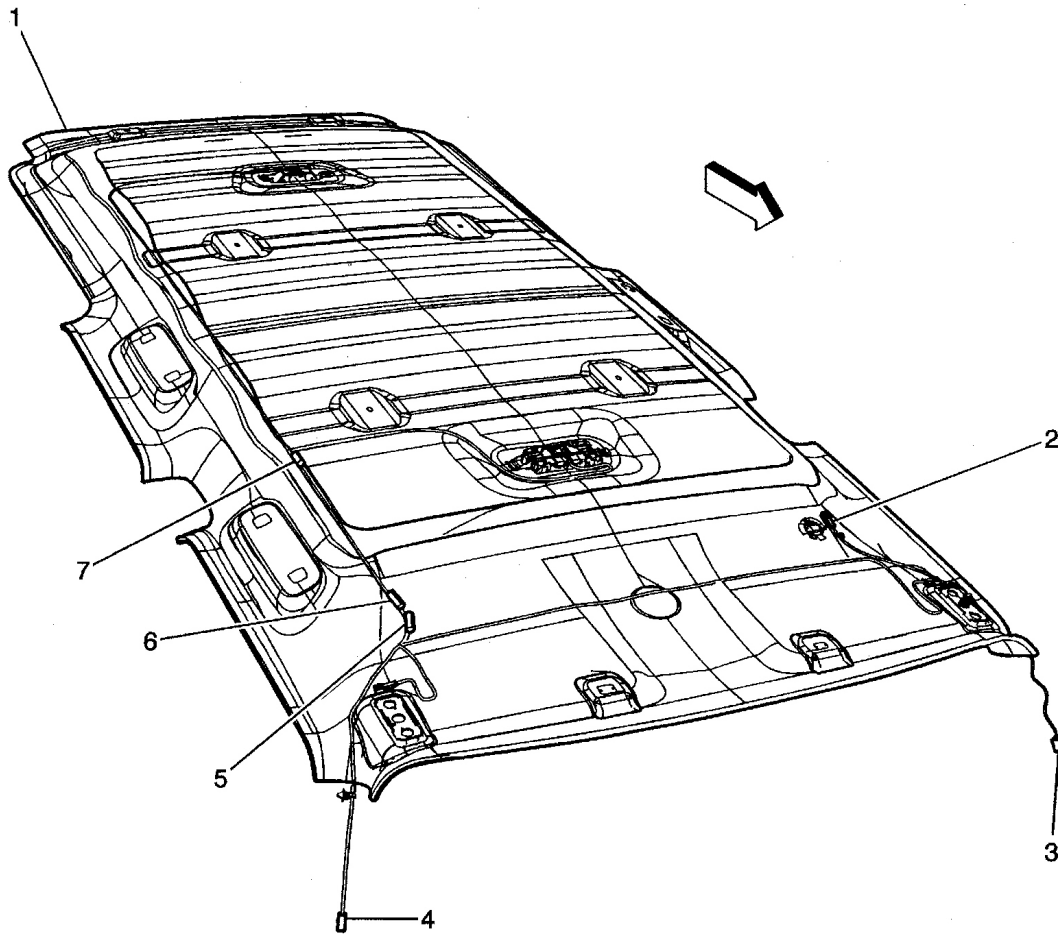

- (1) Headliner (w/o CF5)
- (2) Cellular Microphone
- (3) C335 Onstar Jumper Harness to Body Harness
- (4) C350 Dome Lamp Jumper Harness to Body Harness
- (5) S330
- (6) S340 (YC3)
- (7) S350

G00421633

Fig. 52: Headliner
Courtesy of GENERAL MOTORS CORP.

2006 Hummer H3

2006 GENERAL MOTORS H3

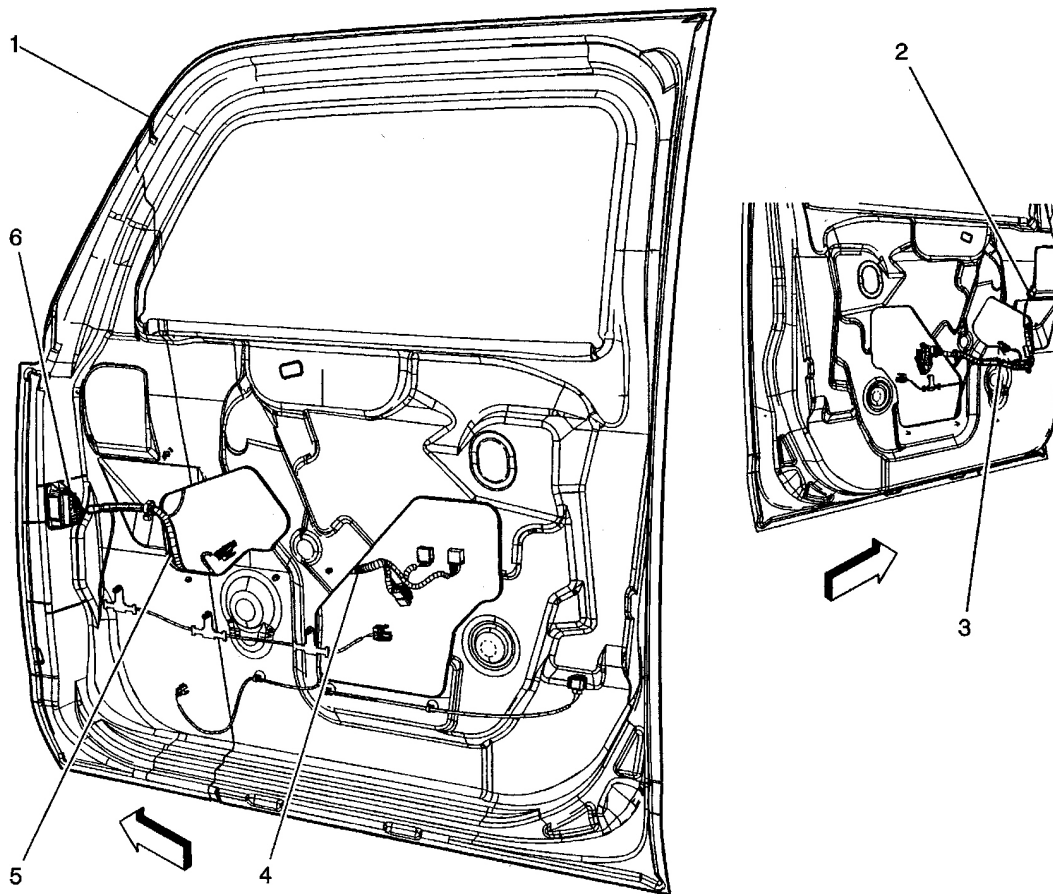

- (1) Door Frame
- (2) C510 LF Door Harness to Rearview Mirror Harness
- (3) S529
- (4) S514
- (5) S590
- (6) C500 Driver Door Harness to Body Harness

G00421634

Fig. 53: Driver Door
Courtesy of GENERAL MOTORS CORP.

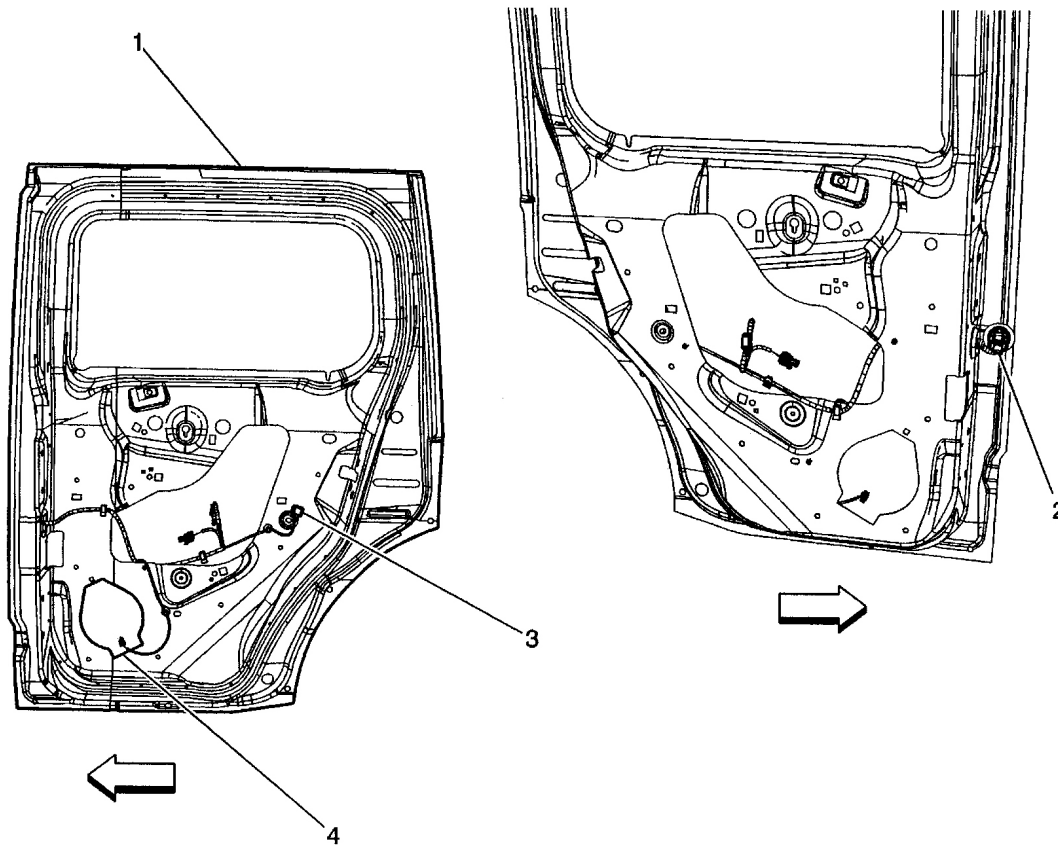

- (1) Door Frame
- (2) C370 Left Rear Door Harness to Body Harness
- (3) Door Lock Actuator Connector
- (4) Speaker - LR Door

G00421635

Fig. 54: Left Rear Door
Courtesy of GENERAL MOTORS CORP.

2006 Hummer H3

2006 GENERAL MOTORS H3

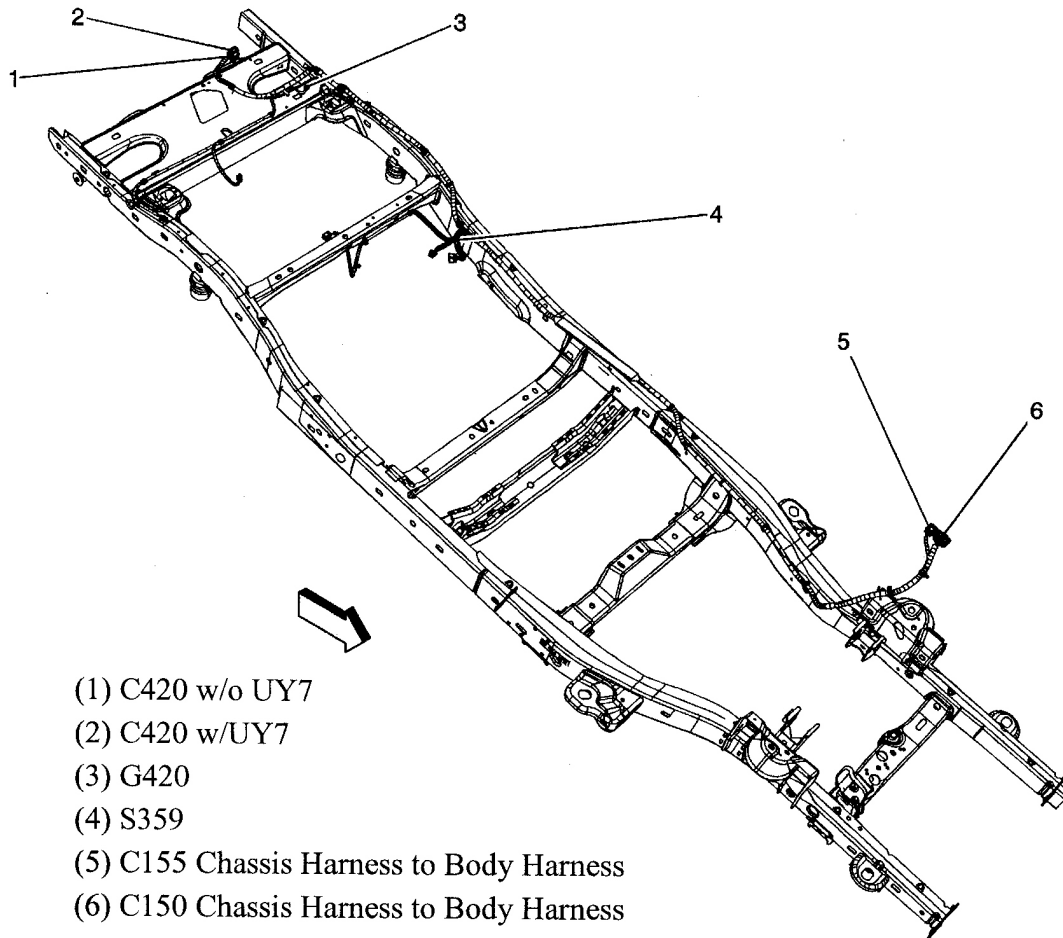

G00421637

Fig. 55: Chassis
Courtesy of GENERAL MOTORS CORP.

2006 Hummer H3

2006 GENERAL MOTORS H3

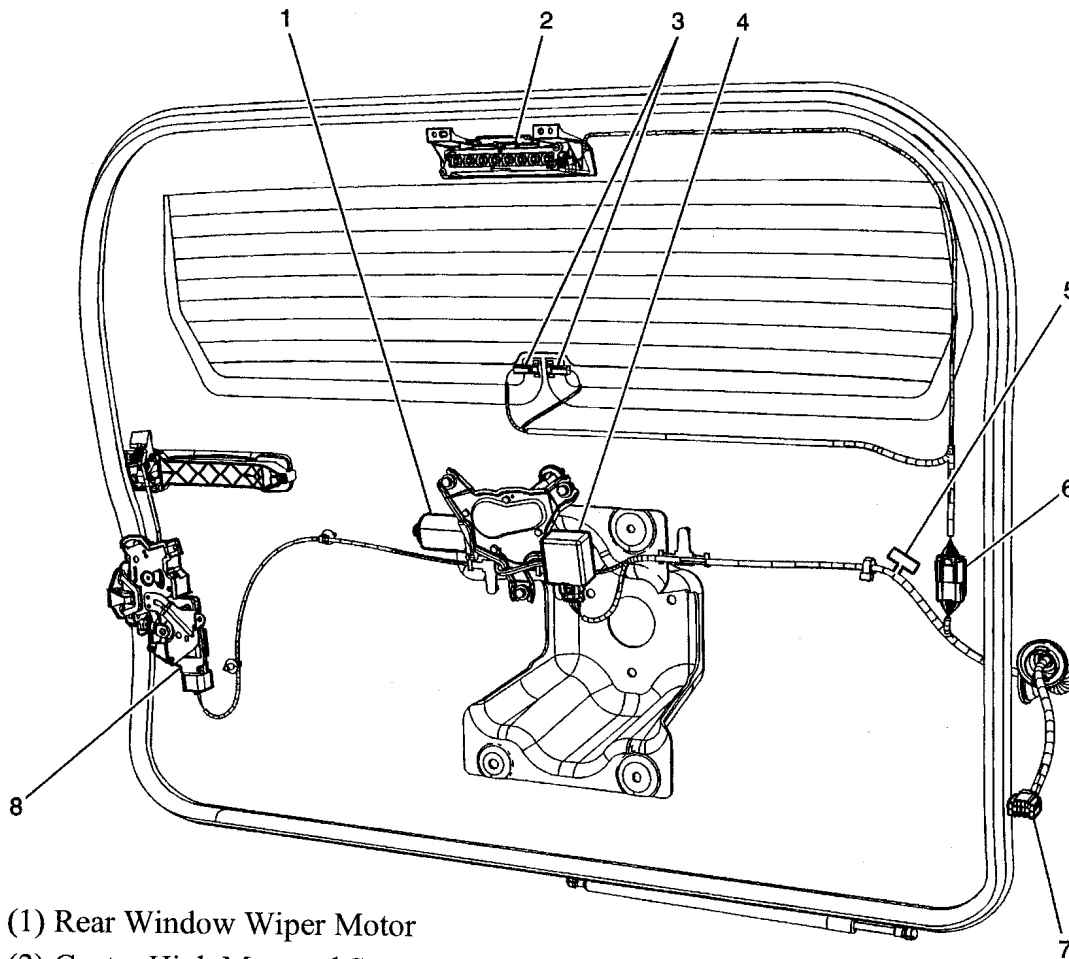

- (1) Rear Window Wiper Motor
- (2) Center High Mounted Stop Lamp (CHMSL)
- (3) Rear Window Defogger Grid Connectors
- (4) Rear Window Wiper Motor
- (5) S900
- (6) C901 Endgate Harness to CHMSL Jumper Harness
- (7) C450 Endgate Harness to Body Harness
- (8) Swing Gate Lock Actuator-Right

G00421638

Fig. 56: Endgate
Courtesy of GENERAL MOTORS CORP.